



Rochford Close, Turnford, EN10 6DL

**** AN IMMACULATELY PRESENTED TWO BEDROOM HOUSE WITH SOUTH FACING REAR GARDEN **** Situated in this quiet street in TURNFORD a Terraced house benefitting from gas central heating via NEWLY INSTALLED BOILER, lounge/ diner, ATTRACTIVE KITCHEN with APPLIANCES, double glazed windows, REFITTED SHOWER ROOM, delightful GARDEN with outside power points and PARKING SPACE DIRECTLY TO THE REAR.

Key features

- Two Bedrooms
- Gas Radiator Heating
- Kitchen
- South Facing Rear Garden
- Terrace House
- Lounge
- Shower Room
- Parking Space to Rear

Property Information

Tenure

Freehold

Council Tax

C

EPC Rating

C

Local Authority

Broxbourne Borough Council



 paulwallace



 paulwallace



Paul Wallace Estate Agents
Brookfield Centre
Cheshunt
Hertfordshire
EN8 0NN



01992 781100



cheshunt@paulwallace.co.uk



www.paulwallace.co.uk



Opening Times

Mon - Fri	9 am to 6:30 pm
Sat	9 am to 5:30 pm
Sun	Closed
Bank Hols	Closed

 paulwallace
estate agents

Cheshunts leading estate agent.
Please get in touch for your free
property valuation.





paulwallace



GROUND FLOOR
307 sq.ft. (28.5 sq.m.) approx.

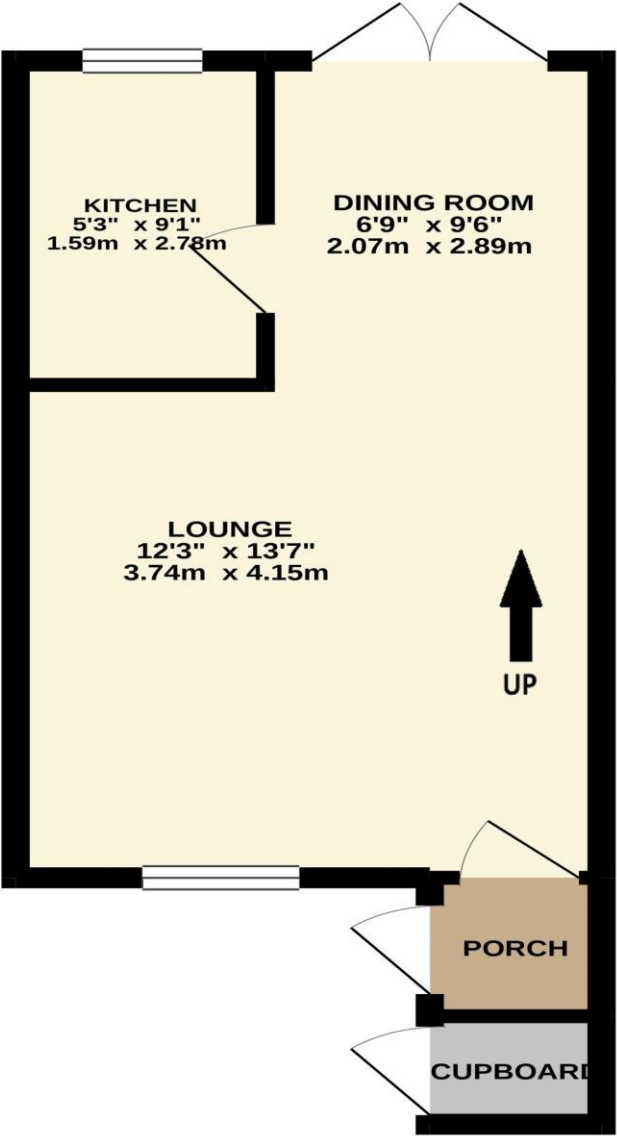

1ST FLOOR
282 sq.ft. (26.2 sq.m.) approx.

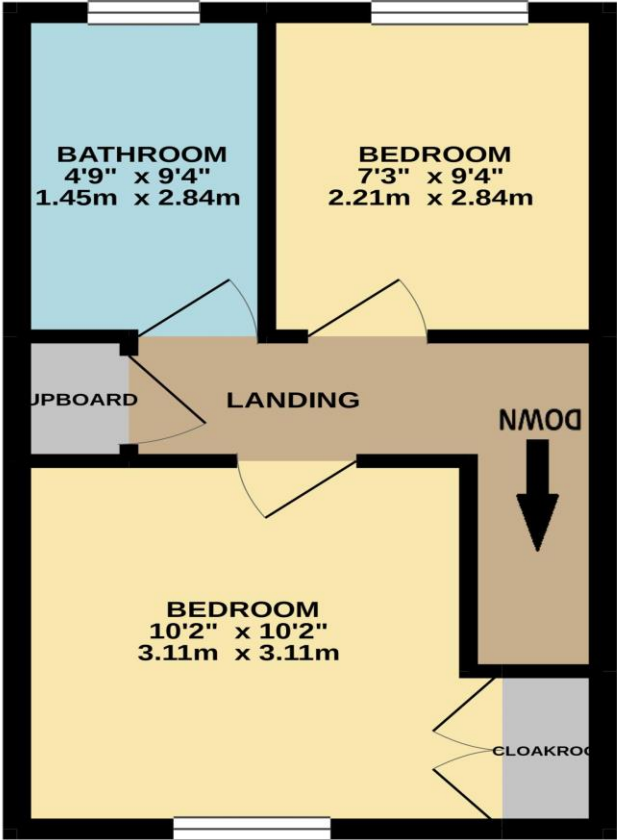

TOTAL FLOOR AREA : 589 sq.ft. (54.8 sq.m.) approx.

Whilst every attempt has been made to ensure the accuracy of the floorplan contained here, measurements of doors, windows, rooms and any other items are approximate and no responsibility is taken for any error, omission or mis-statement. This plan is for illustrative purposes only and should be used as such by any prospective purchaser. The services, systems and appliances shown have not been tested and no guarantee as to their operability or efficiency can be given.
Made with Metropix ©2021

