



 paulwallace

Galloway Close, Turnford, EN10 6BU |
£419,995 | Freehold

Galloway Close, Turnford, EN10 6BU

This THREE BEDROOM end of terrace freehold property is situated in the heart of SOUGHT AFTER TURNFORD. Benefitting from a REFITTED KITCHEN, a family bathroom, garage, fitted wardrobes in master bedroom, double glazed windows and gas central heating throughout. Ideal for both the A10 and M25 and local public transport links.

Key features

- Three Bedrooms
- End Of Terrace
- Refitted Kitchen
- Family Bathroom
- Garage
- Well Presented
- Double Glazed Windows
- Gas Central Heating

Property Information

Tenure
Freehold

Council Tax
D

EPC Rating
D



Paul Wallace Estate Agents
Brookfield Centre
Cheshunt
Hertfordshire
EN8 0NN



01992 781100



cheshunt@paulwallace.co.uk



www.paulwallace.co.uk



Opening Times

Mon - Fri	9 am to 6:30 pm
Sat	9 am to 5:30 pm
Sun	Closed
Bank Hols	Closed

paulwallace
estate agents

Cheshunts leading estate agent.
Please get in touch for your free
property valuation.







GROUND FLOOR
413 sq.ft. (38.4 sq.m.) approx.

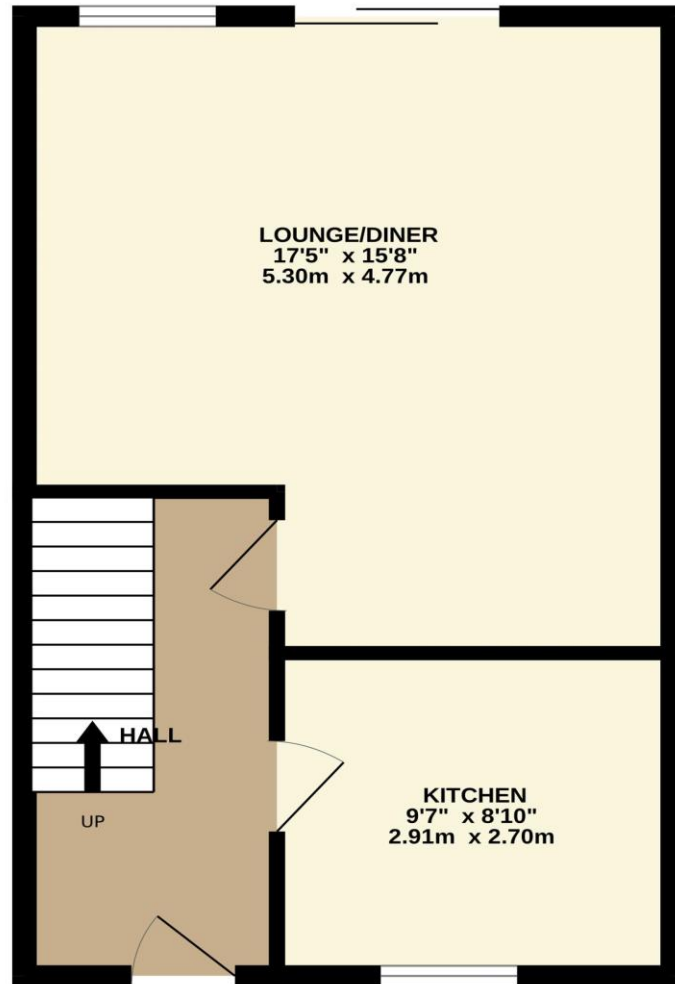

1ST FLOOR
413 sq.ft. (38.4 sq.m.) approx.

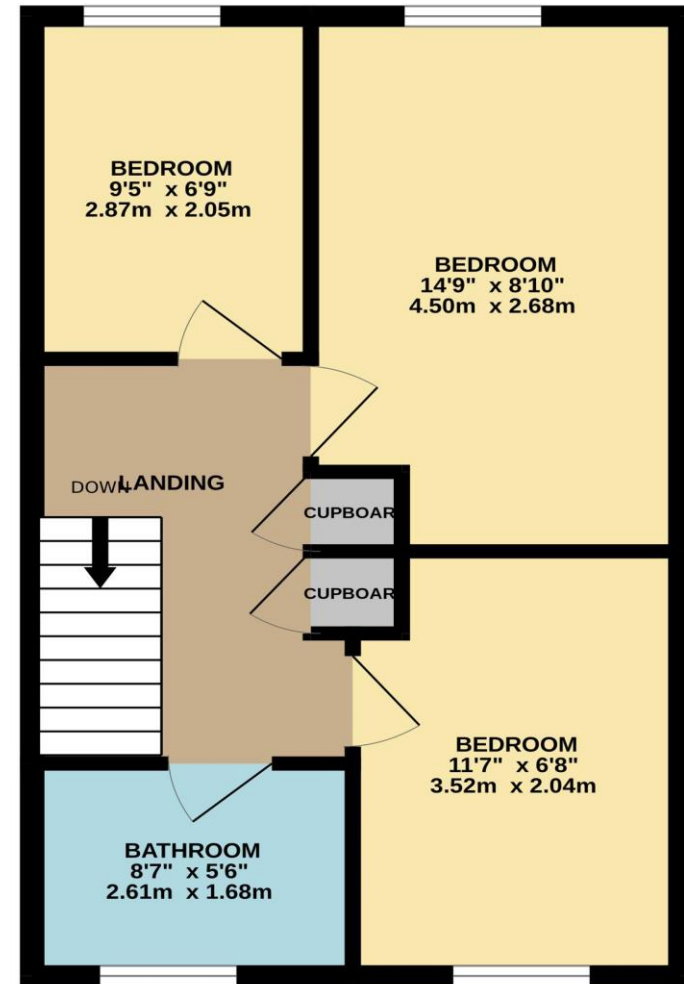

TOTAL FLOOR AREA : 826 sq.ft. (76.8 sq.m.) approx.

Whilst every attempt has been made to ensure the accuracy of the floorplan contained here, measurements of doors, windows, rooms and any other items are approximate and no responsibility is taken for any error, omission or mis-statement. This plan is for illustrative purposes only and should be used as such by any prospective purchaser. The services, systems and appliances shown have not been tested and no guarantee as to their operability or efficiency can be given.
Made with Metropix ©2025

