





## Hollybush Way, West Cheshunt, EN7 6EP

This THREE BEDROOM well-presented DETACHED property in the heart of sought after WEST CHESHUNT benefits from three spacious bedrooms, DOWNSTAIRS W/C, off street parking with ADDITIONAL GARAGE, en-suite to master bedroom, dining area and separate kitchen. With gas central heating and double-glazed windows throughout.

### Key features

- Three Bedrooms
- Detached
- Garage
- Downstairs W/C
- En-Suite To Master
- Sought After West Cheshunt
- Gas Central Heating
- Double Glazed Windows

### Property Information

Tenure  
Freehold

Council Tax  
E

EPC Rating  
C

Local Authority  
Broxbourne Borough Council



**Paul Wallace Estate Agents**  
Brookfield Centre  
Cheshunt  
Hertfordshire  
EN8 0NN



01992 781100



cheshunt@paulwallace.co.uk



www.paulwallace.co.uk



**Opening Times**

Mon - Fri	9 am to 6:30 pm
Sat	9 am to 5:30 pm
Sun	Closed
Bank Hols	Closed

**paulwallace**  
estate agents

Cheshunts leading estate agent.  
Please get in touch for your free  
property valuation.











GROUND FLOOR  
417 sq.ft. (38.7 sq.m.) approx.

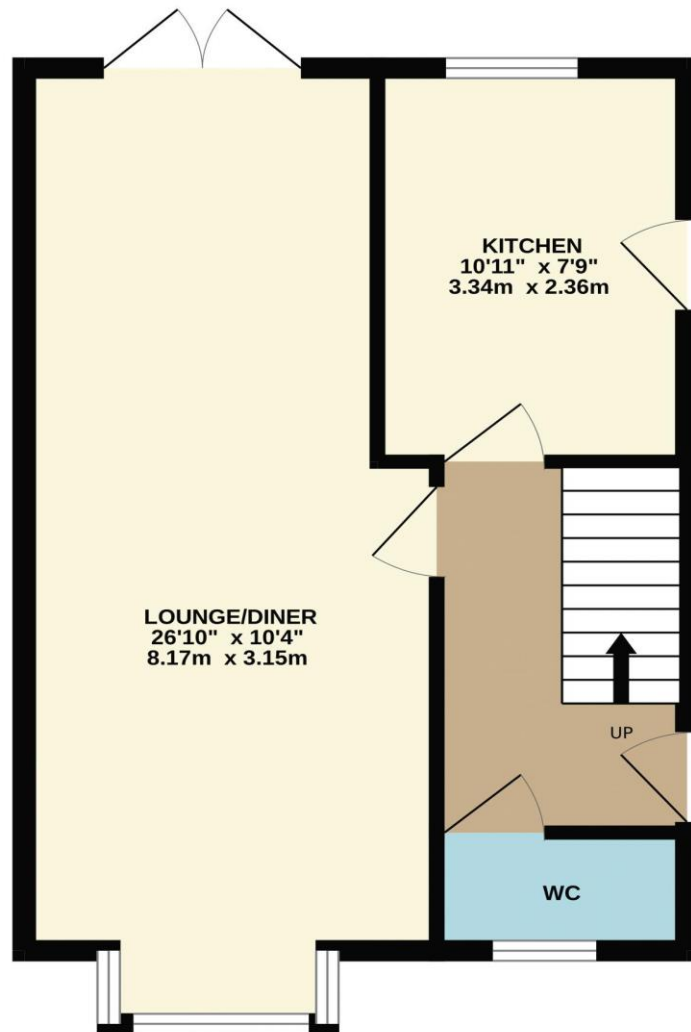

1ST FLOOR  
406 sq.ft. (37.7 sq.m.) approx.

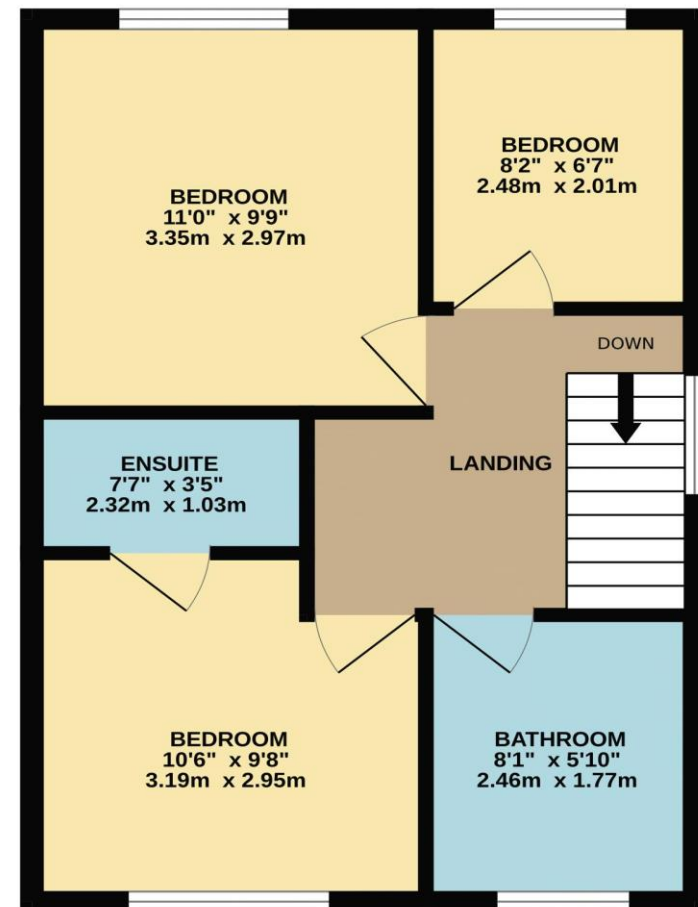

TOTAL FLOOR AREA : 822 sq.ft. (76.4 sq.m.) approx.

Whilst every attempt has been made to ensure the accuracy of the floorplan contained here, measurements of doors, windows, rooms and any other items are approximate and no responsibility is taken for any error, omission or mis-statement. This plan is for illustrative purposes only and should be used as such by any prospective purchaser. The services, systems and appliances shown have not been tested and no guarantee as to their operability or efficiency can be given.

Made with Metropix ©2025



