



 paulwallace

Hollybush Way, West Cheshunt, EN7 6ER |
£259,995 | Leasehold

Hollybush Way, West Cheshunt, EN7 6ER

****CHAIN-FREE**** - This TWO BEDROOM GROUND FLOOR maisonette is ideal for first time buyers and investors alike. Well presented throughout and benefitting from both a LONG LEASE of 176 Years and ALLOCATED PARKING space adjacent to the property. Located in a popular area of West Cheshunt and offers easy access to A10 & M25.

Key features

- Chain-Free
- Two Bedrooms
- Well Presented
- Ground Floor
- Allocated Parking
- Gas Central Heating
- Double Glazed
- Long Lease of 176 Years

Property Information

Tenure

Leasehold

Council Tax

C

EPC Rating

D



Paul Wallace Estate Agents
Brookfield Centre
Cheshunt
Hertfordshire
EN8 0NN



01992 781100



cheshunt@paulwallace.co.uk



www.paulwallace.co.uk



Opening Times

Mon - Fri	9 am to 6:30 pm
Sat	9 am to 5:30 pm
Sun	Closed
Bank Hols	Closed

paulwallace
estate agents

Cheshunts leading estate agent.
Please get in touch for your free
property valuation.







GROUND FLOOR
462 sq.ft. (42.9 sq.m.) approx.

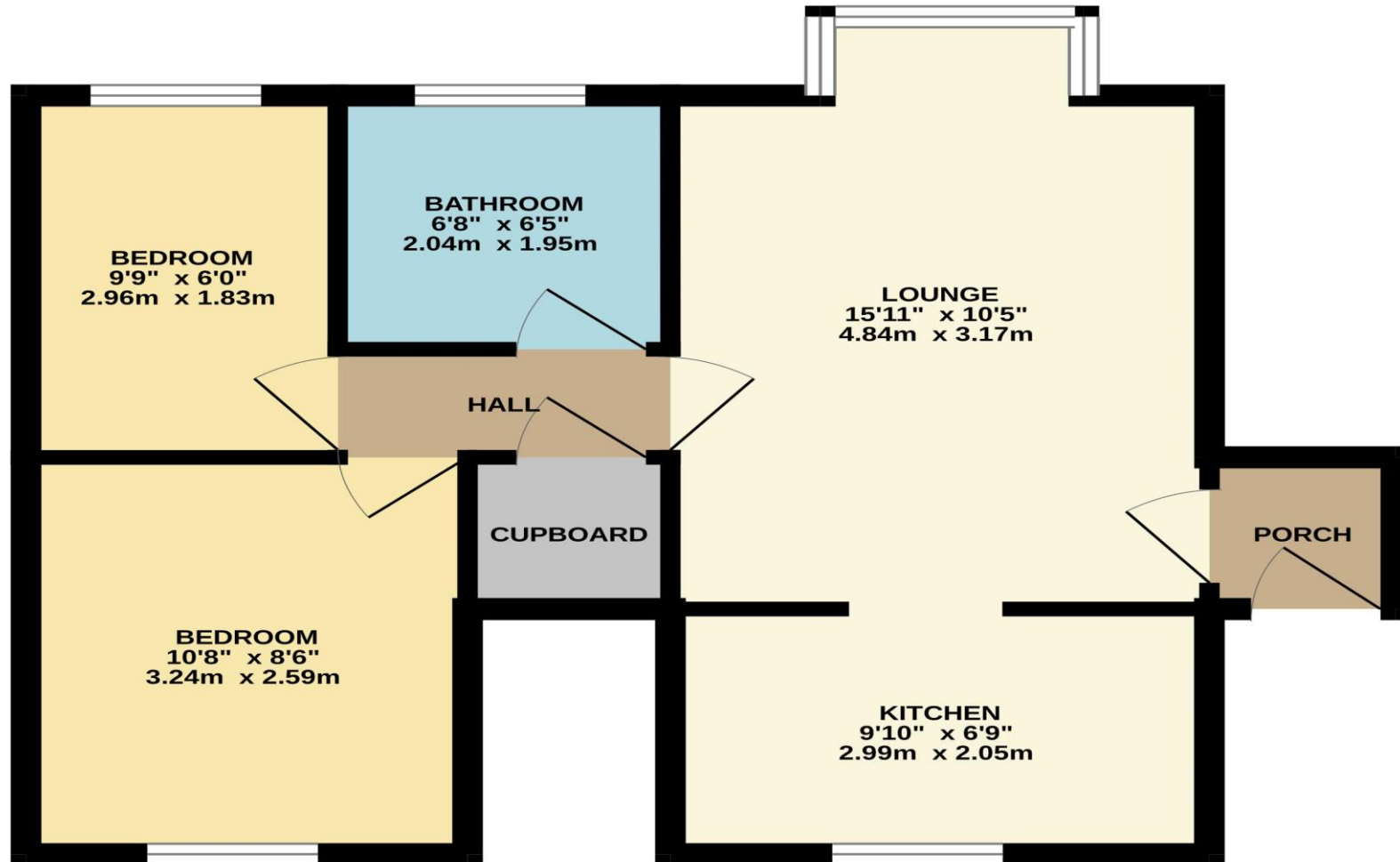

TOTAL FLOOR AREA : 462 sq.ft. (42.9 sq.m.) approx.

Whilst every attempt has been made to ensure the accuracy of the floorplan contained here, measurements of doors, windows, rooms and any other items are approximate and no responsibility is taken for any error, omission or mis-statement. This plan is for illustrative purposes only and should be used as such by any prospective purchaser. The services, systems and appliances shown have not been tested and no guarantee as to their operability or efficiency can be given.
Made with Metropix ©2025