



Hampden Crescent, West Cheshunt, EN7 5AX

This BEAUTIFULLY PRESENTED three double bedroom tunnel terraced property in the heart of Bury Green in sought after WEST CHESHUNT benefits from a spacious kitchen/diner opening to ample garden space with storage shed. Boasting a SUPERB FAMILY BATHROOM with additional EN-SUITE TO MASTER, gas central heating and double glazed windows throughout and a generous front drive providing off street parking.

Key features

- Three Bedrooms
- Beautifully Presented
- Superb Family Bathroom
- Gas Central Heating
- Tunnel Terrace
- Off Street Parking
- Sought After West Cheshunt
- Double Glazed Windows

Property Information

Tenure
Freehold

Council Tax
D

EPC Rating
D

Local Authority
Broxbourne Borough Council



Paul Wallace Estate Agents
Brookfield Centre
Cheshunt
Hertfordshire
EN8 0NN



01992 781100



cheshunt@paulwallace.co.uk



www.paulwallace.co.uk



Opening Times

Mon - Fri	9 am to 6:30 pm
Sat	9 am to 5:30 pm
Sun	Closed
Bank Hols	Closed

paulwallace
estate agents

Cheshunts leading estate agent.
Please get in touch for your free
property valuation.







GROUND FLOOR
508 sq.ft. (47.2 sq.m.) approx.

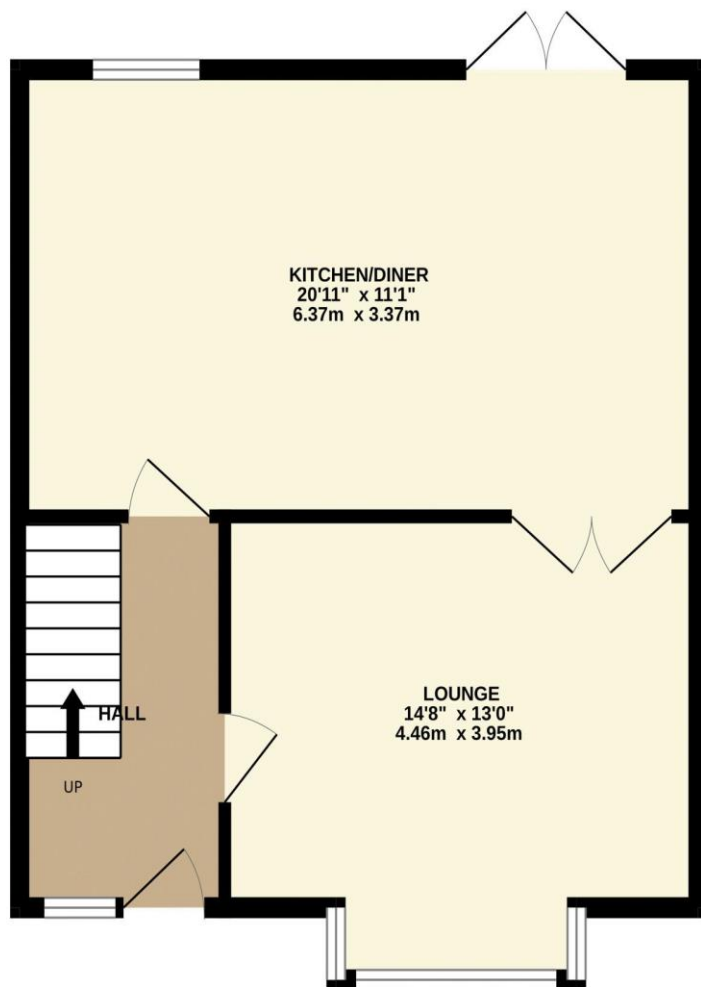

1ST FLOOR
580 sq.ft. (53.9 sq.m.) approx.

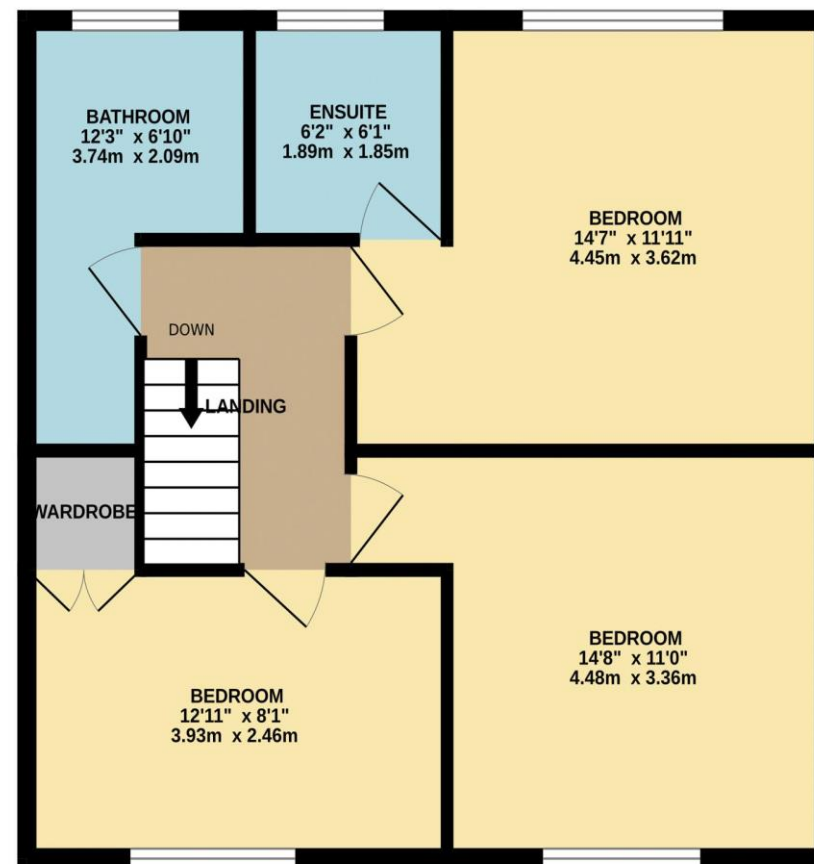

TOTAL FLOOR AREA : 1088 sq.ft. (101.1 sq.m.) approx.

Whilst every attempt has been made to ensure the accuracy of the floorplan contained here, measurements of doors, windows, rooms and any other items are approximate and no responsibility is taken for any error, omission or mis-statement. This plan is for illustrative purposes only and should be used as such by any prospective purchaser. The services, systems and appliances shown have not been tested and no guarantee as to their operability or efficiency can be given.

Made with Metropix ©2025

