



Beechholm Mews, Cheshunt, EN8 0DH

**** WALKING DISTANCE of THE STATION, 995 YEAR LEASE **** This beautifully presented, two bedroom, ground floor apartment, with attractive featuring integrated appliances, a modern shower room and also benefits from allocated, double glazed windows throughout, gas central heating and beautifully maintained communal gardens.

Key features

- Two Bedrooms
- Beautifully Presented
- Gas Central Heating
- Communal Gardens
- Ground Floor
- 995 Year Lease
- Double Glazed Windows
- Allocated Parking

Property Information

Tenure

Share of Freehold

Council Tax

C

EPC Rating

D

Local Authority

Broxbourne Borough Council

Lease Length

995 years remaining

Service Charge & Ground Rent

TBC



Paul Wallace Estate Agents
Brookfield Centre
Cheshunt
Hertfordshire
EN8 0NN



01992 781100



cheshunt@paulwallace.co.uk



www.paulwallace.co.uk



Opening Times

Mon - Fri	9 am to 6:30 pm
Sat	9 am to 5:30 pm
Sun	Closed
Bank Hols	Closed

paulwallace
estate agents

Cheshunts leading estate agent.
Please get in touch for your free
property valuation.







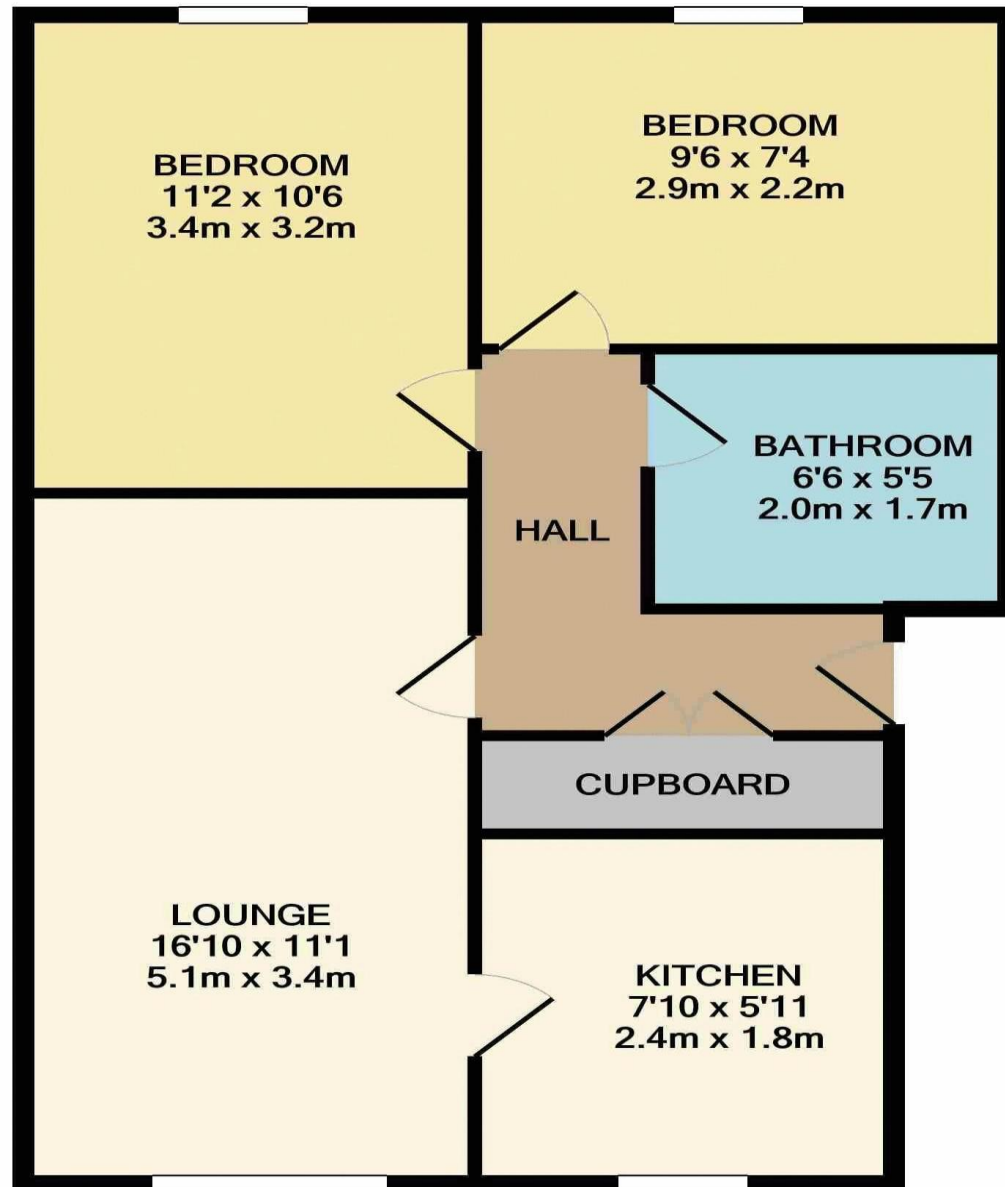

TOTAL APPROX. FLOOR AREA 730 SQ.FT. (67.8 SQ.M.)

Whilst every attempt has been made to ensure the accuracy of the floor plan contained here, measurements of doors, windows, rooms and any other items are approximate and no responsibility is taken for any error, omission, or mis-statement. This plan is for illustrative purposes only and should be used as such by any prospective purchaser. The services, systems and appliances shown have not been tested and no guarantee as to their operability or efficiency can be given

Made with Metropix ©2020

