



 paulwallace

Benedictine Gate, Cheshunt, EN8 0XB |
£505,000 | Freehold

Benedictine Gate, Cheshunt, EN8 0XB

****NO CHAIN**** Situated on the highly regarded THOMAS ROCHFORD DEVELOPMENT and close to the lovely open spaces of the LEE VALLEY PARK a LARGER than AVERAGE/EXTENDED three bedroom LINKED DETACHED house . The property features a SPACIOUS DOUBLE RECEPTION ROOM, conservatory, newly REFIITED LARGE KITCHEN/DINING ROOM, well appointed bathroom and downstairs cloakroom/WC, WEST FACING 40' REAR GARDEN and ample DRIVEWAY parking.

Key features

- No Onward Chain
- Popular Thomas Rochford Estate
- Stunning and Large Newly Fitted Kitchen/Dining Room
- Downstairs Cloaks/WC
- Extended Linked Detached House with Scope To Extend Further (stpp)
- Large Double Reception Room and Conservatory
- Three Bedrooms
- West Facing Garden and Ample Driveway Parking

Property Information

Tenure

Freehold

Council Tax

E

EPC Rating

D



Paul Wallace Estate Agents
Brookfield Centre
Cheshunt
Hertfordshire
EN8 0NN



01992 781100



cheshunt@paulwallace.co.uk



www.paulwallace.co.uk



Opening Times

Mon - Fri	9 am to 6:30 pm
Sat	9 am to 5:30 pm
Sun	Closed
Bank Hols	Closed

paulwallace
estate agents

Cheshunts leading estate agent.
Please get in touch for your free
property valuation.



paulwallace





 paulwallace



 paulwallace



 paulwallace



 paulwallace

GROUND FLOOR
632 sq.ft. (58.7 sq.m.) approx.

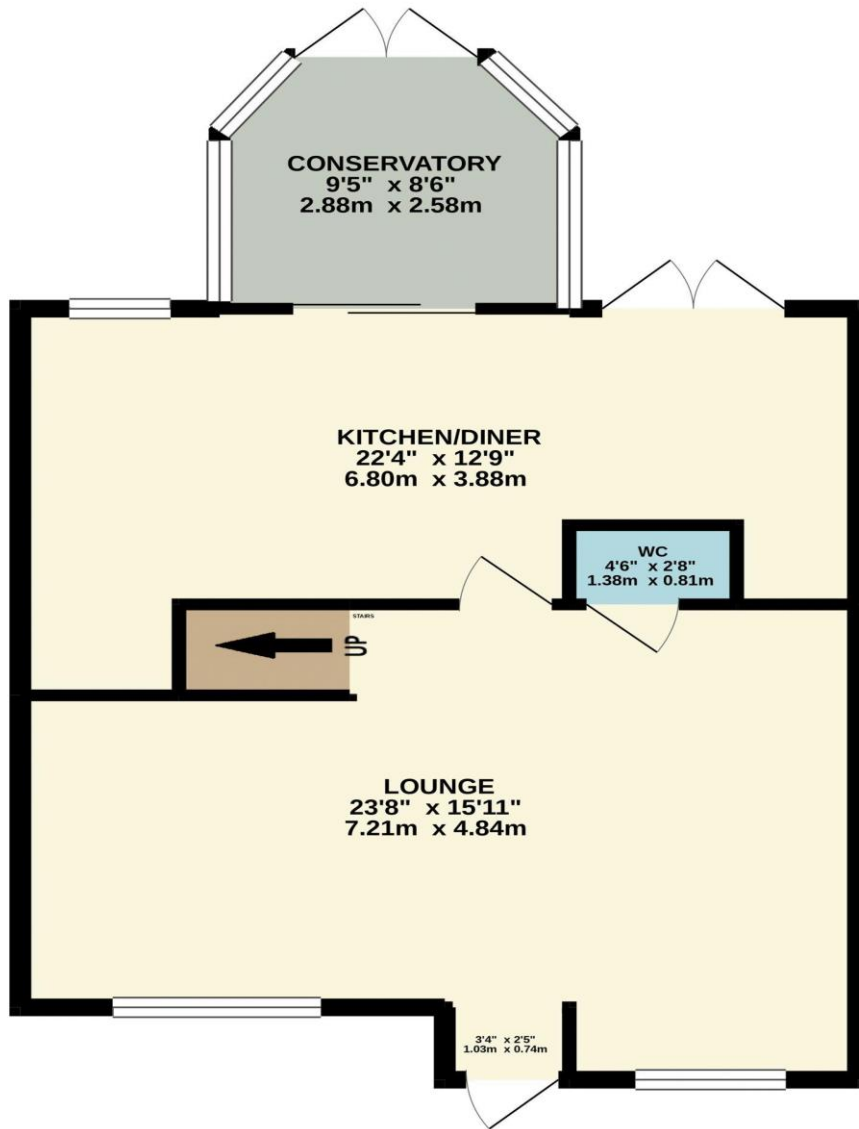

1ST FLOOR
347 sq.ft. (32.3 sq.m.) approx.

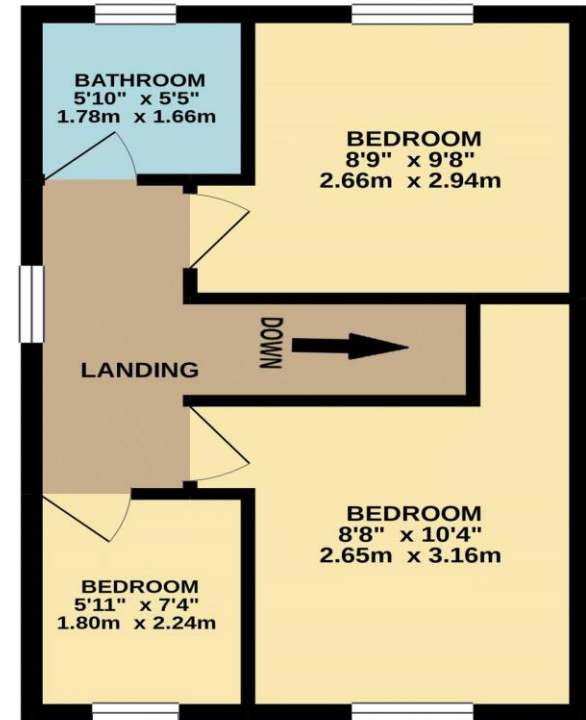

TOTAL FLOOR AREA : 979 sq.ft. (91.0 sq.m.) approx.

Whilst every attempt has been made to ensure the accuracy of the floorplan contained here, measurements of doors, windows, rooms and any other items are approximate and no responsibility is taken for any error, omission or mis-statement. This plan is for illustrative purposes only and should be used as such by any prospective purchaser. The services, systems and appliances shown have not been tested and no guarantee as to their operability or efficiency can be given.

Made with Metropix ©2021

