

**WITH
GARAGE**



 paulwallace

Vancouver Road, Turnford, EN10 6FB |
£279,995 | Leasehold

Vancouver Road, Turnford, EN10 6FB

****TWO BEDROOM FIRST FLOOR FLAT WITH OWN GARAGE**** Situated in the highly desirable CANADA FIELDS DEVELOPMENT a very well presented and maintained apartment. The property benefits from SPACIOUS LOUNGE with Juliette balcony doors, FULLY FITTED KITCHEN, main bedroom with en-suite, further main bathroom and OWN GARAGE adjacent to the property.

Key features

- Desirable Modern Development
- 100 plus year Lease
- Spacious Lounge/Dining
- Main Bedroom and En-Suite
- First Floor Flat
- Own Garage
- Separate Fully Fitted Kitchen
- Secondary Bathroom

Property Information

Tenure

Leasehold

Council Tax

C

EPC Rating

TBC

Local Authority

Broxbourne Borough Council

Lease Length

102 Years

Service Charge & Ground Rent

SC - £1,500 P/A

GR - £85 P/A



Paul Wallace Estate Agents
Brookfield Centre
Cheshunt
Hertfordshire
EN8 0NN



01992 781100



cheshunt@paulwallace.co.uk



www.paulwallace.co.uk



Opening Times

Mon - Fri	9 am to 6:30 pm
Sat	9 am to 5:30 pm
Sun	Closed
Bank Hols	Closed

Paul Wallace
estate agents

Cheshunts leading estate agent.
Please get in touch for your free
property valuation.



Paul Wallace





GROUND FLOOR

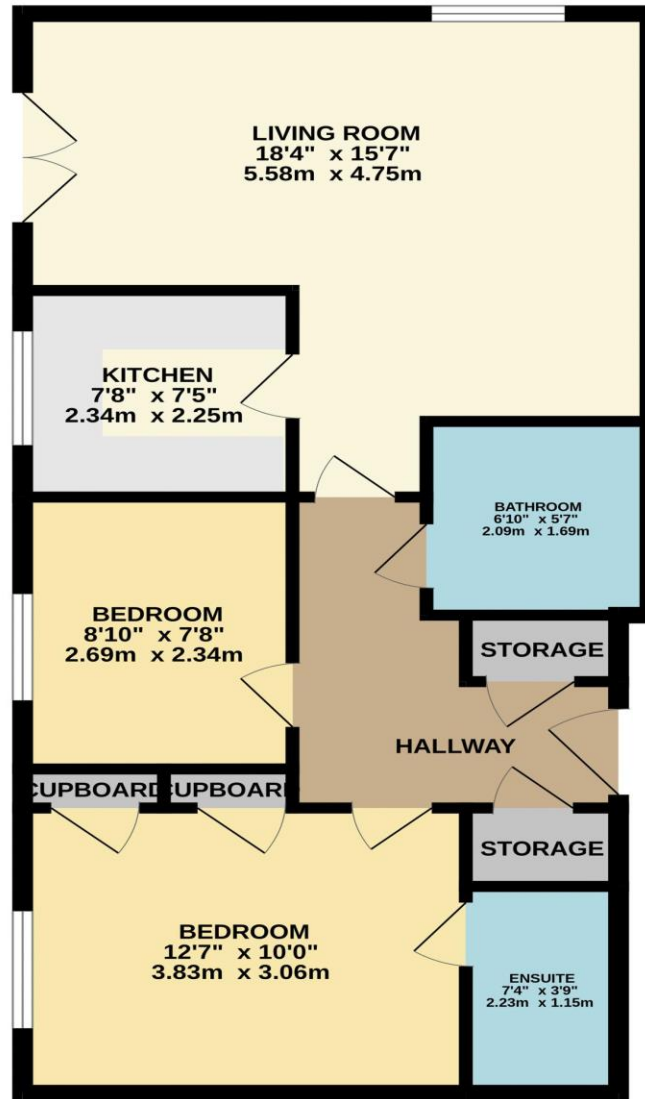



 paulwallace



 paulwallace



Paul Wallace Estate Agents
 Brookfield Centre
 Cheshunt
 Hertfordshire
 EN8 0NN



01992 781100



cheshunt@paulwallace.co.uk



www.paulwallace.co.uk



Opening Times

Mon - Fri	9 am to 6:30 pm
Sat	9 am to 5:30 pm
Sun	Closed
Bank Hols	Closed

 **paulwallace**
 estate agents

Agents note: Whilst every care has been taken to prepare these sales particulars, they are for guidance purposes only. All measurements are approximate and are for general guidance purposes only and whilst every care has been taken to ensure their accuracy, they should not be relied upon. Potential buyers are advised to recheck measurements.