



paulwallace
01992 781100
FOR SALE

SORBUS ROAD

 paulwallace

Sorbus Road, Turnford, EN10 6GD |
£275,000 | Leasehold

Sorbus Road, Turnford, EN10 6GD

This TWO BEDROOM first floor flat in sought after TUNRFORD benefits from a security entry system to own front door. Beautifully presented throughout with a REFITTED KITCHEN and SUPERB BATHROOM SUITE with additional EN-SUITE TO MASTER BEDROOM. With a balcony off the lounge and allocated parking.

Key features

- Two Bedrooms
- Allocated Parking
- Security Entry System
- Superb Bathroom
- First Floor
- En-Suite To Master
- Refitted Kitchen
- Balcony

Property Information

Tenure

Leasehold

Council Tax

C

EPC Rating

C

Local Authority

Broxbourne Council

Lease Length

125 years from January 2008

Service Charge & Ground Rent

SC - £1,560 pa & GR - £225 pa



Paul Wallace Estate Agents
Brookfield Centre
Cheshunt
Hertfordshire
EN8 0NN



01992 781100



cheshunt@paulwallace.co.uk



www.paulwallace.co.uk



Opening Times

Mon - Fri	9 am to 6:30 pm
Sat	9 am to 5:30 pm
Sun	Closed
Bank Hols	Closed

paulwallace
estate agents

Cheshunts leading estate agent.
Please get in touch for your free
property valuation.



paulwallace





GROUND FLOOR
653 sq.ft. (60.7 sq.m.) approx.

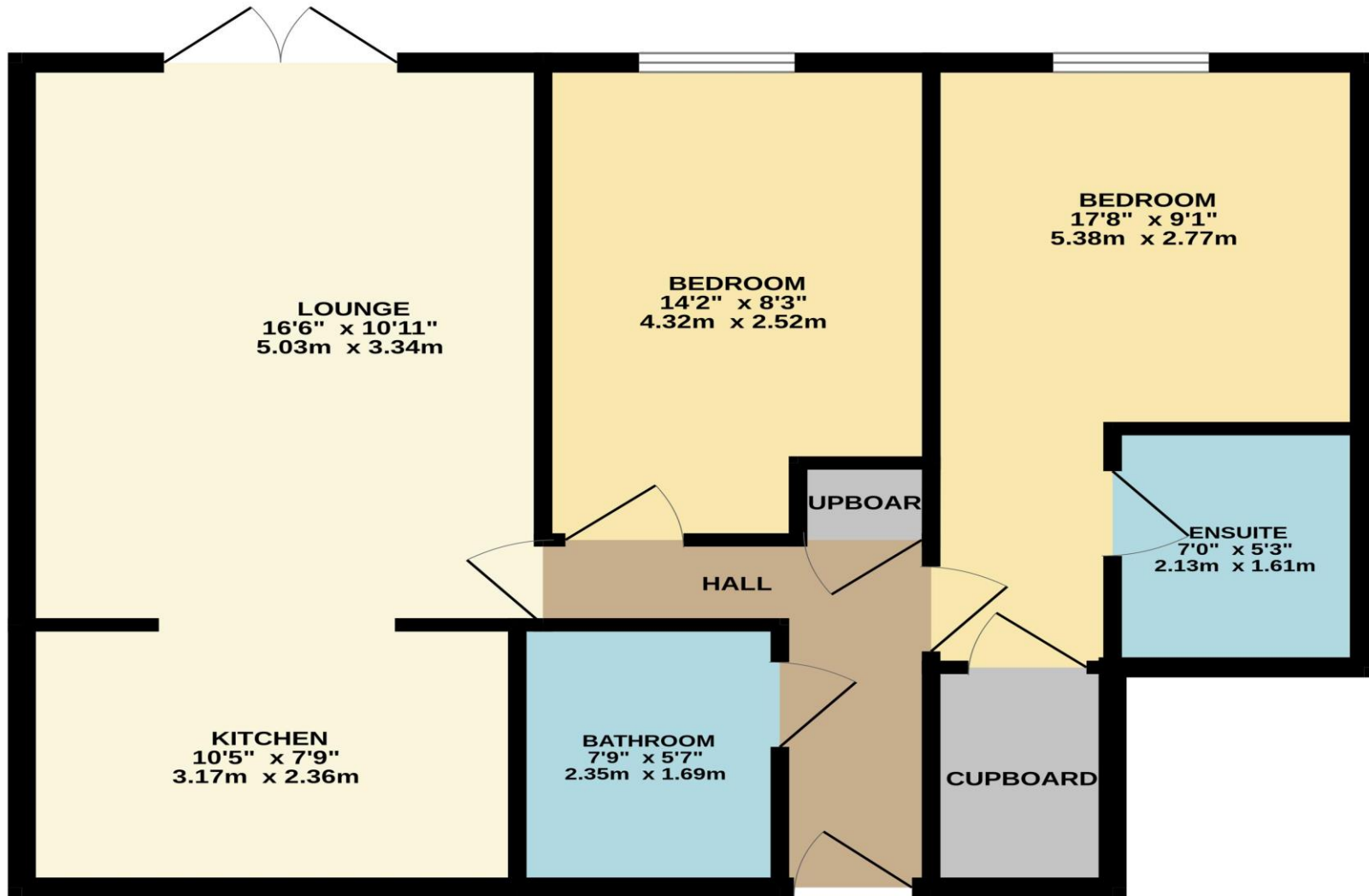

TOTAL FLOOR AREA : 653 sq.ft. (60.7 sq.m.) approx.

Whilst every attempt has been made to ensure the accuracy of the floorplan contained here, measurements of doors, windows, rooms and any other items are approximate and no responsibility is taken for any error, omission or mis-statement. This plan is for illustrative purposes only and should be used as such by any prospective purchaser. The services, systems and appliances shown have not been tested and no guarantee as to their operability or efficiency can be given.
Made with Metropix ©2024

