



 paulwallace

Rosedale Way, West Cheshunt, EN7 6ES |  
£209,995 | Leasehold



## Rosedale Way, West Cheshunt, EN7 6ES

\* RETIREMENT APARTMENT FOR THE OVER 60's \* CHAIN FREE one bedroom GROUND FLOOR retirement apartment, LOUNGE/ DINER, fitted kitchen, bathroom/ W.C, well tended communal gardens, residents facilities.

### Key features

- \*\* CHAIN FREE \*\*
- Ground Floor
- Fitted Kitchen
- Residents Facilities
- Retirement Apartment
- Double Bedroom
- Well Presented Throughout
- Attractive Communal Gardens

### Property Information

Tenure

Leasehold

Council Tax

B

EPC Rating

D

Local Authority

Broxbourne Borough Council

Lease Length

152 Years

Service Charge & Ground Rent

£2871 per year



**Paul Wallace Estate Agents**  
Brookfield Centre  
Cheshunt  
Hertfordshire  
EN8 0NN

 01992 781100

 cheshunt@paulwallace.co.uk

 www.paulwallace.co.uk

 Opening Times

Mon - Fri	9 am to 6:30 pm
Sat	9 am to 5:30 pm
Sun	Closed
Bank Hols	Closed

 **paulwallace**  
estate agents

Cheshunts leading estate agent.  
Please get in touch for your free  
property valuation.











GROUND FLOOR  
523 sq.ft. (48.6 sq.m.) approx.

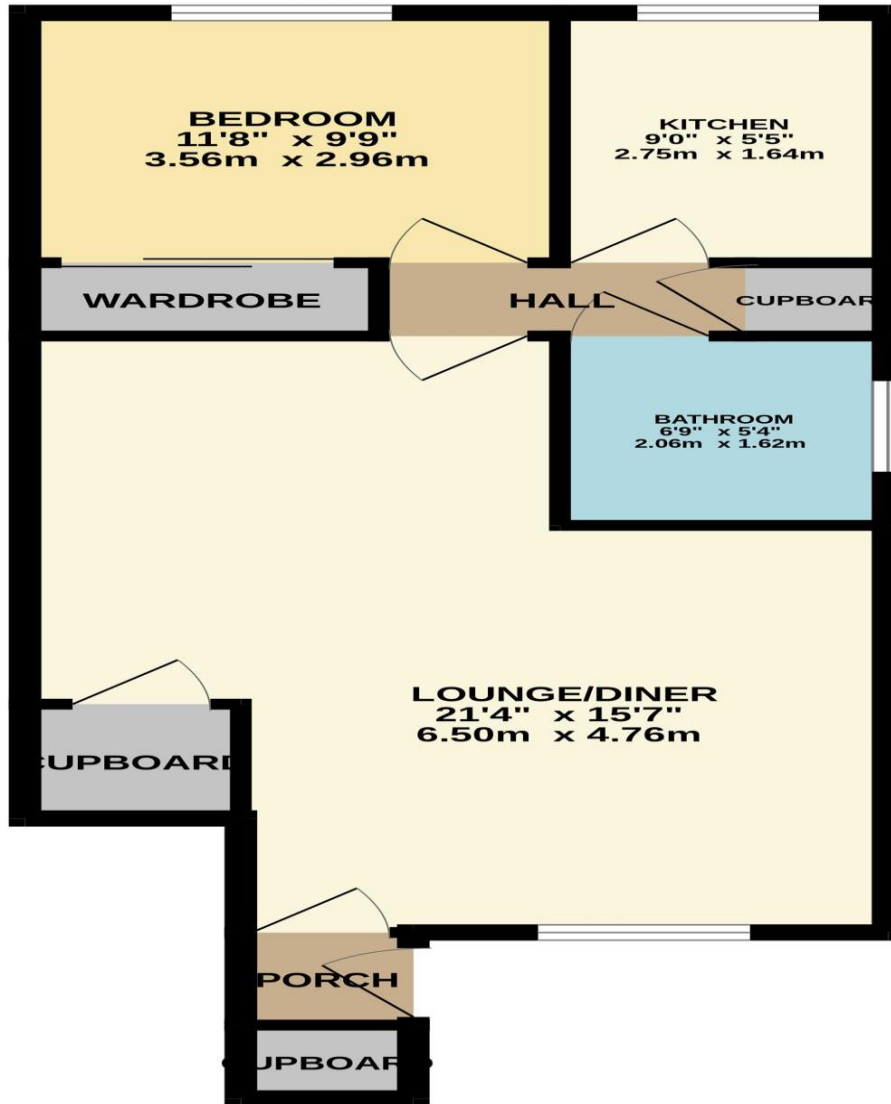

TOTAL FLOOR AREA : 523 sq.ft. (48.6 sq.m.) approx.

Whilst every attempt has been made to ensure the accuracy of the floorplan contained here, measurements of doors, windows, rooms and any other items are approximate and no responsibility is taken for any error, omission or mis-statement. This plan is for illustrative purposes only and should be used as such by any prospective purchaser. The services, systems and appliances shown have not been tested and no guarantee as to their operability or efficiency can be given.  
Made with Metropix ©2024