 paulwallace

Turners Hill, Cheshunt, EN8 9DU |
£240,000 | Leasehold

Turners Hill, Cheshunt, EN8 9DU

This CHAIN FREE TWO BEDROOM ground floor flat in the heart of CENTRAL CHESHUNT is perfectly located for both transport links and local amenities. Benefitting from a SPACIOUS LOUNGE, ALLOCATED PARKING and a communal courtyard. Ideal first time buy.

Key features

- Chain Free
- Ground Floor
- Communal Courtyard
- Located In Central Cheshunt
- Two Bedrooms
- Allocated Parking
- Spacious Lounge
- Ideal First Time Buy

Property Information

Tenure

Leasehold

Council Tax

C

EPC Rating

C

Local Authority

Broxbourne Borough Council

Lease Length

86 years

Service Charge & Ground Rent

£50 per year & £2557 per year



Paul Wallace Estate Agents
Brookfield Centre
Cheshunt
Hertfordshire
EN8 0NN



01992 781100



cheshunt@paulwallace.co.uk



www.paulwallace.co.uk



Opening Times

Mon - Fri	9 am to 6:30 pm
Sat	9 am to 5:30 pm
Sun	Closed
Bank Hols	Closed

paulwallace
estate agents

Cheshunts leading estate agent.
Please get in touch for your free
property valuation.





 paulwallace



GROUND FLOOR
594 sq.ft. (55.2 sq.m.) approx.

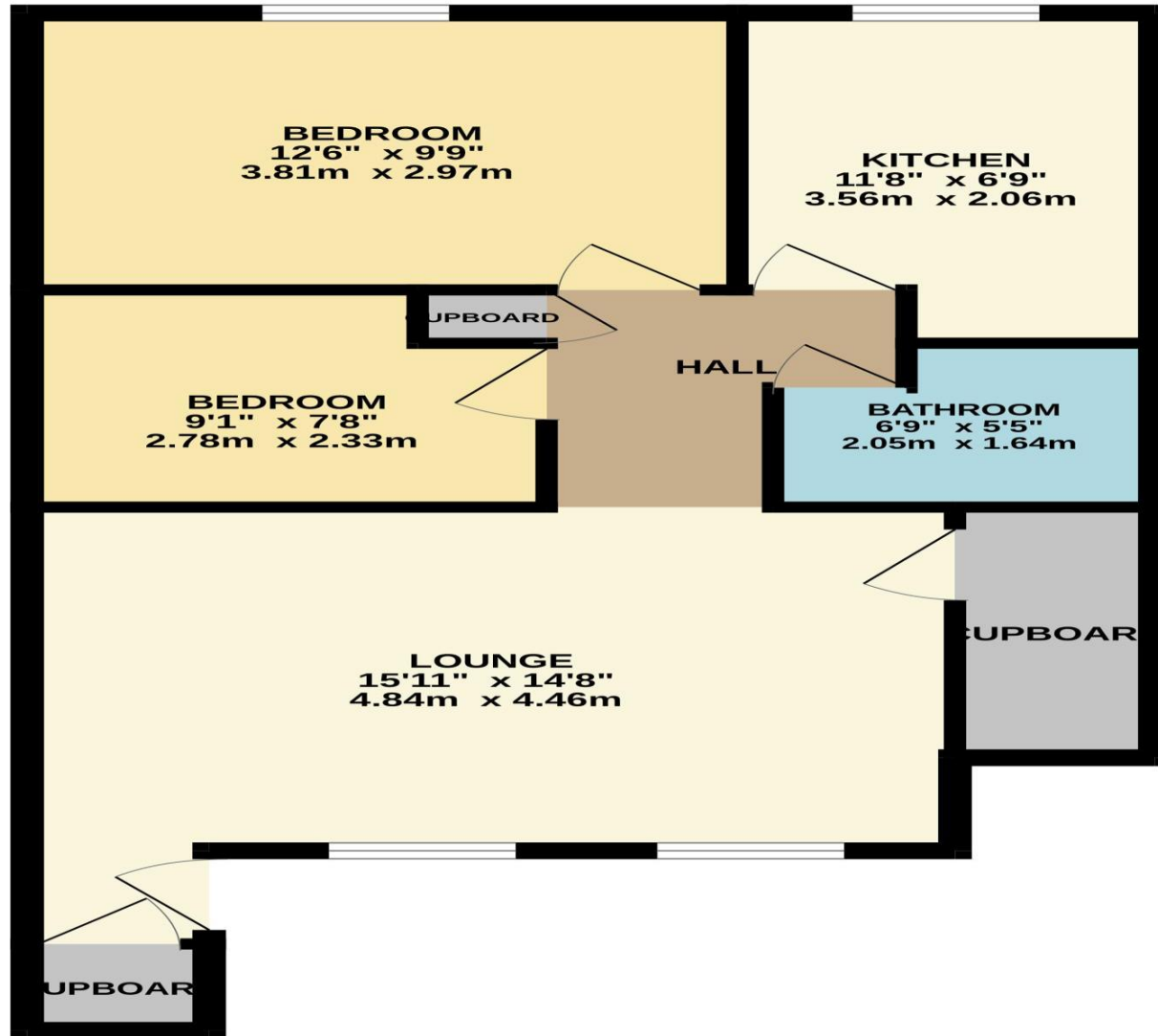

TOTAL FLOOR AREA : 594 sq.ft. (55.2 sq.m.) approx.

Whilst every attempt has been made to ensure the accuracy of the floorplan contained here, measurements of doors, windows, rooms and any other items are approximate and no responsibility is taken for any error, omission or mis-statement. This plan is for illustrative purposes only and should be used as such by any prospective purchaser. The services, systems and appliances shown have not been tested and no guarantee as to their operability or efficiency can be given.
Made with Metropix ©2024