



 paulwallace

Crossbrook Street, Cheshunt, EN8 8JU |
£170,000 | Leasehold

Crossbrook Street, Cheshunt, EN8 8JU

**** CHAIN FREE **** STUDIO FLAT in CENTRAL CHESHUNT with a GARAGE TO THE REAR and set in an IDEAL LOCATION for both transport links and local shops. Benefitting from a long lease this would be an ideal rental opportunity.

Key features

- **** CHAIN FREE ****
- Lounge
- Bathroom
- Close To The Station
- Studio Flat
- Ideal Rental
- Kitchen
- Close To Local Shops

Property Information

Tenure
Leasehold

Council Tax
B

EPC Rating
C

Lease Length
994 years

Service Charge
£1054 per year



 paulwallace
estate agents

hoddesdon@paulwallace.co.uk

01992 466471



 paulwallace



FIRST FLOOR
331 sq.ft. (30.8 sq.m.) approx.

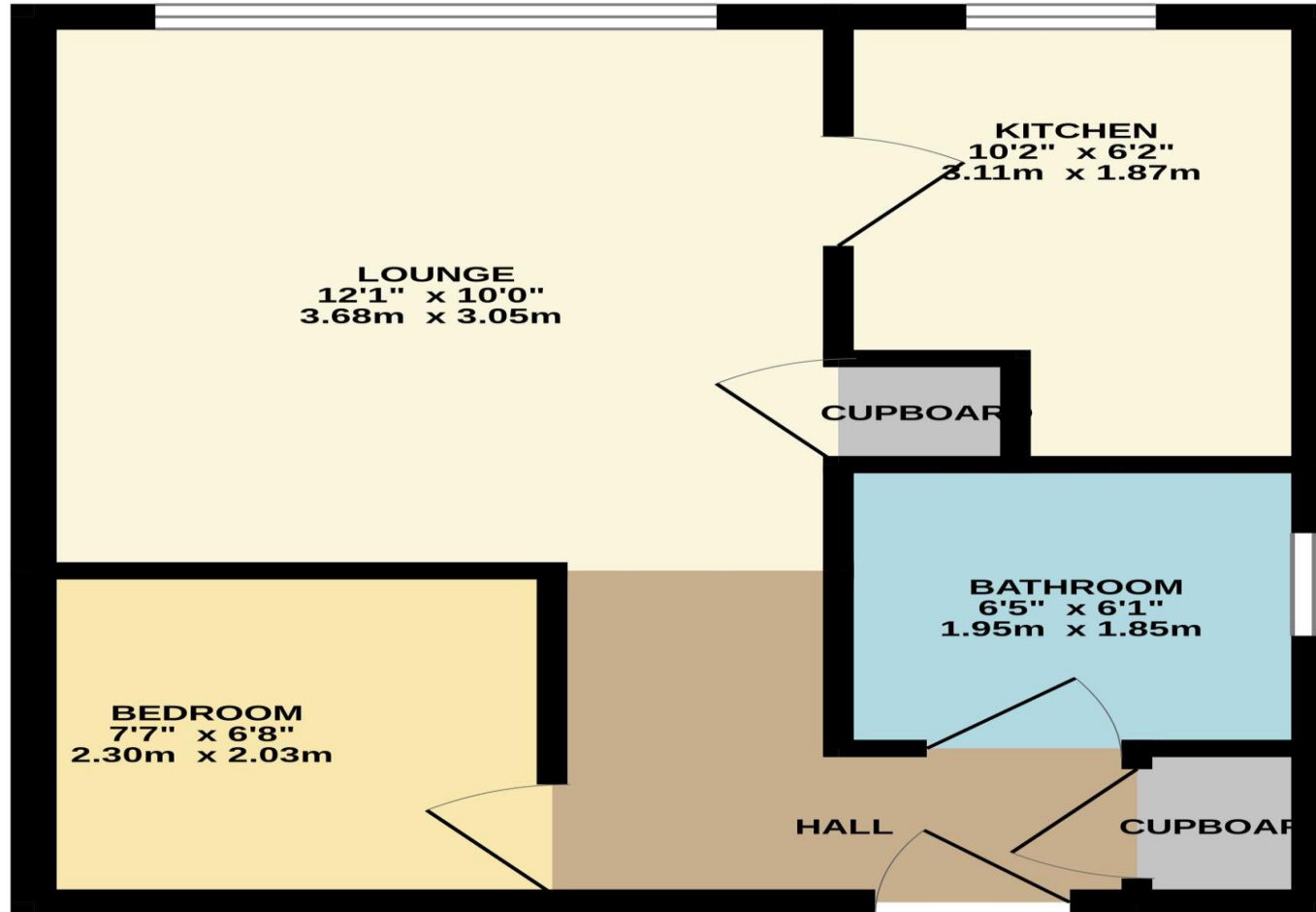

TOTAL FLOOR AREA : 331 sq.ft. (30.8 sq.m.) approx.

Whilst every attempt has been made to ensure the accuracy of the floorplan contained here, measurements of doors, windows, rooms and any other items are approximate and no responsibility is taken for any error, omission or mis-statement. This plan is for illustrative purposes only and should be used as such by any prospective purchaser. The services, systems and appliances shown have not been tested and no guarantee as to their operability or efficiency can be given.
Made with Metropix ©2023



Registered Address: Unit 3 The Brookfield Centre, Cheshunt, Herts, EN8 0NN Company Registration Number: OC414280 | VAT Number: 276958046©2022 Paul Wallace Group LLP trading as Paul Wallace Estate Agents



Paul Wallace Estate Agents
Brookfield Centre
Cheshunt
Hertfordshire
EN8 0NN



01992 781100



cheshunt@paulwallace.co.uk



www.paulwallace.co.uk



Opening Times

Mon - Fri	9 am to 7 pm
Sat	9 am to 5:30 pm
Sun	Closed
Bank Hols	Closed

 **paulwallace**
estate agents

Agents note: Whilst every care has been taken to prepare these sales particulars, they are for guidance purposes only. All measurements are approximate and are for general guidance purposes only and whilst every care has been taken to ensure their accuracy, they should not be relied upon. Potential buyers are advised to recheck measurements.