 paulwallace

Highland Road, Nazeing, EN9 2PX |
£515,000 | Freehold

Key features

- Chain-free detached bungalow with 1,340 sq ft of versatile accommodation
- Three reception rooms: lounge/diner, bright conservatory, and comfortable sitting room
- Stunning 85' south-east facing garden with exceptional Lea Valley views
- Garage with potential for conversion or use as storage/parking
- Two generously proportioned double bedrooms
- Attractive, well-equipped kitchen and four-piece bathroom with W.C.
- Block-paved driveway with off-street parking and additional parking available
- Sought-after location, ideal for single-level living

Property Information

Tenure Freehold

Council Tax E

EPC Rating C

Local Authority Epping Forest District Council



 paulwallace
estate agents

hoddesdon@paulwallace.co.uk

01992 466471





GROUND FLOOR
1339 sq.ft. (124.4 sq.m.) approx.

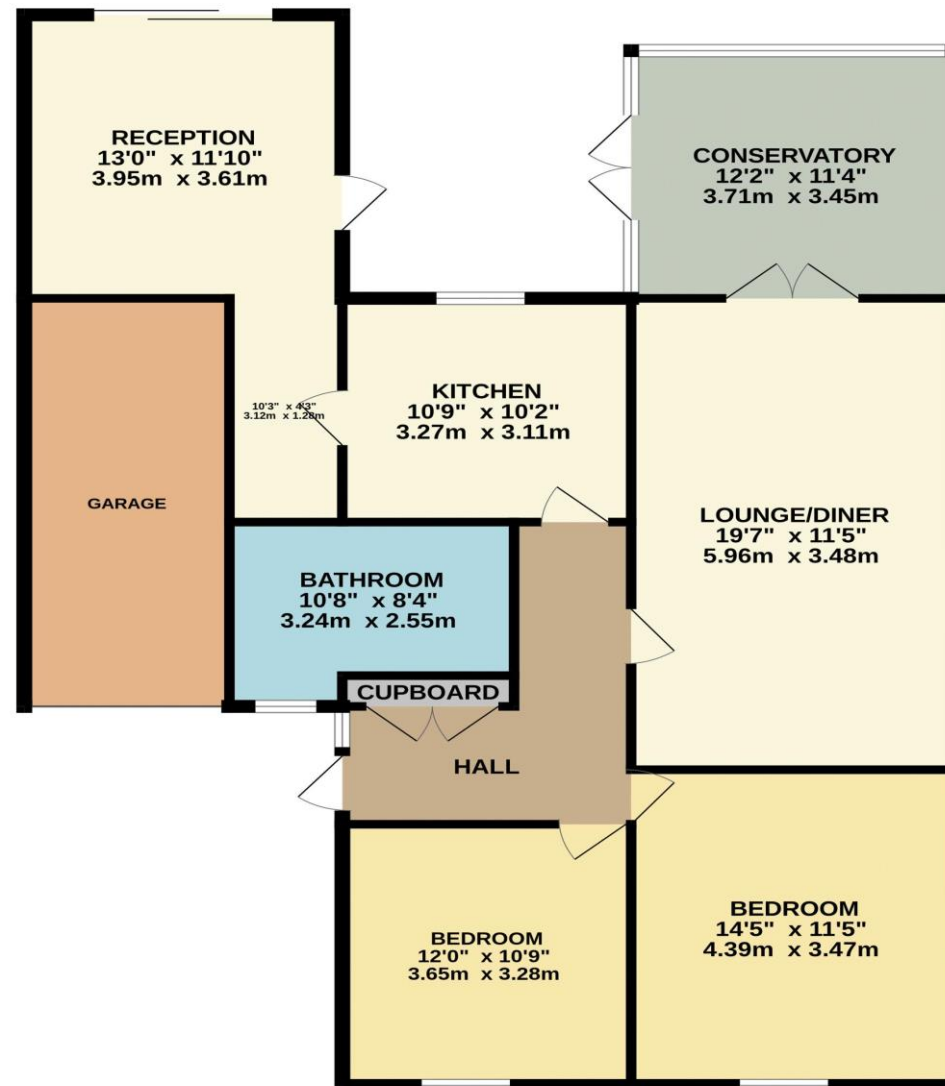

TOTAL FLOOR AREA : 1339 sq.ft. (124.4 sq.m.) approx.

Whilst every attempt has been made to ensure the accuracy of the floorplan contained here, measurements of doors, windows, rooms and any other items are approximate and no responsibility is taken for any error, omission or mis-statement. This plan is for illustrative purposes only and should be used as such by any prospective purchaser. The services, systems and appliances shown have not been tested and no guarantee as to their operability or efficiency can be given.
Made with Metropix ©2025





ed

Photo 18



Paul Wallace Estate Agents

70 High Street
Hoddesdon
Hertfordshire
EN11 8ET



01992 466471



hoddesdon@paulwallace.co.uk



www.paulwallace.co.uk



Opening Times

Mon	9am to 6.30pm
Tues	9am to 6.30pm
Wed	9am to 6.30pm
Thurs	9am to 6.30pm
Fri	9am to 6.30pm
Sat	9am to 5.00pm
Sun	Closed