



Burford Street, Hoddesdon, EN11 8JN

This exquisite end-of-terrace Victorian cottage offers charm and modern living, offering a harmonious blend of character and contemporary design. With two generously sized double bedrooms, this property is ideal for professionals seeking comfort and style. The property is in exceptional condition throughout, featuring a stunning high-gloss kitchen, bright and spacious open-plan lounge and dining room providing an inviting atmosphere, perfect for both relaxation and entertaining. A superb four-piece bathroom/W.C. adds to the property's appeal, featuring modern fixtures that

Key features

- Two double bedrooms for ample living space
- Exceptional condition throughout
- Bright and spacious open-plan lounge and dining room
- 65' rear garden featuring a patio, lawn, and garden shed
- End-of-terrace Victorian cottage exuding charm
- Stunning high-gloss kitchen equipped for modern living
- Superb four-piece bathroom/W.C. with contemporary fittings
- Conveniently located near Hoddesdon town centre and railway station

Property Information

Tenure
Freehold
Council Tax
C
EPC Rating
D

 paulwallace
estate agents

hoddesdon@paulwallace.co.uk

01992 466471







Ground Floor

Approx. 32.4 sq. metres (348.6 sq. feet)

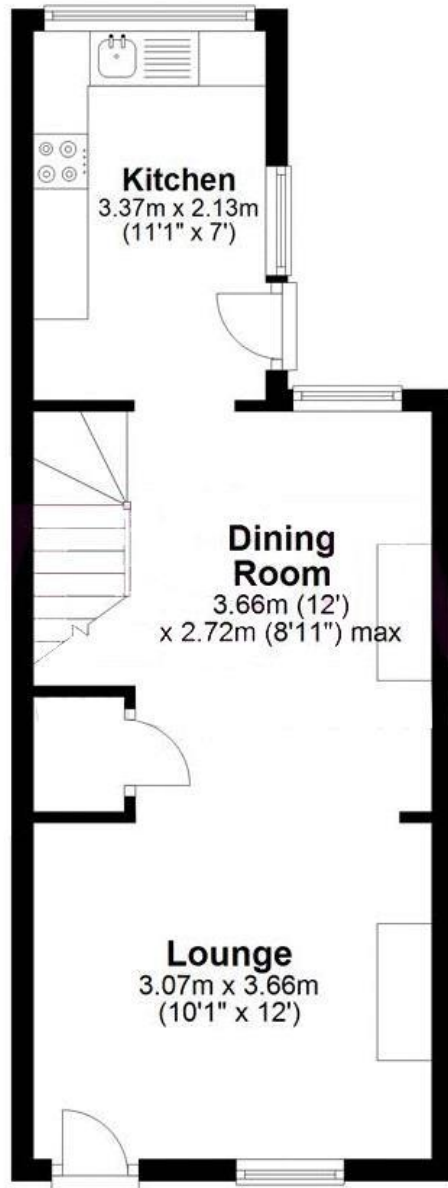

First Floor

Approx. 33.0 sq. metres (355.2 sq. feet)

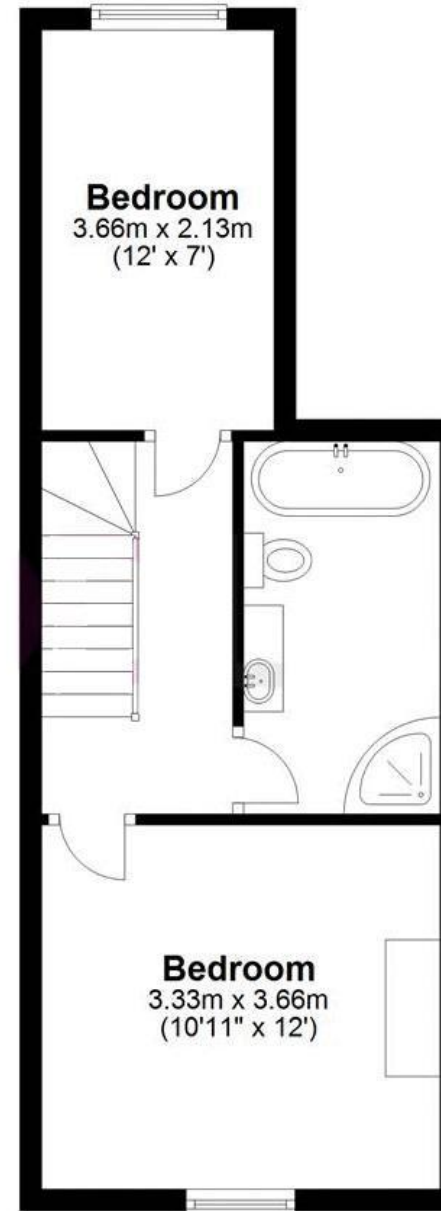

Total area: approx. 65.4 sq. metres (703.8 sq. feet)

FOR ILLUSTRATIVE PURPOSES ONLY. NOT TO SCALE. Whilst every attempt had been made to ensure the accuracy of the floor plan shown, all measurements, positioning, fixtures, features, fittings and any other data shown are an approximate interpretation for illustrative purposes only and are not to scale. No responsibility is taken for any error, omission, miss-statement or use of data shown. Property marketing provided by Westwood

Leber.

Plan produced using PlanUp.





Registered Address: Unit 3 The Brookfield Centre, Cheshunt, Herts, EN8 0NN Company Registration Number: OC414280 | VAT Number: 276958046©2022 Paul Wallace Group LLP trading as Paul Wallace Estate Agents



Paul Wallace Estate Agents

70 High Street
Hoddesdon
Hertfordshire
EN11 8ET



01992 466471



hoddesdon@paulwallace.co.uk



www.paulwallace.co.uk



Opening Times

Mon	9am to 6.30pm
Tues	9am to 6.30pm
Wed	9am to 6.30pm
Thurs	9am to 6.30pm
Fri	9am to 6.30pm
Sat	9am to 5.00pm
Sun	Closed



paulwallace
estate agents

Agents Note: Whilst every care has been taken to prepare these sales particulars, they are for guidance purposes only. All measurements are approximate and are for general guidance purposes only and whilst every care has been taken to ensure their accuracy, they should not be relied upon. Potential buyers are advised to recheck the measurements.