



 paulwallace

Oceanic House, Star Street, Ware, SG12 7AA |
£259,995 | Leasehold

Oceanic House, Star Street, Ware, SG12 7AA

Situated conveniently close to Ware railway station (0.3 miles), this superb one-bedroom apartment in the charming market town of Ware, Hertfordshire offers a prime location in the heart of the Town Centre. Boasting a range of amenities including shops, restaurants, and more, residents will enjoy the convenience of urban living in a picturesque setting. The property has been meticulously crafted to showcase a high standard of finish, with features such as a contemporary kitchen with high specifications, a stylish bathroom / w.c., gas central heating, and double glazed windows. The apartment offers excellent living space, ideal for those seeking comfort and functionality. Additionally, this property benefits from a long lease of 115+ years, ensuring peace of mind for the future. An allocated parking space adds to the convenience of city living in this bustling market town. With its ideal location and high-quality finish, this one-bedroom apartment in Ware presents a fantastic opportunity for those looking to reside in a vibrant town with easy access to transportation and amenities.

Key features

- Located within walking distance of Ware railway station (0.3 miles)
- Stylish bathroom / w.c.
- Double glazed windows
- Long 115+ year lease
- High specification contemporary kitchen
- Gas central heating
- Excellent living accommodation
- Allocated parking space



 paulwallace
estate agents

hoddesdon@paulwallace.co.uk

01992 466471





GROUND FLOOR
446 sq.ft. (41.4 sq.m.) approx.

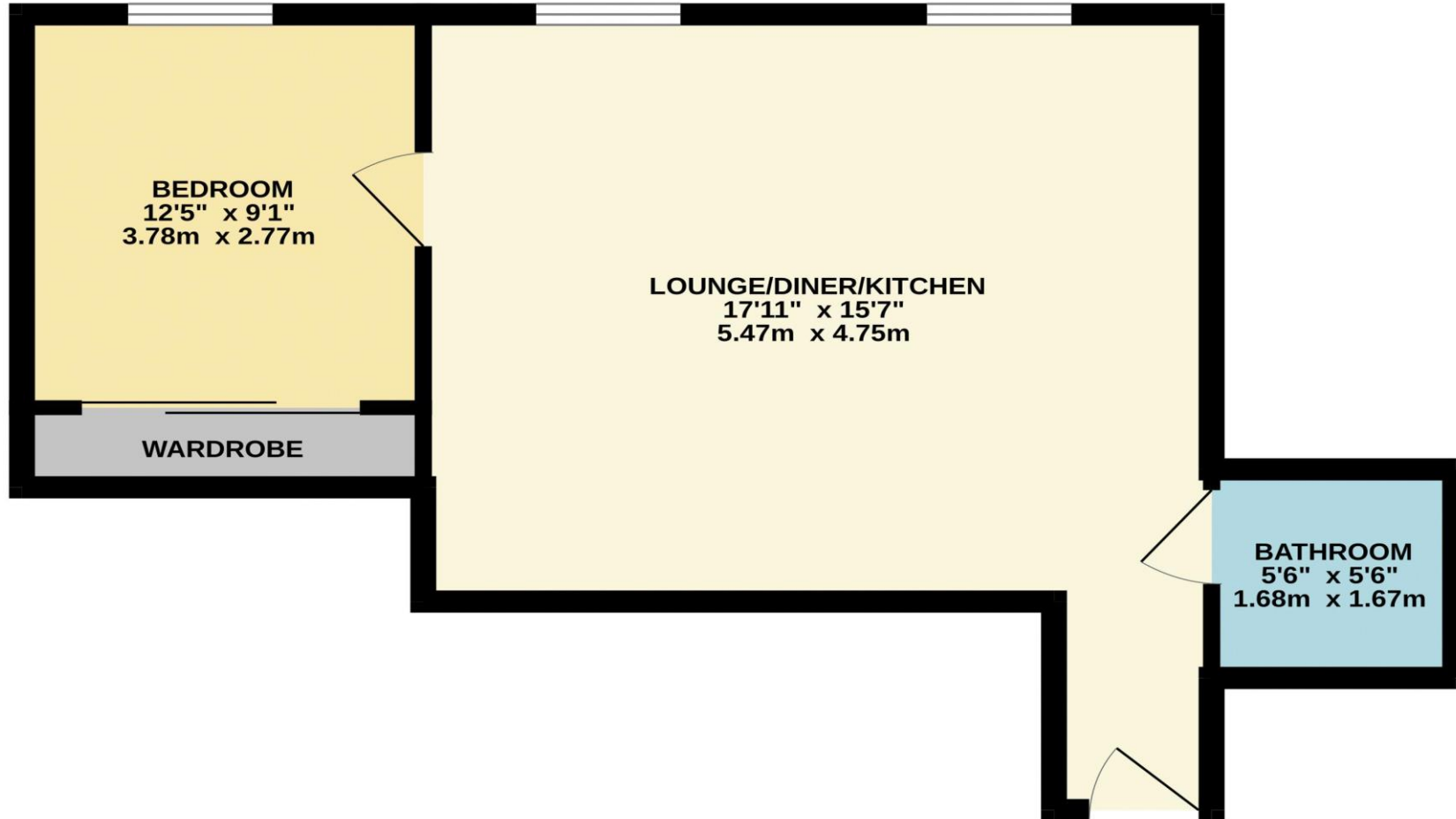

TOTAL FLOOR AREA : 446 sq.ft. (41.4 sq.m.) approx.

Whilst every attempt has been made to ensure the accuracy of the floorplan contained here, measurements of doors, windows, rooms and any other items are approximate and no responsibility is taken for any error, omission or mis-statement. This plan is for illustrative purposes only and should be used as such by any prospective purchaser. The services, systems and appliances shown have not been tested and no guarantee as to their operability or efficiency can be given.
Made with Metropix ©2024



Registered Address: Unit 3 The Brookfield Centre, Cheshunt, Herts, EN8 0NN Company Registration Number: OC414280 | VAT Number: 276958046©2022 Paul Wallace Group LLP trading as Paul Wallace Estate Agents



Paul Wallace Estate Agents

70 High Street
Hoddesdon
Hertfordshire
EN11 8ET

 01992 466471

 hoddesdon@paulwallace.co.uk

 www.paulwallace.co.uk



Opening Times

Mon	9am to 6.30pm
Tues	9am to 6.30pm
Wed	9am to 6.30pm
Thurs	9am to 6.30pm
Fri	9am to 6.30pm
Sat	9am to 5.00pm
Sun	Closed



Agents Note: Whilst every care has been taken to prepare these sales particulars, they are for guidance purposes only. All measurements are approximate and are for general guidance purposes only and whilst every care has been taken to ensure their accuracy, they should not be relied upon. Potential buyers are advised to recheck the measurements.