



The Knowle, Hoddesdon, EN11 8LD |  
£234,995 | Leasehold

 paulwallace

## The Knowle, Hoddesdon, EN11 8LD

Located on the top floor of this most desirable development, this immaculate one-bedroom apartment is conveniently situated within walking distance of Hoddesdon town centre. The property boasts a private southerly facing sun terrace, ideal for enjoying the sunshine and al fresco dining. With a 95-year lease in place, this apartment offers peace of mind for the future. The interior of the property is beautifully presented, with modern double glazed windows, a sleek and stylish kitchen, and a contemporary bathroom with W.C. The spacious bedroom provides ample storage space with access to loft space, while the open-plan living and dining room offers a comfortable and inviting space to relax and entertain.

### Key features

- Beautifully presented one bedroom top floor apartment
- 95-year lease
- Modern kitchen and bathroom/W.C.
- Open-plan living/dining room
- Private southerly facing sun terrace
- Double glazed windows and access to loft space
- Spacious bedroom
- Walking distance to Hoddesdon town centre

### Property Information

Tenure

Leasehold

Council Tax

C

EPC Rating

D

Local Authority



[hoddesdon@paulwallace.co.uk](mailto:hoddesdon@paulwallace.co.uk)

01992 466471







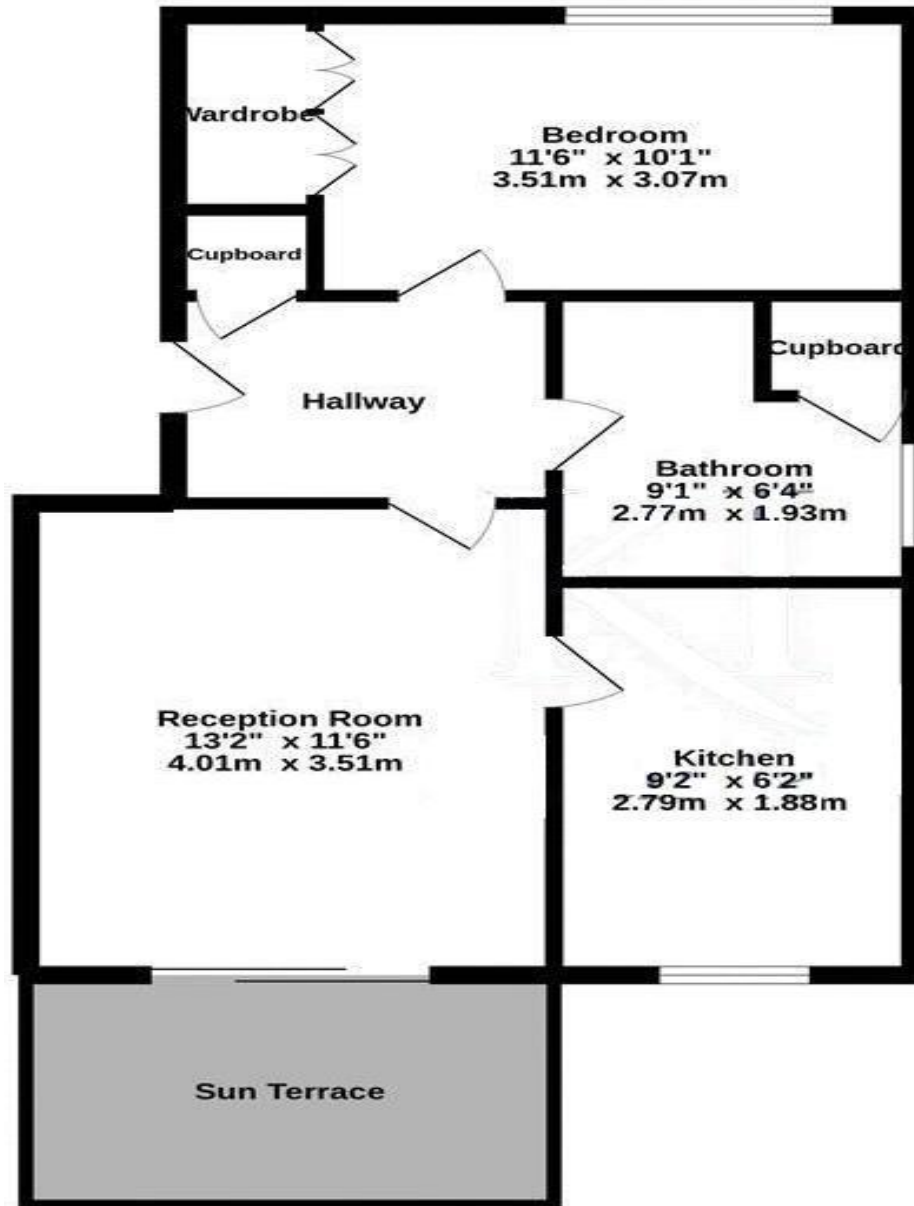





Registered Address: Unit 3 The Brookfield Centre, Cheshunt, Herts, EN8 0NN Company Registration Number: OC414280 | VAT Number: 276958046©2022 Paul Wallace Group LLP trading as Paul Wallace Estate Agents



### Paul Wallace Estate Agents

70 High Street  
Hoddesdon  
Hertfordshire  
EN11 8ET

 01992 466471

 [hoddesdon@paulwallace.co.uk](mailto:hoddesdon@paulwallace.co.uk)

 [www.paulwallace.co.uk](http://www.paulwallace.co.uk)



### Opening Times

Mon	9am to 6.30pm
Tues	9am to 6.30pm
Wed	9am to 6.30pm
Thurs	9am to 6.30pm
Fri	9am to 6.30pm
Sat	9am to 5.00pm
Sun	Closed



Agents Note: Whilst every care has been taken to prepare these sales particulars, they are for guidance purposes only. All measurements are approximate and are for general guidance purposes only and whilst every care has been taken to ensure their accuracy, they should not be relied upon. Potential buyers are advised to recheck the measurements.