



VILLAGE ESTATES

• EST.1993 •



93 Main Road, Sidcup, Kent DA14 6ND

Tel: 0208 302 1002

www.village-estates.com

Email: sidcup@village-estates.com



NO ONWARD CHAIN

GREAT SIZED BEDROOMS

**ALLCOATED PARKING AND
GARAGE**

CLOSE TO TOWN CENTRE

LARGE LIVING AREA

LONG LEASE



**3 Janson Court
16 Granville Road
Sidcup, DA14 4BX**

£325,000

Based just a short walk from Sidcup town centre is this spacious three bedroom apartment. This charming property offers three good sized bedrooms, with a well presented kitchen, bathroom and large living/ dining area. The home offers the benefit of allocated parking and garage, ensuring there is always a place to park, alongside its excellent transport links.

EPC RATING: C

COUNCIL TAX BAND: C

TENURE: Leasehold

LEASE TERM: 999 Years from 24 June 2014

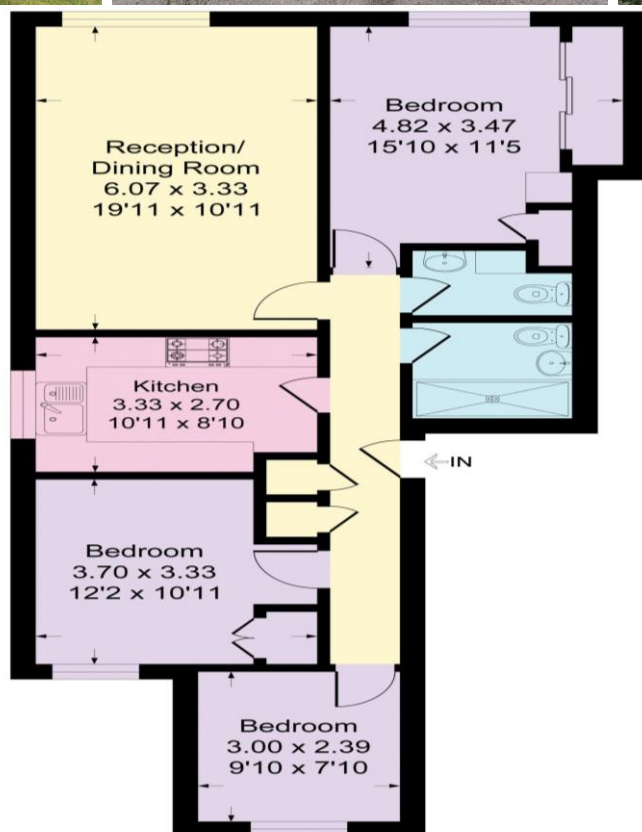

First Floor

CONSUMER PROTECTION FROM UNFAIR TRADING REGULATIONS 2008

Please note that any services, heating system or appliances have not been tested, and no warranty can be given or implied as to their working order. You are advised to obtain verification from your solicitor or surveyor. References to the tenure of a property are based on information supplied by the seller. We have not had sight of the title documents and a buyer is advised to obtain verification from their solicitor. Items shown in photographs are not included unless specifically mentioned within the sales particulars, but may be available by separate negotiation. Whilst every attempt has been made to ensure the accuracy of the floor plan contained here, measurements of doors, windows, rooms and any other items are approximate and no responsibility is taken for any error, omission, or mis-statement. We advise you to book an appointment to view before embarking on any journey to see a property, and check its availability. The accuracy of these details are not guaranteed and they do not form part of the contract.