



VILLAGE ESTATES

• EST.1993 •



93 Main Road, Sidcup, Kent DA14 6ND

Tel: 0208 302 1002

www.village-estates.com

Email: sidcup@village-estates.com



South Facing Balcony

Open Plan Living

0.5 Mile > Sidcup Mainline Stn

Parking To Rear

Modern Kitchen & Bathroom

Short Walk to High St Shops



Flat 4 Ashton Court

Clarence Rd, Sidcup, DA14 4DF

£375,000

Ashton Court, a plush two double bedroom first floor apartment with a large south facing balcony. Comprising of just 6 apartments this building gives a real sense of exclusivity, ideally positioned and detached from other nearby housing as well. We feel this would be an excellent opportunity to acquire a nearly new apartment, built circa 2019, offering modern design with wide hallways, open plan living, bath/shower room and next door to the stunning old school of Sidcup.

EPC RATING: B

COUNCIL TAX BAND: C

TENURE: Leasehold

LEASE TERM: 120 Years

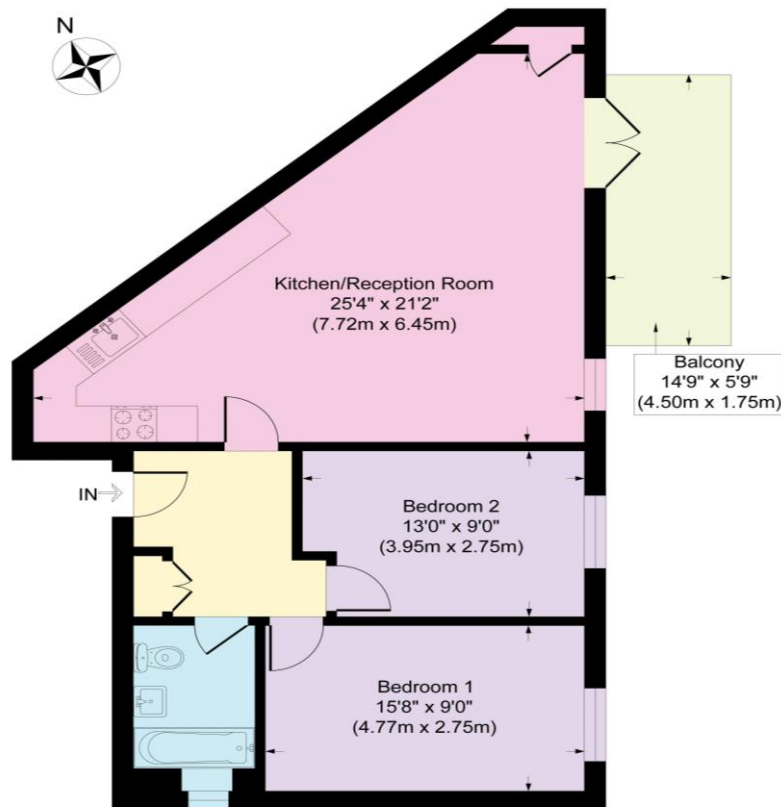

First Floor

CONSUMER PROTECTION FROM UNFAIR TRADING REGULATIONS 2008

Please note that any services, heating system or appliances have not been tested, and no warranty can be given or implied as to their working order. You are advised to obtain verification from your solicitor or surveyor. References to the tenure of a property are based on information supplied by the seller. We have not had sight of the title documents and a buyer is advised to obtain verification from their solicitor. Items shown in photographs are not included unless specifically mentioned within the sales particulars, but may be available by separate negotiation. Whilst every attempt has been made to ensure the accuracy of the floor plan contained here, measurements of doors, windows, rooms and any other items are approximate and no responsibility is taken for any error, omission, or mis-statement. We advise you to book an appointment to view before embarking on any journey to see a property, and check its availability. The accuracy of these details are not guaranteed and they do not form part of the contract.