



VILLAGE ESTATES



• EST.1993 •

93 Main Road, Sidcup, Kent DA14 6ND

Tel: 0208 302 1002

www.village-estates.com

Email: sidcup@village-estates.com



Underfloor Heating

Parking Available

Guest Suite

Close To Sidcup High Street

On Site Building Manager

Walk in Wardrobe



30 Kingswood Court

Sidcup Hill, DA14 6FH

£290,000

Kingswood Court is a development of plush apartments for people aged over 60 years old, built by McCarthy and Stone in 2015 with convenient access to SIDCUP HIGH STREET and local bus routes. Village Estates are pleased to present a ONE DOUBLE BEDROOM third floor apartment with PRIVATE BALCONY, a LIFT to all floors, a WALK IN WARDROBE, modern kitchen with integrated appliances and GATED PARKING.

EPC RATING: C

COUNCIL TAX BAND: C

TENURE: Leasehold

LEASE TERM: 990 Years



Kingswood Court

Approximate Gross Internal Area

Total = 55.2 sq m / 594 sq ft

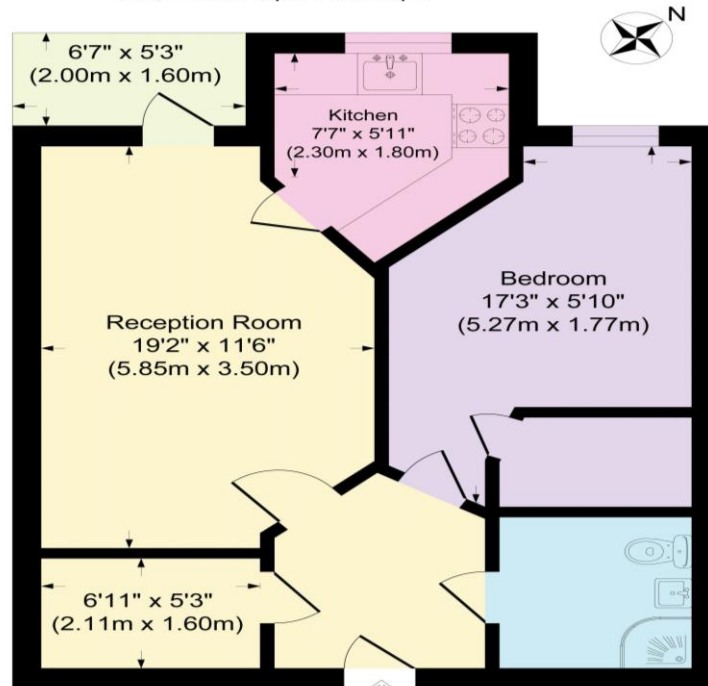

Third Floor

CONSUMER PROTECTION FROM UNFAIR TRADING REGULATIONS 2008

Please note that any services, heating system or appliances have not been tested, and no warranty can be given or implied as to their working order. You are advised to obtain verification from your solicitor or surveyor. References to the tenure of a property are based on information supplied by the seller. We have not had sight of the title documents and a buyer is advised to obtain verification from their solicitor. Items shown in photographs are not included unless specifically mentioned within the sales particulars, but may be available by separate negotiation. Whilst every attempt has been made to ensure the accuracy of the floor plan contained here, measurements of doors, windows, rooms and any other items are approximate and no responsibility is taken for any error, omission, or mis-statement. We advise you to book an appointment to view before embarking on any journey to see a property, and check its availability. The accuracy of these details are not guaranteed and they do not form part of the contract.