



VILLAGE ESTATES



• EST.1993 •

93 Main Road, Sidcup, Kent DA14 6ND

Tel: 0208 302 1002

www.village-estates.com

Email: sidcup@village-estates.com



**MODERNISED AND WELL
PRESENTED THROUGHOUT**

TWO BATHROOMS

**EXCELLENT SCHOOL
CATCHMENT**

FIVE BEDROOMS

**SHORT WALK TO NEW ELTHAM
STATION (ZONE 4)**

CLOSE TO AMENITIES



29 Gerda Road
London, SE9 3SW

£700,000

Village Estates are delighted to offer this MODERNISED and FULLY EXTENDED five bedroom, two bathroom Edwardian home situated close to amenities & easy reach of main line station (ZONE 4). Benefiting from a through lounge plus a modern and spacious 21ft KITCHEN BREAKFAST ROOM with Bi-folding doors onto landscaped garden. Your internal viewing is highly recommended to avoid disappointment.

EPC RATING: C

COUNCIL TAX BAND: D

TENURE: Freehold

LEASE TERM: Not Applicable

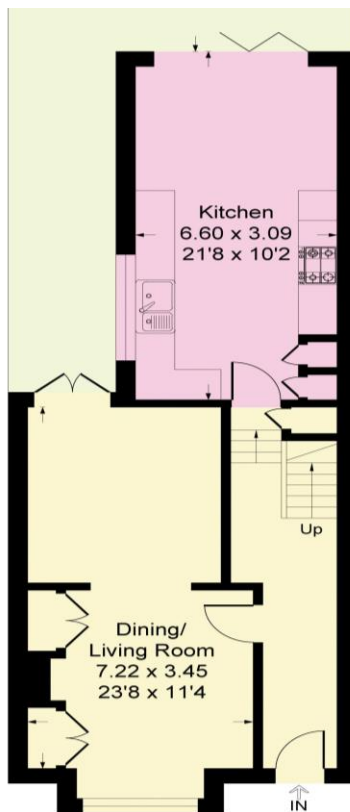

Ground Floor



First Floor

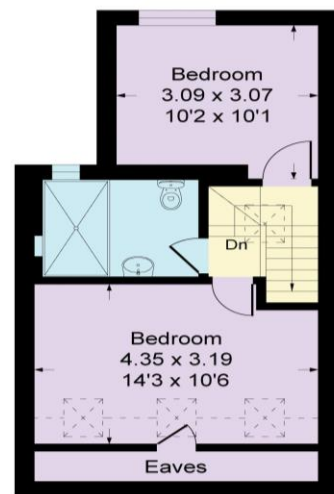

Second Floor

CONSUMER PROTECTION FROM UNFAIR TRADING REGULATIONS 2008

Please note that any services, heating system or appliances have not been tested, and no warranty can be given or implied as to their working order. You are advised to obtain verification from your solicitor or surveyor. References to the tenure of a property are based on information supplied by the seller. We have not had sight of the title documents and a buyer is advised to obtain verification from their solicitor. Items shown in photographs are not included unless specifically mentioned within the sales particulars, but may be available by separate negotiation. Whilst every attempt has been made to ensure the accuracy of the floor plan contained here, measurements of doors, windows, rooms and any other items are approximate and no responsibility is taken for any error, omission, or mis-statement. We advise you to book an appointment to view before embarking on any journey to see a property, and check its availability. The accuracy of these details are not guaranteed and they do not form part of the contract.