



VILLAGE ESTATES



• EST.1993 •

93 Main Road, Sidcup, Kent DA14 6ND

Tel: 0208 302 1002

www.village-estates.com

Email: sidcup@village-estates.com



DAYS LANE PRIMARY SCHOOL
'THE OVAL' PARADE OF SHOPS
METICULOUSLY MAINTAINED

WILLERSLEY PARK
OFF ROAD PARKING
GARAGE WITH REAR ACCESS



185 Days Lane
Sidcup, DA15 8JT

Guide Price £450,000-£465,000

Three-bedroom house nestled in a sought-after location within a short stroll of Days Lane and Our Lady of the Rosary primary schools. This property presents an ideal setting for young families, boasting proximity to local shops, parks, and excellent transport links. Inspired with a captivating bohemian charm, this home has been lovingly maintained and tastefully decorated by its current homeowners.

EPC RATING: D

COUNCIL TAX BAND: D

TENURE: Freehold

LEASE TERM: Not Applicable

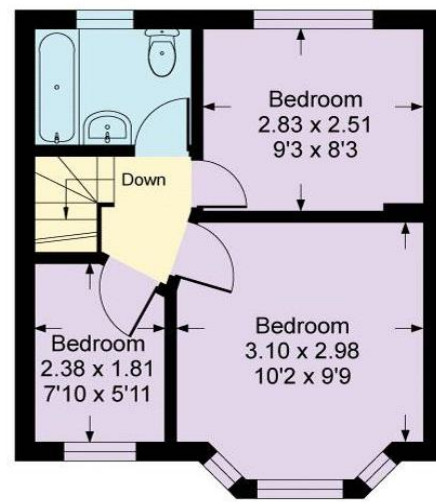
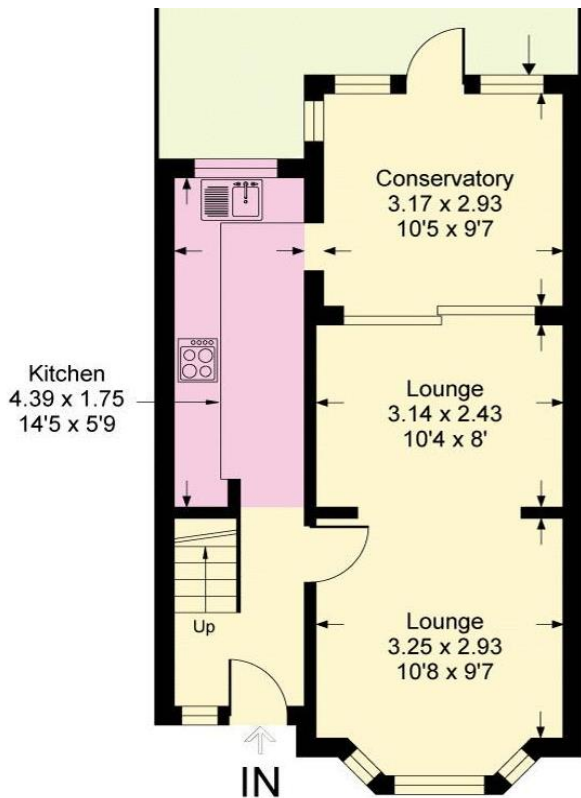

CONSUMER PROTECTION FROM UNFAIR TRADING REGULATIONS 2008

Please note that any services, heating system or appliances have not been tested, and no warranty can be given or implied as to their working order. You are advised to obtain verification from your solicitor or surveyor. References to the tenure of a property are based on information supplied by the seller. We have not had sight of the title documents and a buyer is advised to obtain verification from their solicitor. Items shown in photographs are not included unless specifically mentioned within the sales particulars, but may be available by separate negotiation. Whilst every attempt has been made to ensure the accuracy of the floor plan contained here, measurements of doors, windows, rooms and any other items are approximate and no responsibility is taken for any error, omission, or mis-statement. We advise you to book an appointment to view before embarking on any journey to see a property, and check its availability. The accuracy of these details are not guaranteed and they do not form part of the contract.