



## 14 Brome Way, Carterton OX18 1JS

Distances - Witney, Market Square c. 6.1 miles / Oxford c. 16.4 miles / Hanborough Train Station c. 11.7 miles

Forming part of a terrace and pleasantly situated overlooking an area of green, a 3 bedroom house with a good size garden and a garage, which is found to the rear. The spacious accommodation benefits from both gas central heating and double glazing and features a useful downstairs cloakroom, living room, dining room and a kitchen. All the bedrooms have built-in wardrobes and, in addition to the family bathroom, the master bedroom boasts an ensuite shower room. The property is conveniently placed for access to local amenities and is within easy striking distance of the A40 to Witney, Oxford, Burford and Cheltenham.

THOMAS  
MERRIFIELD

SALES LETTINGS

e. [witney@thomasmerrifield.co.uk](mailto:witney@thomasmerrifield.co.uk)

t. 01993 772000

Price £335,000

[www.thomasmerrifield.co.uk](http://www.thomasmerrifield.co.uk)





## 14 Brome Way, Carterton, Oxfordshire OX18 1JS

- Entrance Hall
- Cloakroom
- Living Room
- Dining Room
- Kitchen
- 3 Good Size Bedrooms
- Ensuite & Family Bathroom
- Garage & Westerly Facing Garden
- Overlooks Green Area To Front
- Conveniently Placed For Amenities

### Directions

Enter Carterton from Minster Lovell (B4477) and proceed over the roundabout (second exit). Take the next right into Bluebell Way and follow this road until eventually turning left into Orchid Way. Continue to the end and turn left (on foot) and then proceed until you reach an area with established grass and shrubs. Number 14 is found on the left hand side, marked by a Thomas Merrifield For Sale Board. All mains services. Ultrafast broadband available. Mobile & data: EE- performance 86% (source: Ofcom). 02L25

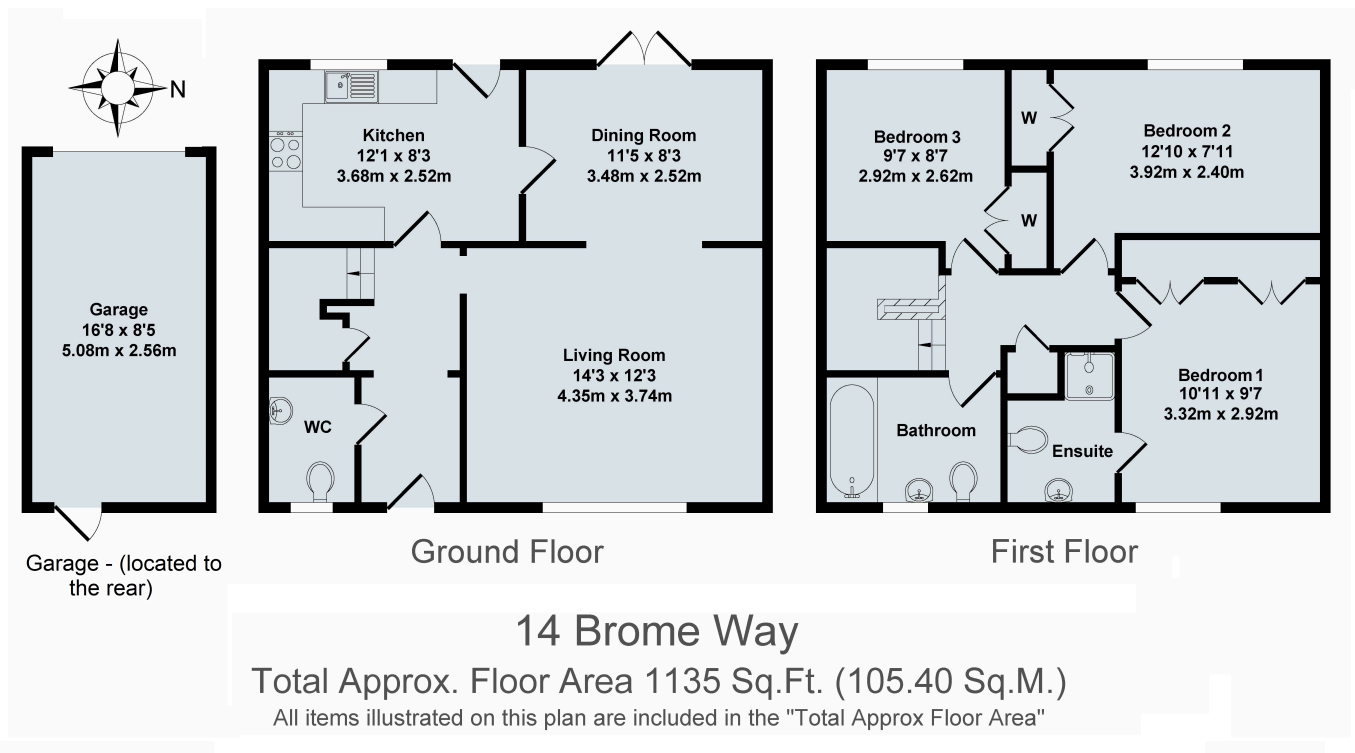

### Local Authority:

WODC Tax Band D / EPC Rating: 70/C

### Contact:

52 Market Square, Witney,  
Oxfordshire, OX28 6AF

### Tenure:

Freehold

Tel: 01993 772000

Email: [witney@thomasmerrifield.co.uk](mailto:witney@thomasmerrifield.co.uk)

### Important Notice

Thomas Merrifield for themselves and their clients give notice that:-

1. They are not authorised to make or give representation or warranty in relation to this property, either on their own behalf or on behalf of the Seller. They assume no responsibility for any statement made in these particulars. These particulars do not form part of any offer or contract and must not be relied upon as statements or representations of fact.
2. Whilst every attempt has been made to ensure the accuracy of the floorplan contained here, measurements of doors, windows, rooms and any other items are approximate and no responsibility is taken for any error, omission, or mis-statement.
3. All areas, measurements or distances are approximate. The particulars are intended for guidance only and are not necessarily comprehensive. A wide angle lens may have been used in photography. Thomas Merrifield have not tested appliances or services and it should not be assumed that the property has all necessary planning, building regulation and other consents. Buyers must satisfy themselves with the property by inspection or otherwise.
4. Reference to any mechanical or electrical equipment does not constitute a representation that such equipment is capable of fulfilling its function and prospective Buyers must make their own enquiries.
5. They have no responsibility for any expenses or costs incurred by prospective Buyers in inspecting properties which have been sold, let or withdrawn. Applicants are advised to contact the Agent to check availability and any other information of particular importance to them, prior to inspecting the property, particularly if travelling some distance.