



## 24 Compton Way, Witney OX28 3AB

A very well presented 3 bedroom end terrace house, situated on this small and sought after location within a short walk to the town centre. The property is presented in excellent condition and offers attractive accommodation plus a garage, driveway and a private south-west facing rear garden. The ground floor includes a hall, cloakroom, living room and fitted kitchen/dining room. To the first floor there are 3 bedrooms and a bathroom. There is gas central heating, and double glazing finished in a mushroom colour. This is a delightful home, improved by the present owners to a high standard, and with quality fittings.

**THOMAS  
MERRIFIELD**

SALES LETTINGS

e. [witney@thomasmerrifield.co.uk](mailto:witney@thomasmerrifield.co.uk)

t. 01993 772000

**Price £410,000**

[www.thomasmerrifield.co.uk](http://www.thomasmerrifield.co.uk)





## 24 Compton Way, Witney, Oxfordshire OX28 3AB

- Entrance Hall
- Cloakroom
- Living Room
- Kitchen/Dining Room
- 3 Bedrooms
- Bathroom
- Double Glazing
- Gas Central Heating
- South-West Facing Garden
- Garage & Driveway

All mains services are connected.

Info from Ofcom:

Mobile phone coverage:

Outdoor coverage is likely with EE, Vodafone, O2 & Three

Broadband: Ultrafast is available

Flood risk:

From rivers & sea - very low

From surface water - very low

## 24 Compton Way, Witney

Total Approx. Floor Area 936 Sq.Ft. (87.0 Sq.M.)

All items illustrated on this plan are included in the "Total Approx Floor Area"

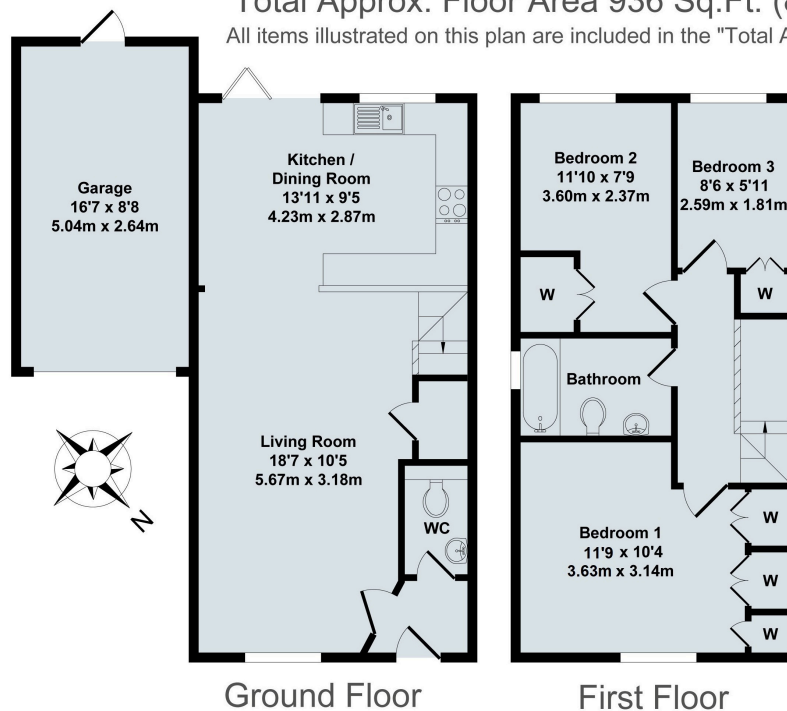

### Local Authority:

WODC Tax Band C / EPC Rating: 70/C

### Contact:

52 Market Square, Witney,  
Oxfordshire, OX28 6AF

### Tenure:

Freehold

Tel: 01993 772000

Email: [witney@thomasmerrifield.co.uk](mailto:witney@thomasmerrifield.co.uk)

### Important Notice

Thomas Merrifield for themselves and their clients give notice that:-

1. They are not authorised to make or give representation or warranty in relation to this property, either on their own behalf or on behalf of the Seller. They assume no responsibility for any statement made in these particulars. These particulars do not form part of any offer or contract and must not be relied upon as statements or representations of fact.
2. Whilst every attempt has been made to ensure the accuracy of the floorplan contained here, measurements of doors, windows, rooms and any other items are approximate and no responsibility is taken for any error, omission, or mis- statement.
3. All areas, measurements or distances are approximate. The particulars are intended for guidance only and are not necessarily comprehensive. A wide angle lens may have been used in photography. Thomas Merrifield have not tested appliances or services and it should not be assumed that the property has all necessary planning, building regulation and other consents. Buyers must satisfy themselves with the property by inspection or otherwise.
4. Reference to any mechanical or electrical equipment does not constitute a representation that such equipment is capable of fulfilling its function and prospective Buyers must make their own enquiries.
5. They have no responsibility for any expenses or costs incurred by prospective Buyers in inspecting properties which have been sold, let or withdrawn. Applicants are advised to contact the Agent to check availability and any other information of particular importance to them, prior to inspecting the property, particularly if travelling some distance.