



Stepping Stones, 94 Lower End, Leaffield OX29 9QQ

Draft details - draft details may be subject to alterations. Distances - Witney, Market Square c.6.7 miles / Oxford c. 15.6 miles / Charlbury Train Station c. 4.3 miles

A well presented and nicely maintained, 3/4 bedroom detached, chalet-style house, occupying a favourable, non-estate position in this highly desirable village, a short drive from Charlbury rail station and within easy striking distance of the thriving market town of Witney. The accommodation benefits from both gas central heating and double glazing and features a study/4th bedroom, a sitting room with log burner, a living/dining room, kitchen and utility room. In addition to the ground floor bathroom, there is a first floor shower room. There is an attractive, well tended, southerly aspect garden to the rear and off-road parking to the front for up to 4 vehicles. All mains services. Ultrafast broadband available. Mobile & data: EE- 'limited' coverage.

THOMAS
MERRIFIELD

SALES LETTINGS

e. witney@thomasmerrifield.co.uk

t. 01993 772000

Price £550,000

www.thomasmerrifield.co.uk



Stepping Stones, 94 Lower End, Leaffield, Oxfordshire OX29 9QQ

- 2/3 Reception Rooms
- Kitchen & Utility Room
- 3/4 Bedrooms
- First Floor Shower Room
- Ground Floor Bathroom
- Double Glazing & Gas Central Heating
- Attractive Southerly Garden
- Parking For 3-4 Vehicles
- Favourable Non-Estate Position
- Desirable Village Location

Directions

Leave Witney via High Street and Bridge Street and turn left (first exit) at the double mini roundabouts onto West End. At the next mini roundabout turn right onto Hailey Road and continue through Hailey village. Upon reaching Finstock turn left at the crossroads and then continue on to Leaffield, where number 94 will be found on the left hand side, marked by a Thomas Merrifield For Sale Board. 09E25

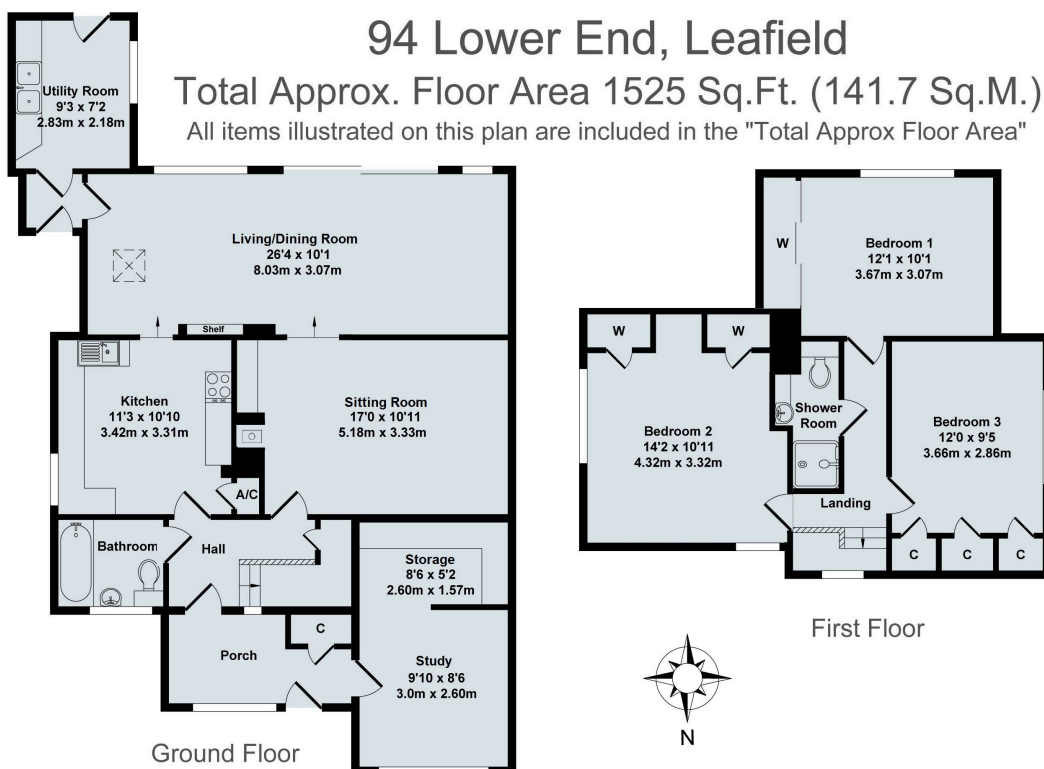

Local Authority:

WODC Tax Band D / EPC Rating: 62/D

Contact:

52 Market Square, Witney,
Oxfordshire, OX28 6AF

Tenure:

Freehold

Tel: 01993 772000

Email: witney@thomasmerrifield.co.uk

Important Notice

Thomas Merrifield for themselves and their clients give notice that:-

1. They are not authorised to make or give representation or warranty in relation to this property, either on their own behalf or on behalf of the Seller. They assume no responsibility for any statement made in these particulars. These particulars do not form part of any offer or contract and must not be relied upon as statements or representations of fact.

2. Whilst every attempt has been made to ensure the accuracy of the floorplan contained here, measurements of doors, windows, rooms and any other items are approximate and no responsibility is taken for any error, omission, or mis-statement.

3. All areas, measurements or distances are approximate. The particulars are intended for guidance only and are not necessarily comprehensive. A wide angle lens may have been used in photography. Thomas Merrifield have not tested appliances or services and it should not be assumed that the property has all necessary planning, building regulation and other consents. Buyers must satisfy themselves with the property by inspection or otherwise.

4. Reference to any mechanical or electrical equipment does not constitute a representation that such equipment is capable of fulfilling its function and prospective Buyers must make their own enquiries.

5. They have no responsibility for any expenses or costs incurred by prospective Buyers in inspecting properties which have been sold, let or withdrawn. Applicants are advised to contact the Agent to check availability and any other information of particular importance to them, prior to inspecting the property, particularly if travelling some distance.