



## 29 Fieldmere Close, Witney, Oxfordshire OX28 5DA

Distances - Witney Market Square c. 1.2 miles / Oxford c. 13.2 miles / Hanborough Rail Station c. 6.9 miles

Offered 'For Sale' with NO ONWARD CHAIN and well placed for schools and other local amenities, a 3 bedroom house, forming part of a staggered terrace. The accommodation benefits from double glazing and features a useful downstairs cloakroom, kitchen, living/ dining room, a rear porch and a first floor shower room. Gardens are found to both front and rear. EPC Rating: 29/F.

**THOMAS  
MERRIFIELD**

SALES LETTINGS

e. [witney@thomasmerrifield.co.uk](mailto:witney@thomasmerrifield.co.uk)

t. 01993 772000

**Offers in Excess of £300,000**

[www.thomasmerrifield.co.uk](http://www.thomasmerrifield.co.uk)





## 29 Fieldmere Close, Witney, Oxfordshire OX28 5DA

- Downstairs Cloakroom
- Kitchen
- Living/Dining Room
- Rear Porch
- Three Bedrooms
- First Floor Shower Room
- Double Glazing
- Well Placed for Amenities
- Front and Rear Garden
- NO ONWARD CHAIN

### Directions

Leave Witney Market Square, heading West along Corn Street and take the 2nd exit at the roundabout onto Curbridge Road. Turn right into Mirfield Road and bear almost immediately right again, also Mirfield Road. Take the 2nd right turn into Fieldmere Close and number 29 is found on the right hand side, marked by a Thomas Merrifield For Sale board.

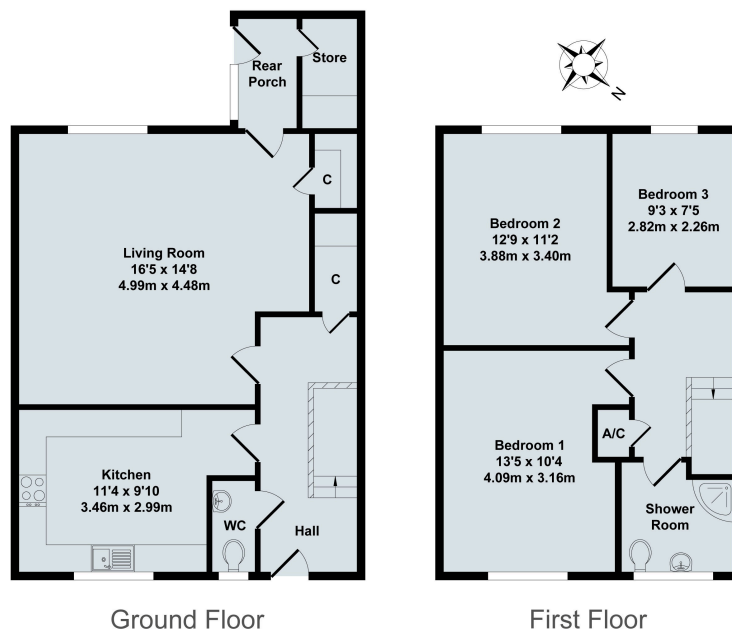

### 29 Fieldmere Close

Total Approx. Floor Area 1059 Sq.Ft. (98.40 Sq.M.)

All items illustrated on this plan are included in the "Total Approx Floor Area"

### Local Authority:

WODC Council Tax Band: C  
Current EPC Rating: 29/F

### Contact:

52 Market Square, Witney,  
Oxfordshire, OX28 6AF

### Tenure:

Freehold

Tel: 01993 772000

Email: [witney@thomasmerrifield.co.uk](mailto:witney@thomasmerrifield.co.uk)

### Important Notice

Thomas Merrifield for themselves and their clients give notice that:-

1. They are not authorised to make or give representation or warranty in relation to this property, either on their own behalf or on behalf of the Seller. They assume no responsibility for any statement made in these particulars. These particulars do not form part of any offer or contract and must not be relied upon as statements or representations of fact.
2. Whilst every attempt has been made to ensure the accuracy of the floorplan contained here, measurements of doors, windows, rooms and any other items are approximate and no responsibility is taken for any error, omission, or mis- statement.
3. All areas, measurements or distances are approximate. The particulars are intended for guidance only and are not necessarily comprehensive. A wide angle lens may have been used in photography. Thomas Merrifield have not tested appliances or services and it should not be assumed that the property has all necessary planning, building regulation and other consents. Buyers must satisfy themselves with the property by inspection or otherwise.
4. Reference to any mechanical or electrical equipment does not constitute a representation that such equipment is capable of fulfilling its function and prospective Buyers must make their own enquiries.
5. They have no responsibility for any expenses or costs incurred by prospective Buyers in inspecting properties which have been sold, let or withdrawn. Applicants are advised to contact the Agent to check availability and any other information of particular importance to them, prior to inspecting the property, particularly if travelling some distance.