



The Cottage, New Yatt Lane, New Yatt, Oxfordshire OX29 6TF

Draft details - may be subject to alterations.

A 19th century semi-detached stone cottage, situated in this peaceful village of New Yatt, just 2 miles from Witney. The property is set in a large garden that extends to the front, providing a lawn and paved areas, together with driveway parking, a garage to the side, and further space to the side and rear. The cottage has accommodation to include a living/dining room, kitchen, and a ground floor bathroom, plus 2 bedrooms on the first floor. There is opportunity to extend the cottage or create a small building plot to the front, both would be subject to planning consents. NO ONWARD CHAIN.

THOMAS
MERRIFIELD

SALES LETTINGS

e. witney@thomasmerrifield.co.uk

Offers In The Region Of £390,000

t. 01993 772000

www.thomasmerrifield.co.uk



The Cottage, New Yatt Lane, New Yatt, Oxfordshire OX29 6TF

- Conservatory
- Living/Dining Room
- Kitchen
- Ground Floor Bathroom
- 2 First Floor Bedrooms
- Garage & Driveway Parking
- Garden Shed and Greenhouse
- Large Front Garden
- Potential To Extend & Improve
- Oil Central Heating

Services connected are electric, water and drainage.

Broadband: Ultrafast is available

Mobile:

Outdoor is likely for EE Three 02 and Vodafone

Indoor is limited for EE, O2, and Vodafone.

13E25

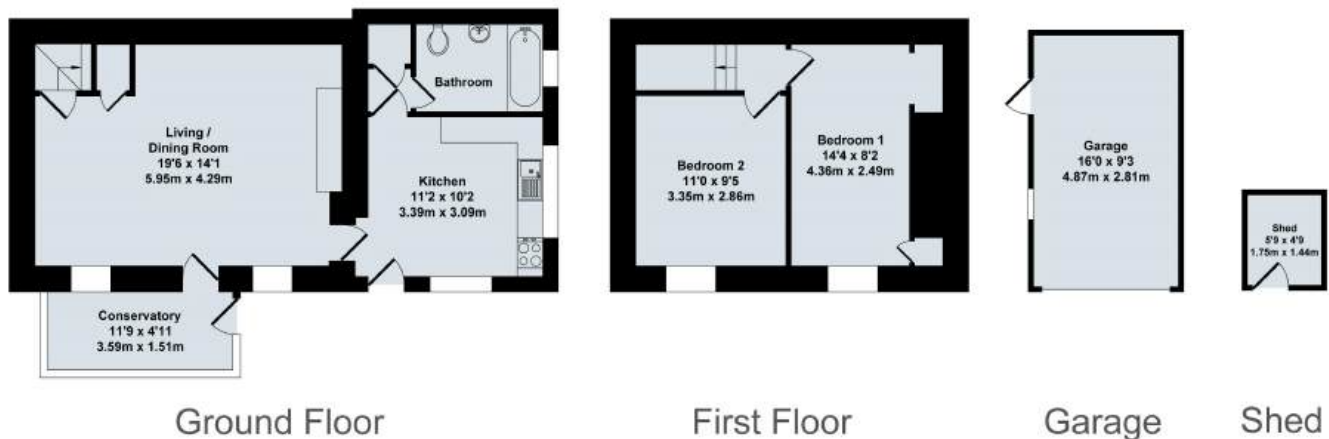

The Cottage New Yatt, Witney

Total Approx. Floor Area 1003 Sq.Ft. (93.20 Sq.M.)

All items illustrated on this plan are included in the "Total Approx Floor Area"

Local Authority:

WODC Tax Band C / EPC Rating: 23/F

Contact:

52 Market Square, Witney,
Oxfordshire, OX28 6AF

Tenure:

Freehold

Tel: 01993 772000

Email: witney@thomasmerrifield.co.uk

Important Notice

Thomas Merrifield for themselves and their clients give notice that:-

1. They are not authorised to make or give representation or warranty in relation to this property, either on their own behalf or on behalf of the Seller. They assume no responsibility for any statement made in these particulars. These particulars do not form part of any offer or contract and must not be relied upon as statements or representations of fact.
2. Whilst every attempt has been made to ensure the accuracy of the floorplan contained here, measurements of doors, windows, rooms and any other items are approximate and no responsibility is taken for any error, omission, or mis- statement.
3. All areas, measurements or distances are approximate. The particulars are intended for guidance only and are not necessarily comprehensive. A wide angle lens may have been used in photography. Thomas Merrifield have not tested appliances or services and it should not be assumed that the property has all necessary planning, building regulation and other consents. Buyers must satisfy themselves with the property by inspection or otherwise.
4. Reference to any mechanical or electrical equipment does not constitute a representation that such equipment is capable of fulfilling its function and prospective Buyers must make their own enquiries.
5. They have no responsibility for any expenses or costs incurred by prospective Buyers in inspecting properties which have been sold, let or withdrawn. Applicants are advised to contact the Agent to check availability and any other information of particular importance to them, prior to inspecting the property, particularly if travelling some distance.