



Old Stables,
Oxford Hill, Witney, Oxfordshire OX29 6UT

Old Stables, Oxford Hill, Witney, Oxfordshire OX29 6UT

A 3 bedroom detached barn conversion, with character features throughout including exposed beams and a fireplace with a wood burner. The very spacious feel to the property includes an attractive entrance hall with stairs to the first floor, a large living/dining room with a fireplace and double doors to the garden, a kitchen/dining room, ground floor bedroom/study and a family bathroom, plus a useful utility and cloakroom. To the first floor there is a large landing leading to the 2 main bedrooms, both of which have their own ensuite shower rooms. Outside there is a garden area to the front and a large private rear garden which includes a recently constructed outbuilding that provides office space/guest room, and a storage shed. In addition there is parking space for 3 vehicles opposite the property with a right to park in those spaces.

Directions

From our office in Market Square, proceed along Langdale Gate, turning left at the roundabout onto Witan Way. Follow this road along to the traffic lights, turning right onto High Street. Continue straight over the roundabout onto Bridge Street. Turn right at the double mini roundabouts onto Newland and continue up Oxford Hill. Proceed straight ahead and over the brow of the Hill. The property is found on the left hand side.

Draft details - may be subject to alterations. 27C25





GROUND FLOOR

Large Entrance Hall

Living/Dining Room

Kitchen/Breakfast Room

Study/Bedroom 3

Bathroom

FIRST FLOOR

2 Bedrooms

2 Ensuites

Double Glazing

Gas Central Heating

OUTSIDE

Home Office & Storage Shed

Private Rear Garden

Parking Space For 3 Vehicles - with a right to park

Private Drainage



Price £595,000 Freehold
WODC Tax Band E / EPC Rating: 65/D

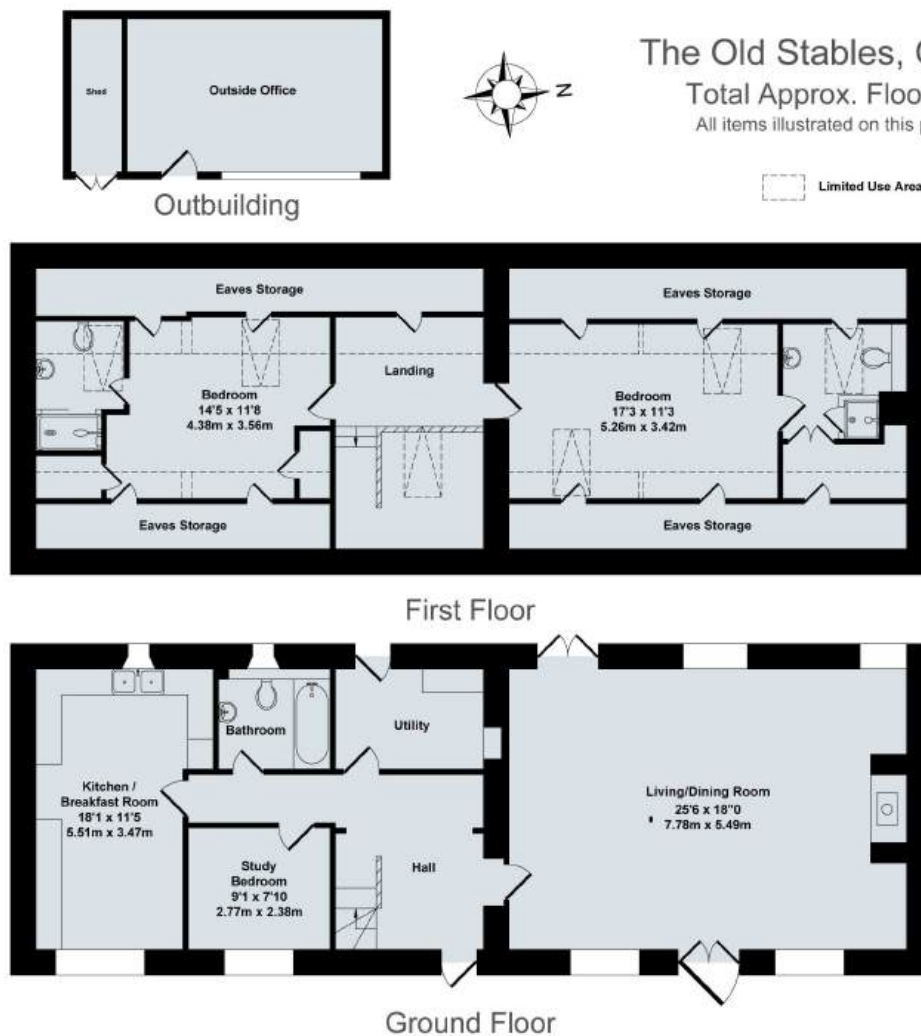

The Old Stables, Oxford Hill, Witney OX29 6UT

Total Approx. Floor Area 2134 Sq.Ft. (198.3 Sq.M.)

All items illustrated on this plan are included in the "Total Approx Floor Area"

Contact:

52 Market Square, Witney, Oxfordshire, OX28 6AF

Tel: 01993 772000 Email: witney@thomasmerrifield.co.uk

Importance Notice

Thomas Merrifield and their clients give notice that:

1. They are not authorised to make or give any representations or warranties in relation to the property either here or elsewhere, either on their own behalf or on behalf of their client or otherwise. They assume no responsibility for any statement that may be made in these particulars. These particulars do not form part of any offer or contract and must not be relied upon as statements or representations of fact.

2. Any areas, measurements or distances are approximate. The text, photographs and plans are for guidance only and are not necessarily comprehensive. It should not be assumed that the property has all necessary planning, building regulation or other consents and Thomas Merrifield have not tested any services, equipment or facilities. Purchasers must satisfy themselves by inspection or otherwise.