



3 Old Rectory Mews, Witney OX28 4AG

Draft details - may be subject to alterations.

A 1 bedroom single storey property for those over the age of 55, situated within walking distance of the town centre. Accommodation includes a hall, living room, kitchen, bedroom and a bathroom, together double glazing and electric heating. There is the added benefit of an area of outside space to the front and parking is available. This property is available for sale with no onward chain. Leasehold - 999 years from 1st November 2001. Current (2024) Service Charge £104.70 pcm. Current (2024) Ground Rent - zero.

THOMAS
MERRIFIELD

SALES LETTINGS

e. witney@thomasmerrifield.co.uk

t. 01993 772000

Price £200,000

www.thomasmerrifield.co.uk



3 Old Rectory Mews, Witney, Oxfordshire OX28 4AG

- Entrance Hall
- Living Room
- Kitchen
- Bedroom
- Shower Room
- Double Glazing
- Electric Heating
- Walking Distance Of The Town Centre
- No Onward Chain

Directions

Leave our office in Market Square and proceed along Corn Street. Turn left into The Crofts and second left into The Crofts (again). Turn left at the end and immediately right into Old Rectory Mews. The property is then found on the left hand side. 14J24

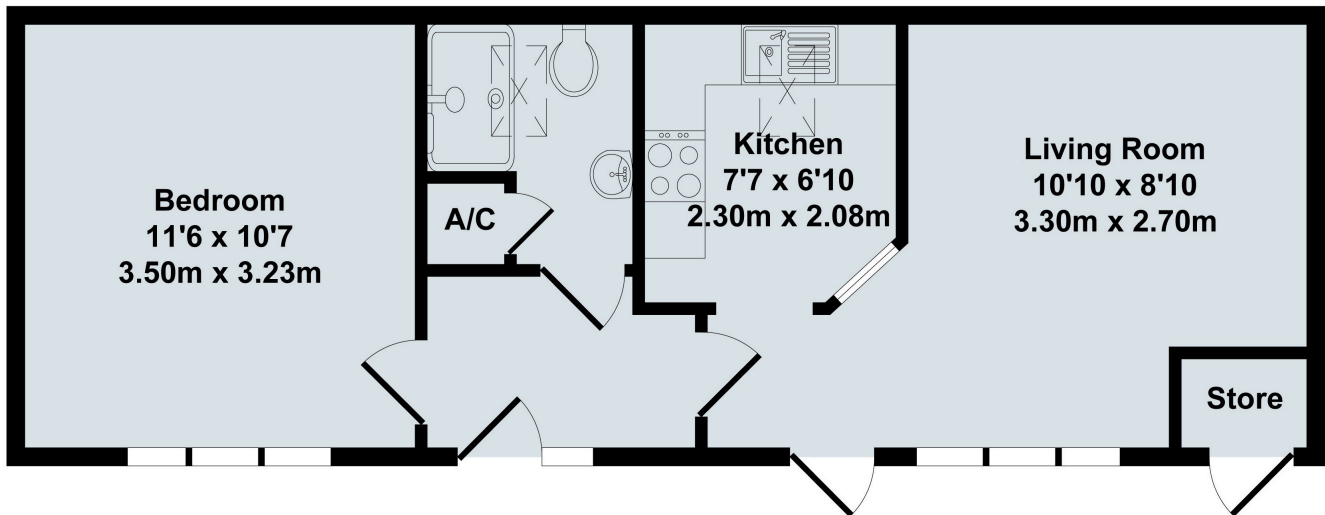

3 Old Rectory Mews

Total Approx. Floor Area 405 Sq.Ft. (37.6 Sq.M.)

All items illustrated on this plan are included in the "Total Approx Floor Area"



Local Authority:

WODC Band B / EPC Rating: 39/E

Contact:

52 Market Square, Witney,
Oxfordshire, OX28 6AF

Tenure:

Leasehold - 999 years from 1st Nov 2001. Current (2024) Service Charge £104.70 pcm. Current (2024) Ground Rent - zero.

Tel: 01993 772000

Email: witney@thomasmerrifield.co.uk

Important Notice

Thomas Merrifield for themselves and their clients give notice that:-

1. They are not authorised to make or give representation or warranty in relation to this property, either on their own behalf or on behalf of the Seller. They assume no responsibility for any statement made in these particulars. These particulars do not form part of any offer or contract and must not be relied upon as statements or representations of fact.
2. Whilst every attempt has been made to ensure the accuracy of the floorplan contained here, measurements of doors, windows, rooms and any other items are approximate and no responsibility is taken for any error, omission, or mis- statement.
3. All areas, measurements or distances are approximate. The particulars are intended for guidance only and are not necessarily comprehensive. A wide angle lens may have been used in photography. Thomas Merrifield have not tested appliances or services and it should not be assumed that the property has all necessary planning, building regulation and other consents. Buyers must satisfy themselves with the property by inspection or otherwise.
4. Reference to any mechanical or electrical equipment does not constitute a representation that such equipment is capable of fulfilling its function and prospective Buyers must make their own enquiries.
5. They have no responsibility for any expenses or costs incurred by prospective Buyers in inspecting properties which have been sold, let or withdrawn. Applicants are advised to contact the Agent to check availability and any other information of particular importance to them, prior to inspecting the property, particularly if travelling some distance.