



12 St. Mary's Mead, Witney OX28 4EZ

A 2 bedroom first floor apartment in this desirable retirement development in the centre of Witney. The property is extremely well presented and provides spacious and light accommodation, to include a hall, double aspect living/dining room and a kitchen with a breakfast area, together with an ensuite and main shower room. The development is for those over 55 and is beautifully maintained with landscaped gardens and 2 large ponds. There is a small shared patio area and allocated parking.

**THOMAS
MERRIFIELD**

SALES LETTINGS

e. witney@thomasmerrifield.co.uk

t. 01993 772000

Price £255,000

www.thomasmerrifield.co.uk



12 St. Mary's Mead, Witney, Oxfordshire OX28 4EZ

- Entrance Hall
- Living/Dining Room
- Kitchen/Breakfast Room
- 2 Double Bedrooms
- Ensuite & Main Shower Room
- Double Glazing & GCH
- Allocated Parking Space
- Shared Patio & Communal Gardens
- St. Mary's Mead Facilities
- Close To The Town Centre

From OFCOM:

Broadband: Ultrafast is available

Mobile:

Outdoor is Likely for O2, EE, Vodafone and Three

Indoor is Likely for EE, Limited for O2, Vodafone and Three.

10F25

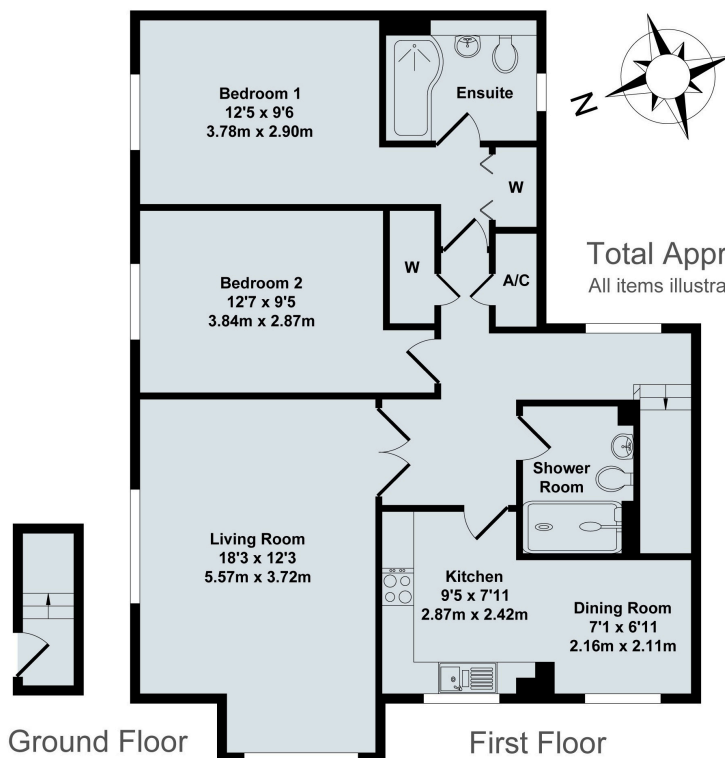

12 St. Marys Mead

Total Approx. Floor Area 908 Sq.Ft. (84.40 Sq.M.)

All items illustrated on this plan are included in the "Total Approx Floor Area"

Local Authority:

WODC Tax Band E / EPC Rating: 73/C

Contact:

52 Market Square, Witney,
Oxfordshire, OX28 6AF

Tenure:

Leasehold - 125 years from 1989. Current Annual (2024) Service Charge £3233.67. Current Annual (2024) Ground Rent £601.74.

Tel: 01993 772000

Email: witney@thomasmerrifield.co.uk

Important Notice

Thomas Merrifield for themselves and their clients give notice that:-

1. They are not authorised to make or give representation or warranty in relation to this property, either on their own behalf or on behalf of the Seller. They assume no responsibility for any statement made in these particulars. These particulars do not form part of any offer or contract and must not be relied upon as statements or representations of fact.
2. Whilst every attempt has been made to ensure the accuracy of the floorplan contained here, measurements of doors, windows, rooms and any other items are approximate and no responsibility is taken for any error, omission, or mis- statement.
3. All areas, measurements or distances are approximate. The particulars are intended for guidance only and are not necessarily comprehensive. A wide angle lens may have been used in photography. Thomas Merrifield have not tested appliances or services and it should not be assumed that the property has all necessary planning, building regulation and other consents. Buyers must satisfy themselves with the property by inspection or otherwise.
4. Reference to any mechanical or electrical equipment does not constitute a representation that such equipment is capable of fulfilling its function and prospective Buyers must make their own enquiries.
5. They have no responsibility for any expenses or costs incurred by prospective Buyers in inspecting properties which have been sold, let or withdrawn. Applicants are advised to contact the Agent to check availability and any other information of particular importance to them, prior to inspecting the property, particularly if travelling some distance.