



45 Priory Mill Lane, Witney OX28 1YG

Draft details - may be subject to alterations.

A 2 bedroom first floor shared ownership apartment with allocated parking, situated close to the town centre. The property is presented in excellent condition and includes an entrance hall, spacious and light living/dining/kitchen (with fitted appliances), 2 good size bedrooms and a shower room. This property is an excellent first time purchase. Current (2024) Monthly Service Charge: £69.54. Current (2024) Monthly Ground Rent: £8.33. Current (2024) monthly rent (for the remaining 50% share): £449.55.

**THOMAS
MERRIFIELD**

SALES LETTINGS

e. witney@thomasmerrifield.co.uk

Price £115,000 - for a 50% share

t. 01993 772000

www.thomasmerrifield.co.uk



45 Priory Mill Lane, Witney OX28 1YG

- Entrance Hall
- Living/Dining/Kitchen
- 2 Bedrooms
- Shower Room
- Double Glazing
- Electric Heating
- Allocated Parking
- Close To The Town Centre

Directions

From our office in Market Square, proceed along Langdale Gate. Turn left at the roundabout onto Witan Way and continue along. Turn right into New Bridge Street and proceed along, turning left at the end of the road into the square. The property is then found on the right hand side. 28E24

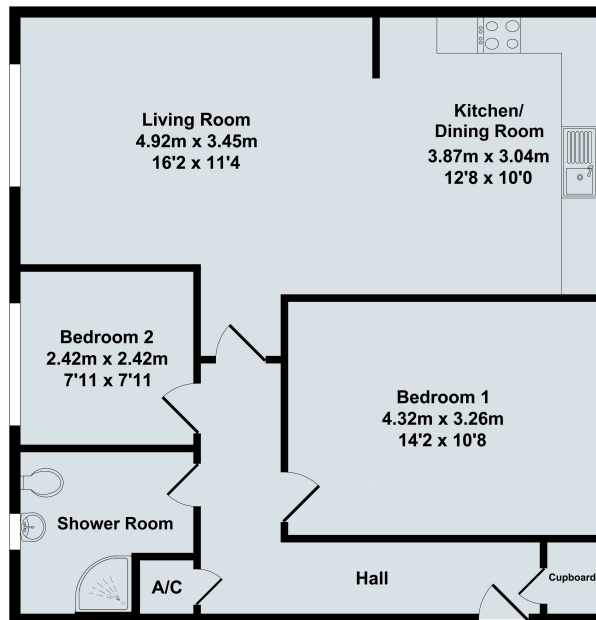

45 Priory Mill Lane, Witney, Oxon, OX28 1YG

Total Approx. Floor Area 65.40 Sq.M. (703 Sq.Ft.)

All items illustrated on this plan are included in the "Total Approx Floor Area"

Local Authority:

WODC Tax Band C / EPC Rating: 80/C.

Contact:

52 Market Square, Witney,
Oxfordshire, OX28 6AF

Tenure:

Leasehold

Tel: 01993 772000

Email: witney@thomasmerrifield.co.uk

Important Notice

Thomas Merrifield for themselves and their clients give notice that:-

1. They are not authorised to make or give representation or warranty in relation to this property, either on their own behalf or on behalf of the Seller. They assume no responsibility for any statement made in these particulars. These particulars do not form part of any offer or contract and must not be relied upon as statements or representations of fact.
2. Whilst every attempt has been made to ensure the accuracy of the floorplan contained here, measurements of doors, windows, rooms and any other items are approximate and no responsibility is taken for any error, omission, or mis- statement.
3. All areas, measurements or distances are approximate. The particulars are intended for guidance only and are not necessarily comprehensive. A wide angle lens may have been used in photography. Thomas Merrifield have not tested appliances or services and it should not be assumed that the property has all necessary planning, building regulation and other consents. Buyers must satisfy themselves with the property by inspection or otherwise.
4. Reference to any mechanical or electrical equipment does not constitute a representation that such equipment is capable of fulfilling its function and prospective Buyers must make their own enquiries.
5. They have no responsibility for any expenses or costs incurred by prospective Buyers in inspecting properties which have been sold, let or withdrawn. Applicants are advised to contact the Agent to check availability and any other information of particular importance to them, prior to inspecting the property, particularly if travelling some distance.