



157 Manor Road, Witney OX28 3UF

A 1 bedroom house situated on the popular Cogges development in Witney. The property has accommodation to include a living/dining room, kitchen, a good size bedroom, bathroom, double glazing and gas central heating, together with a private garden with a large outbuilding/shed and an open bike store. Cogges is well situated in Witney with good access to the town centre and has its own amenities including a Tesco Express. This is an excellent first time purchase or investment property.

**THOMAS
MERRIFIELD**

SALES LETTINGS

e. witney@thomasmerrifield.co.uk

Offers In The Region Of £215,000

t. 01993 772000

www.thomasmerrifield.co.uk



157 Manor Road, Witney OX28 3UF

- Living/Dining Room
- Kitchen
- Good Size Bedroom
- Bathroom
- Double Glazing
- Gas Central Heating
- Garden
- Parking Space
- Large Outbuilding/Shed
- Open Bike Store

Directions

From our office in Market Square proceed along Langdale Gate, turning left at the roundabout onto Witan Way. Follow this road along, turning right at the traffic lights onto High Street. Continue along and over the mini roundabouts onto Bridge Street. Turn right at the double mini roundabouts onto Newland and continue along to Oxford Hill. Turn right at the traffic lights onto Cogges Hill Road. Follow this road along, taking the fourth turning on the right into Manor Road. Continue along, taking the second turning on the left into Manor Road. Proceed along and the property is found on the left hand side. 22C24

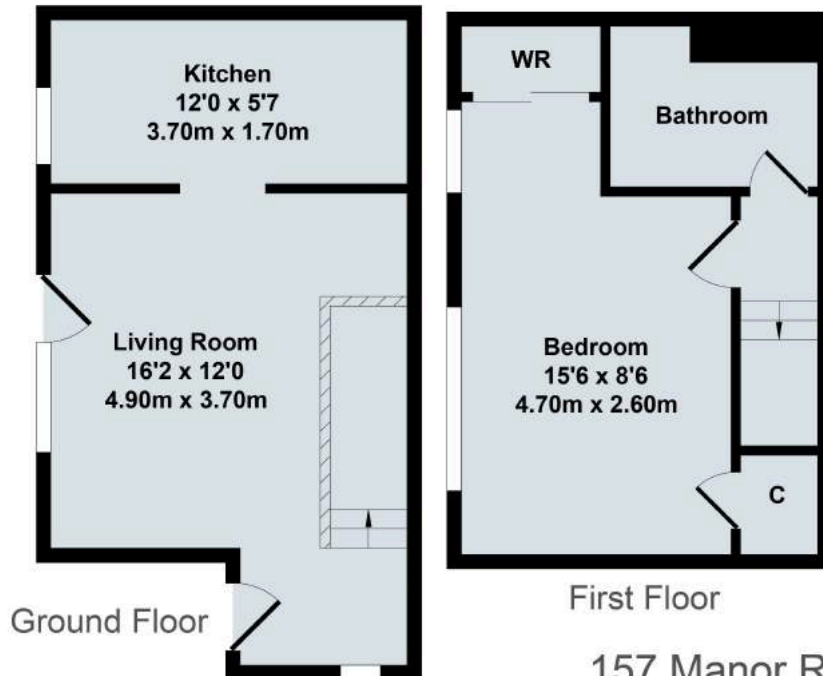

157 Manor Road, Witney

Total Approx. Floor Area 438 Sq.Ft. (40.70 Sq.M.)

All items illustrated on this plan are included in the "Total Approx Floor Area"

Local Authority:

WODC Band B / EPC Rating: 62/D

Contact:

52 Market Square, Witney,
Oxfordshire, OX28 6AF

Tenure:

Freehold

Tel: 01993 772000

Email: witney@thomasmerrifield.co.uk

Important Notice

Thomas Merrifield for themselves and their clients give notice that:-

1. They are not authorised to make or give representation or warranty in relation to this property, either on their own behalf or on behalf of the Seller. They assume no responsibility for any statement made in these particulars. These particulars do not form part of any offer or contract and must not be relied upon as statements or representations of fact.
2. Whilst every attempt has been made to ensure the accuracy of the floorplan contained here, measurements of doors, windows, rooms and any other items are approximate and no responsibility is taken for any error, omission, or mis-statement.
3. All areas, measurements or distances are approximate. The particulars are intended for guidance only and are not necessarily comprehensive. A wide angle lens may have been used in photography. Thomas Merrifield have not tested appliances or services and it should not be assumed that the property has all necessary planning, building regulation and other consents. Buyers must satisfy themselves with the property by inspection or otherwise.
4. Reference to any mechanical or electrical equipment does not constitute a representation that such equipment is capable of fulfilling its function and prospective Buyers must make their own enquiries.
5. They have no responsibility for any expenses or costs incurred by prospective Buyers in inspecting properties which have been sold, let or withdrawn. Applicants are advised to contact the Agent to check availability and any other information of particular importance to them, prior to inspecting the property, particularly if travelling some distance.