



16a Roosevelt Road, Long Hanborough OX29 8JG

A unique 2 bedroom end terrace house with parking and good size private gardens, situated in a quiet cul-de-sac position. The property was converted and created from an existing property and completed in 2009. It is well presented, offering a stylish design and layout to include a living room with a spiral staircase to the first floor, a kitchen/dining room, and a conservatory porch to the side; providing a useful addition to the ground floor living space, plus 2 bedrooms and bathroom. The gardens include a large shed, and mature shrubs and plants offering a degree of privacy, together with parking to the front with space for 2 vehicles. Double glazing and gas central heating complete the appeal of this lovely characterful home.

**THOMAS
MERRIFIELD**

SALES LETTINGS

e. witney@thomasmerrifield.co.uk

t. 01993 772000

Price £300,000

www.thomasmerrifield.co.uk



16a Roosevelt Road, Long Hanborough OX29 8JG

- Entrance Porch
- Living/Dining Room
- Kitchen
- Bathroom
- 2 Bedrooms
- Double Glazing
- Gas Central Heating
- Driveway Parking
- Garden

Directions

From Witney follow the A4095 along the Woodstock Road and away from Witney. Pass the villages of North Leigh and Freeland. On entering the village of Long Hanborough continue to the centre and turn right at the mini roundabout onto Church Road. Take the first left into Roosevelt Road and follow the road round to the left. The property is found in the left hand corner. 13E24

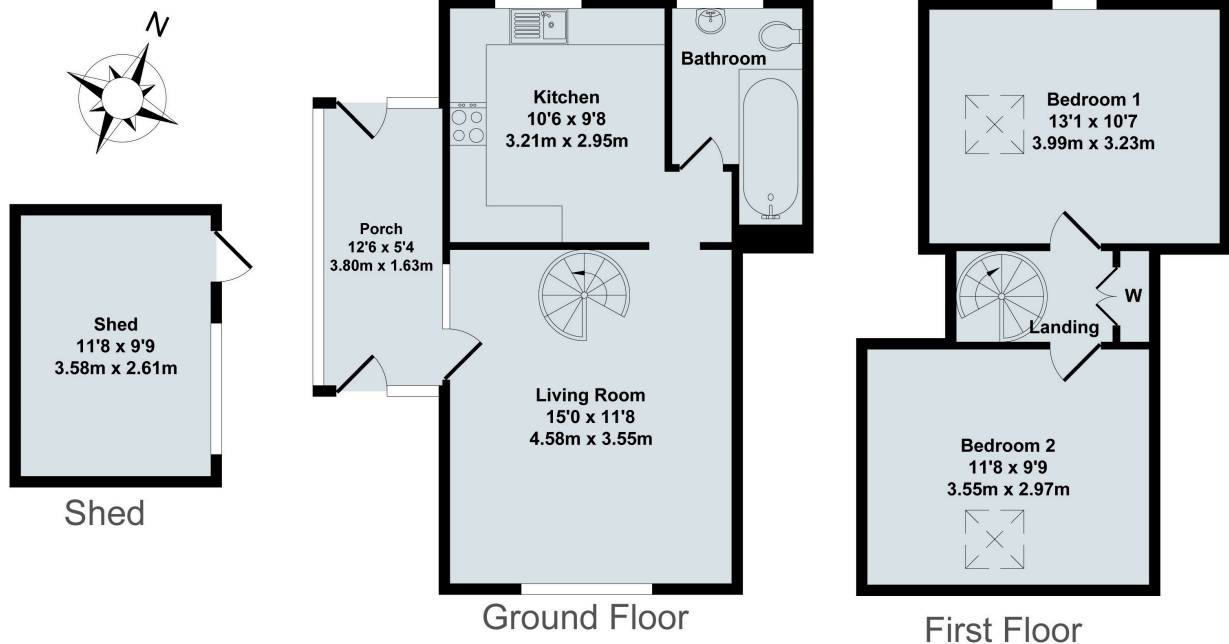

16A Roosevelt Road

Total Approx. Floor Area 847 Sq.Ft. (78.70 Sq.M.)

All items illustrated on this plan are included in the "Total Approx Floor Area"

Local Authority:

WODC Tax Band C / EPC Rating: 68/D

Contact:

52 Market Square, Witney,
Oxfordshire, OX28 6AF

Tenure:

Freehold

Tel: 01993 772000

Email: witney@thomasmerrifield.co.uk

Important Notice

Thomas Merrifield for themselves and their clients give notice that:-

1. They are not authorised to make or give representation or warranty in relation to this property, either on their own behalf or on behalf of the Seller. They assume no responsibility for any statement made in these particulars. These particulars do not form part of any offer or contract and must not be relied upon as statements or representations of fact.
2. Whilst every attempt has been made to ensure the accuracy of the floorplan contained here, measurements of doors, windows, rooms and any other items are approximate and no responsibility is taken for any error, omission, or mis- statement.
3. All areas, measurements or distances are approximate. The particulars are intended for guidance only and are not necessarily comprehensive. A wide angle lens may have been used in photography. Thomas Merrifield have not tested appliances or services and it should not be assumed that the property has all necessary planning, building regulation and other consents. Buyers must satisfy themselves with the property by inspection or otherwise.
4. Reference to any mechanical or electrical equipment does not constitute a representation that such equipment is capable of fulfilling its function and prospective Buyers must make their own enquiries.
5. They have no responsibility for any expenses or costs incurred by prospective Buyers in inspecting properties which have been sold, let or withdrawn. Applicants are advised to contact the Agent to check availability and any other information of particular importance to them, prior to inspecting the property, particularly if travelling some distance.