



34 Hanborough Close, Eynsham OX29 4NR

Draft details - may be subject to alterations. Distances - Witney, Market Square 6.2 miles / Oxford c. 5.9 miles / Hanborough Train Station c. 3.4 miles

A well presented 3 / 4 bedroom end of terrace house offering versatile accommodation including three reception rooms, a kitchen/ breakfast room and an additional ground floor room which could be used as either a family room or a fourth bedroom. There is both a ground floor shower room and a first floor bathroom. Gas C.H. double glazing, ample off-road parking, large garden.

**THOMAS
MERRIFIELD**

SALES LETTINGS

e. witney@thomasmerrifield.co.uk

t. 01993 772000

Price £425,000

www.thomasmerrifield.co.uk



34 Hanborough Close, Eynsham OX29 4NR

- 2 Reception Rooms
- Small Study
- Kitchen/Breakfast Room
- Family Room/Bedroom 4
- 3 Further Bedrooms
- Ground Floor Shower Room
- First Floor Bathroom
- Double Glazing & GCH
- Large Garden
- Ample Driveway Parking

Directions

Leave Witney and take the Easterly junction onto the A40. Continue for approx.4 miles and ignore the first turning on the right to Eynsham. At the roundabout take the third exit (right) onto the B4449 and then turn almost immediately right into Hanborough Road. After the left hand bend turn right into Hanborough Close. Continue on foot after number 30 (on the right, towards the garage block). 26C24

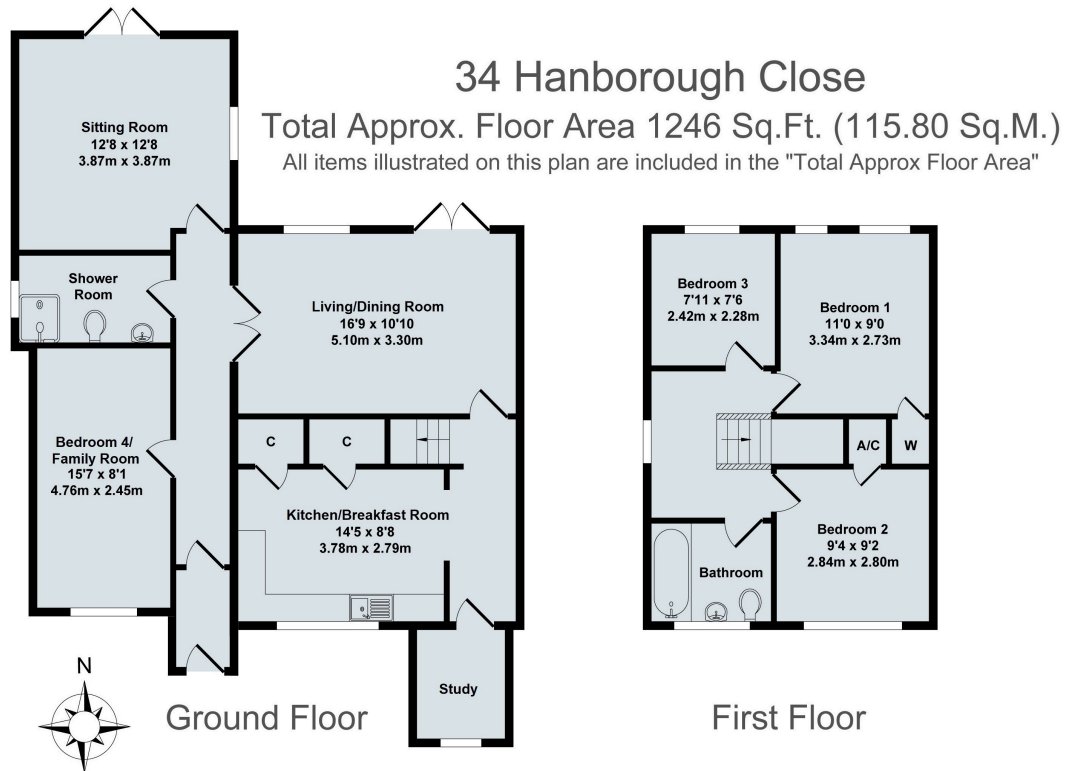

Local Authority:

WODC Band C / EPC Rating: 67/D

Contact:

52 Market Square, Witney,
Oxfordshire, OX28 6AF

Tenure:

Freehold

Tel: 01993 772000

Email: witney@thomasmerrifield.co.uk

Important Notice

Thomas Merrifield for themselves and their clients give notice that:-

1. They are not authorised to make or give representation or warranty in relation to this property, either on their own behalf or on behalf of the Seller. They assume no responsibility for any statement made in these particulars. These particulars do not form part of any offer or contract and must not be relied upon as statements or representations of fact.
2. Whilst every attempt has been made to ensure the accuracy of the floorplan contained here, measurements of doors, windows, rooms and any other items are approximate and no responsibility is taken for any error, omission, or mis- statement.
3. All areas, measurements or distances are approximate. The particulars are intended for guidance only and are not necessarily comprehensive. A wide angle lens may have been used in photography. Thomas Merrifield have not tested appliances or services and it should not be assumed that the property has all necessary planning, building regulation and other consents. Buyers must satisfy themselves with the property by inspection or otherwise.
4. Reference to any mechanical or electrical equipment does not constitute a representation that such equipment is capable of fulfilling its function and prospective Buyers must make their own enquiries.
5. They have no responsibility for any expenses or costs incurred by prospective Buyers in inspecting properties which have been sold, let or withdrawn. Applicants are advised to contact the Agent to check availability and any other information of particular importance to them, prior to inspecting the property, particularly if travelling some distance.