



13 Hill Crescent, Finstock OX7 3BT

Distances - Witney, Market Square c. 6 miles / Oxford c. 14.9 miles / Charlbury train Station c. 3.3 miles

A 3 bedroom end of terrace house, situated in this highly regarded village and offered For Sale with NO ONWARD CHAIN. The accommodation, which benefits from gas central heating, features a good size living/dining room and a conservatory, which has been added to the rear. There are gardens to both front and rear, the generous size frontage means that the property is set well back from the road.

**THOMAS
MERRIFIELD**

SALES LETTINGS

e. witney@thomasmerrifield.co.uk

t. 01993 772000

Price £259,950

www.thomasmerrifield.co.uk



13 Hill Crescent, Finstock OX7 3BT

- Entrance Hall
- Living Area
- Dining Area
- Conservatory
- Kitchen
- 3 Bedrooms
- Shower Room
- Gas Central Heating
- Good Size Frontage
- Courtyard Garden

Directions

Leave Witney via Hailey Road (B4022) and continue through the village of Hailey. Proceed for approximately 3 miles. Upon reaching Finstock, turn right at the crossroads into High Street. Continue to the bottom of the road and turn left. Take the next left into Hill Crescent and number 13 is found on the left hand side, marked by a Thomas Merrifield For Sale Board. 21C24

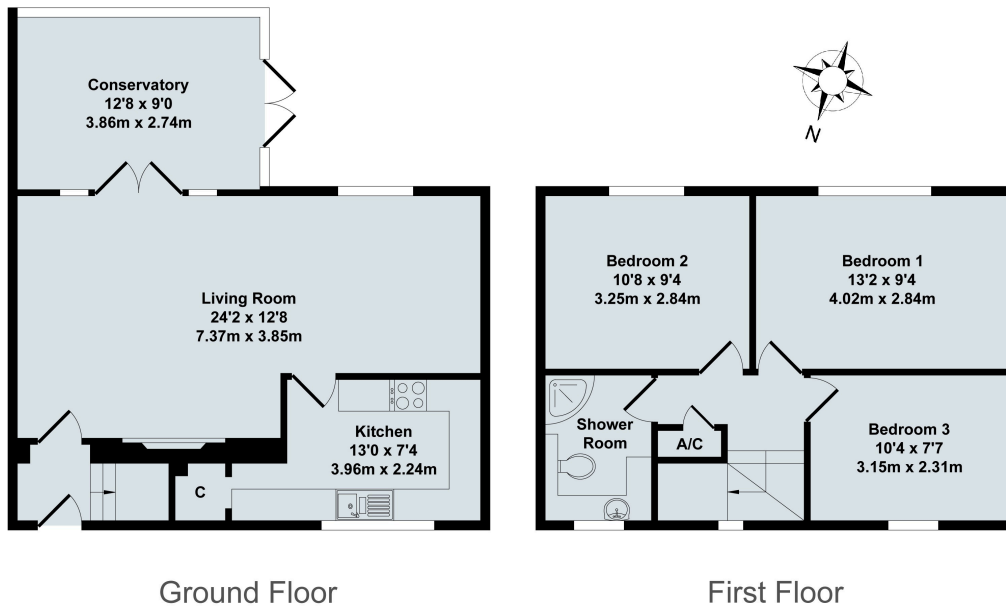

13 Hill Crescent, Finstock, Chipping Norton, OX7 3BT

Total Approx. Floor Area 936 Sq.Ft. (87.0 Sq.M.)

All items illustrated on this plan are included in the "Total Approx Floor Area"

Local Authority:

West Oxfordshire District Council Band C /
EPC Rating: 55/D

Contact:

52 Market Square, Witney,
Oxfordshire, OX28 6AF

Tenure:

Freehold

Tel: 01993 772000

Email: witney@thomasmerrifield.co.uk

Important Notice

Thomas Merrifield for themselves and their clients give notice that:-

1. They are not authorised to make or give representation or warranty in relation to this property, either on their own behalf or on behalf of the Seller. They assume no responsibility for any statement made in these particulars. These particulars do not form part of any offer or contract and must not be relied upon as statements or representations of fact.
2. Whilst every attempt has been made to ensure the accuracy of the floorplan contained here, measurements of doors, windows, rooms and any other items are approximate and no responsibility is taken for any error, omission, or mis-statement.
3. All areas, measurements or distances are approximate. The particulars are intended for guidance only and are not necessarily comprehensive. A wide angle lens may have been used in photography. Thomas Merrifield have not tested appliances or services and it should not be assumed that the property has all necessary planning, building regulation and other consents. Buyers must satisfy themselves with the property by inspection or otherwise.
4. Reference to any mechanical or electrical equipment does not constitute a representation that such equipment is capable of fulfilling its function and prospective Buyers must make their own enquiries.
5. They have no responsibility for any expenses or costs incurred by prospective Buyers in inspecting properties which have been sold, let or withdrawn. Applicants are advised to contact the Agent to check availability and any other information of particular importance to them, prior to inspecting the property, particularly if travelling some distance.