



Buchan Place, Oxfordshire, OX13 5GE

Guide Price £440,000 Freehold

THOMAS
MERRIFIELD
SALES LETTINGS



The Property

Constructed from classic red brick, the home boasts a range of appealing features and modern touches. The property benefits from side access, leading to a generously sized private garden that is both lawned and patioed. At the rear, you'll find a large outbuilding, currently used as a gym, offering versatile space.

On the ground floor, the property provides a well-equipped kitchen/breakfast room and a spacious lounge with patio doors opening into the garden, ideal for indoor-outdoor living. There is also a convenient downstairs WC.

Upstairs, the primary bedroom comes with an en suite, while two additional bedrooms—one double and one single—offer ample space. A family bathroom completes the upper floor, providing comfort and convenience for modern living. This well-maintained property is perfect for those looking for a contemporary home in a peaceful village setting.





Key Features

- Modern three-bedroom semi-detached home built in 2018
- Private rear garden with both lawn and patio areas
- Large outbuilding in the garden, currently used as a gym
- Spacious kitchen/breakfast room with modern fittings
- Bright and airy lounge with patio doors leading to the garden
- Primary bedroom with en suite bathroom
- Family bathroom and additional downstairs WC for convenience
- Stylish modern design with high-quality finishes throughout
- EPC Rating: B

The Location

Southmoor having merged with Kingston Bagpuize is a medium size village in a semi-rural environment approximately 8 miles to the west of Abingdon and features a thriving community which is well catered for with local shops village hall, pub, cafe, and primary school. Many revered private schools are within easy access. In addition there are a good number of clubs including a cricket tennis and football club. There is also a regular bus service and ease of access to Oxford (approx. 9 miles) Witney (9 miles) Faringdon Wantage and Swindon which are slightly further afield.



Thomas Merrifield and their clients give notice that:

Approximate Gross Internal Area 1279 sq ft - 118 sq m

Ground Floor Area 532 sq ft – 49 sq m

First Floor Area 431 sq ft – 40 sq m

Outbuilding Area 316 sq ft – 29 sq m

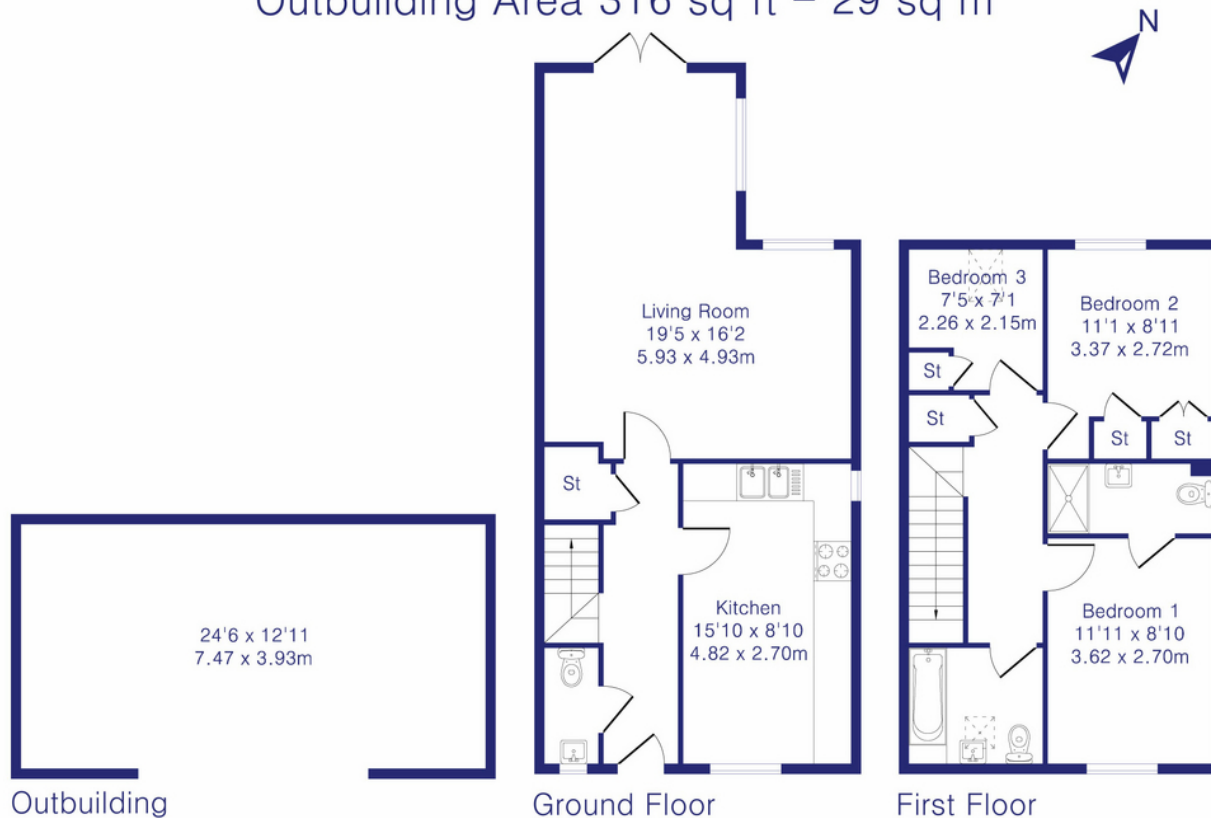

1. They are not authorised to make or give any representations or warranties in relation to the property either here or elsewhere, either on their own behalf or on behalf of their client or otherwise. They assume no responsibility for any statement that may be made in these particulars. These particulars do not form any part of any offer or contract and must not be relied upon as statements or representations of fact.

2. Any areas, measurements or distances are approximate. The text, photographs and plans are for guidance only and are not necessarily comprehensive. It should not be assumed that the property has all necessary planning, building regulation or other consents and Thomas Merrifield have not tested any services, equipment or facilities. Purchasers must satisfy themselves by inspection or otherwise.

Abingdon Office
51 Stert Street, Abingdon
Oxfordshire, OX14 3JF

T 01235 538000
E abingdon@thomasmerrifield.co.uk
W thomasmerrifield.co.uk



Although Pink Plan Ltd ensures the highest level of accuracy, measurements of doors, windows and rooms are approximate and no responsibility is taken for error, omission or misstatement. These plans are for representation purposes only as defined by RICS code of measuring practise. No guarantee is given on total square footage of the property within this plan. The figure icon is for initial guidance only and should not be relied on as a basis of valuation.

