



****AVAILABLE DECEMBER 2025****

****UNFURNISHED** **OFF STREET**

PARKING** Situated in the prestigious location of Jesmond Park West, this two bedroom apartment is found on the ground floor of the High Dene development. This smart property boasts a pleasant outlook, off street parking and is ideal for a professional couple or single occupant.

The property briefly comprises a communal entrance hallway with stairs to all floors. The apartment itself has two double bedrooms, both with fitted wardrobe space; a spacious lounge with dual aspect outlook; a modern fitted kitchen with appliances; there is also a family bathroom WC with storage cupboard. Externally there are well kept communal gardens, one allocated off street parking space as well as off street bays for residents parking.

Well presented and available on an unfurnished basis, this is a great apartment is ideal for either a couple or single occupant.

Available 15th December 2025 | £6950pcm |
Unfurnished | Ground Floor Apartment | 468 Sq
ft (43.5 m2) | Lounge | Modern Kitchen | Two
Bedrooms | Bathroom WC | Communal Gardens
| Great Location | Off Street Allocated Parking |
DG & GCH | Council Tax Band: C | EPC
Rating: C



GROUND FLOOR
468 sq.ft. (43.5 sq.m.) approx.

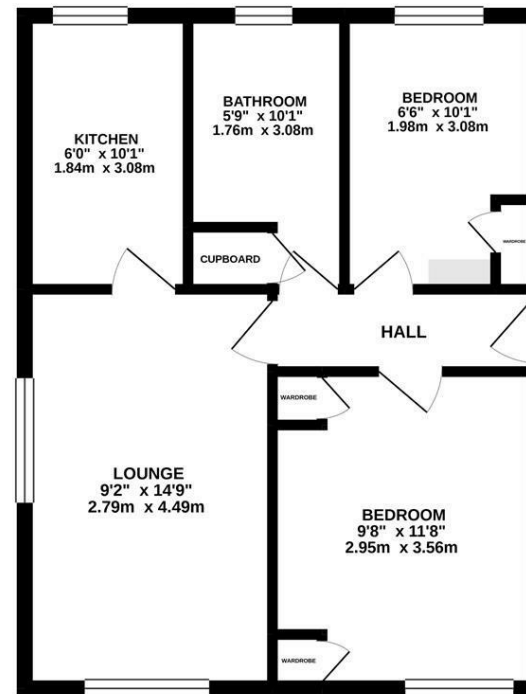

£950 PCM

IMPORTANT NOTE: These particulars and the descriptions and measurements herein do not constitute representation and whilst every effort has been made to ensure accuracy, this cannot be guaranteed.

TOTAL FLOOR AREA: 468 sq.ft. (43.5 sq.m.) approx.
Whilst every attempt has been made to ensure the accuracy of the floorplan contained herein, measurements of doors, windows, rooms and any other items are approximate and no responsibility is taken for any error, omission or mis-statement. This plan is for illustrative purposes only and should be used as such by any prospective purchaser. The services, systems and appliances shown have not been tested and no guarantee as to their operability or efficiency can be given.
Made with Metreplex ©2021

