





Extended Four Bedroom Semi-Detached with a West Facing Rear Garden and Off-Street Parking! This 1930's semi-detached family home is ideally located on Ridgewood Crescent, South Gosforth. Ridgewood Crescent, close to outstanding local schools, is conveniently situated close to South Gosforth Metro Station and the local shops and amenities of Station Road.

The internal accommodation briefly comprises: entrance porch through to entrance hall; sitting room with walk in bay, stripped wood flooring and wood burning stove; 18ft open plan living spaces with dual windows, storage cupboard, stripped wood flooring, French doors leading out to the west facing rear garden and open to; kitchen with fitted wall and base units with work surfaces and again with stripped wood flooring. The first floor, split level landing with storage gives access to four bedrooms, bedroom one with walk in bay and built in wardrobe storage; family bathroom with three piece suite and separate shower room, again with three piece suite. Externally, a block paved driveway to the front providing off-street parking. To the rear, a delightful west facing garden laid to lawn and gravel with a paved patio seating area, all enclosed with fenced boundaries. Fully double glazed and with gas central heating, an internal inspection is essential!

Semi-Detached Family Home | 1,159 Sq ft (107.7m2) | Four Bedrooms | Siting Room | 18ft Open Plan Living Space | Kitchen Area | Family Bathroom & Shower Room | Front Driveway | West Facing Rear Garden | GCH & DG | Great Location | Freehold | Council Tax Band D

EPC: C

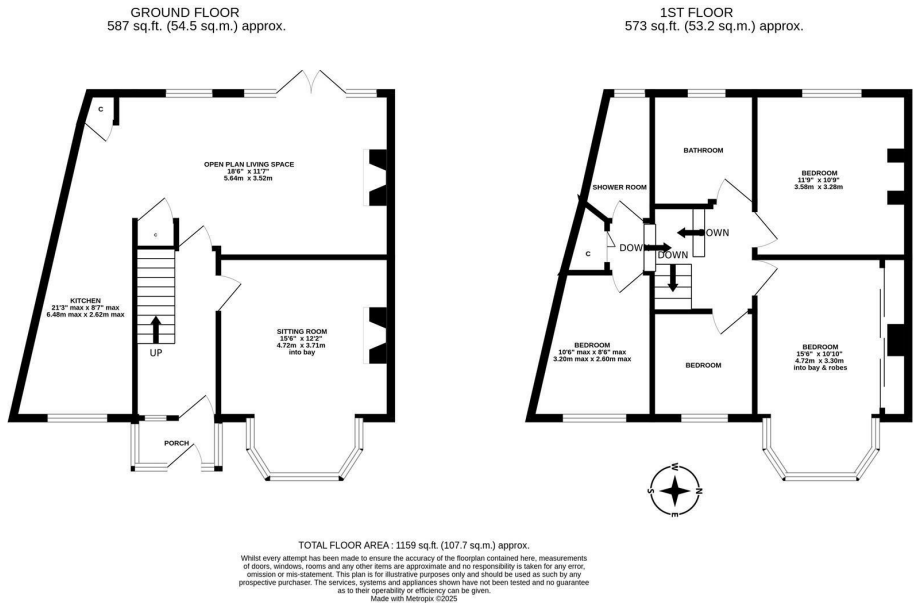

**Offers Over £335,000**

**IMPORTANT NOTE:** These particulars and the descriptions and measurements herein do not constitute representation and whilst every effort has been made to ensure accuracy, this cannot be guaranteed.

