

DETACHED HOUSE with REAR GARDENS, GARAGE and NO ONWARD CHAIN! This four bedroom detached family home is ideally located on the south-west backing side of Mill Rise, South Gosforth. Mill Rise, a popular cul-de-sac is within walking distance to South Gosforth metro station, Jesmond Dene and is within close proximity to excellent local schooling.

The accommodation briefly comprises: entrance hall with stairs to first floor; sitting room with walk in bay; dining room with sliding door access to the rear garden; study; downstairs WC; utility room; kitchen with fitted units, work surfaces and rear door access to the garden. The first floor landing gives access to; four bedrooms, bedroom one with an en-suite shower room; family bathroom complete with three piece suite.

Externally, a lawned front garden, a driveway providing off-street parking, leading on to the garage providing further off-street parking/storage. To the rear, a tiered garden with some planting, block paving and fenced boundaries. Offered to the market with no onward chain, early viewings are advised!

Detached Family Home | Four Bedrooms | 1,246 Sq ft (115.7m<sup>2</sup>) | Sitting Room | Dining Room | Study | Downstairs WC | Utility Room | Kitchen | Family Bathroom & En-Suite Shower Room | Front Garden & Driveway | Garage | Rear Garden | Quiet Cul-De-Sac Location | Freehold | No Onward Chain | Council Tax Band | EPC: C

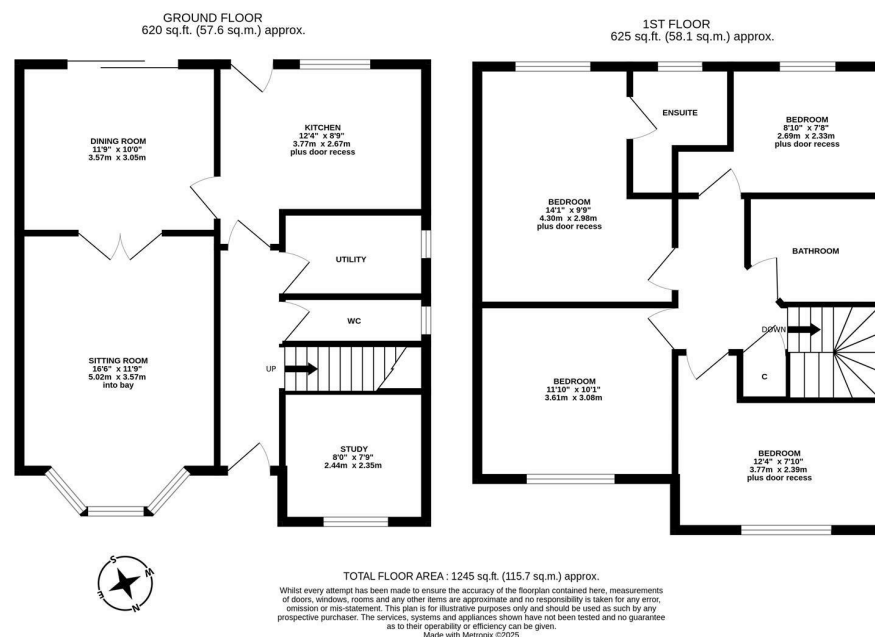

**Offers Over £325,000**

**IMPORTANT NOTE:** These particulars and the descriptions and measurements herein do not constitute representation and whilst every effort has been made to ensure accuracy, this cannot be guaranteed.

