



****AVAILABLE IMMEDIATELY** **ONE BEDROOM APARTMENT** **FURNISHED****
 Super stylish apartment close to Newcastle City Centre! A second floor conversion apartment ideally located at Victoria Square, Jesmond within a stone's throw from the universities, Newcastle's hospitals, the shops, restaurants and cafés of Jesmond and indeed Newcastle City Centre itself.



Originally constructed circa 1840, this proud, tree-lined, Grade II listed terrace is conveniently located and is a superb property not to be missed. Accessed via a well kept communal entrance and stairs to all floors, the accommodation itself briefly comprises; entrance hall leading to; lounge with feature fireplace and with a pleasant outlook; stylish kitchen/diner with appliances, wood flooring and tiled splash-backs; modern bathroom WC with three piece suite; 16ft double bedroom. Well presented throughout and available on a fully furnished basis.

Available 12th July 2025 | 2nd Floor Conversion Apartment | £925pcm | 543 Sq Ft (50.4m2) | Grade II Listed Terrace | One Double Bedroom | Kitchen/Diner | Stylish Bathroom WC | Furnished | Great Location | Permit Parking | Council Tax Band: B | EPC Rating: C

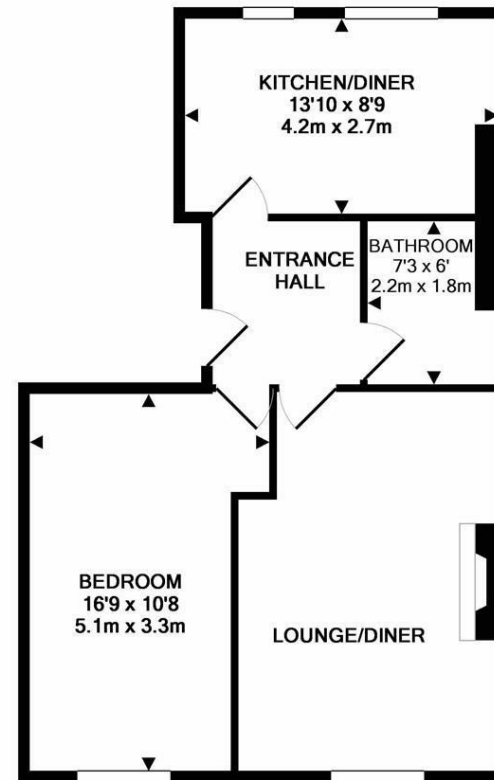

TOTAL APPROX. FLOOR AREA 543 SQ.FT. (50.4 SQ.M.)

Whilst every attempt has been made to ensure the accuracy of the floor plan contained here, measurements of doors, windows, rooms and any other items are approximate and no responsibility is taken for any error, omission, or mis-statement. This plan is for illustrative purposes only and should be used as such by any prospective purchaser. The services, systems and appliances shown have not been tested and no guarantee as to their operability or efficiency can be given
 Made with Metropix ©2017

£925 PCM

IMPORTANT NOTE: These particulars and the descriptions and measurements herein do not constitute representation and whilst every effort has been made to ensure accuracy, this cannot be guaranteed.

