



****AVAILABLE FOR THREE MONTH SHORT TERM TENANCY ONLY**** ****THREE INDIVIDUALS**** ****FURNISHED**** A fully furnished three bedroom upper 'Tyneside' flat located in pretty Jesmond Vale on Wolseley Gardens. With Jesmond Dene on your doorstep and a choice of great shops, bars & restaurants within walking distance, this stylish property is not to be missed!

Situated on the first floor, the accommodation briefly comprises; entrance lobby with stairs to first floor landing, spacious lounge, modern fitted kitchen with appliances, three double bedrooms, a super modern, newly installed bathroom WC to the rear off shoot. Externally there is a shared yard to the rear and on street parking to the front. Fully furnished throughout and ideal for either student or professional sharers.

Available Immediately | First Floor Flat |
 £1,650pcm | Three Double Bedrooms | 728 Sq.
 Ft (67.6 m2) | Modern Kitchen | Brand New
 Bathroom WC | Fully Furnished | Great Location
 | Close to Jesmond Dene | GCH & DG | Shared
 Rear Yard | Student Property | On Street Parking
 | DG & GCH | Council Tax Band: B | EPC
 Rating: C



GROUND FLOOR:
43 sq ft. (4.0 sq m.) approx.

FIRST FLOOR:
684 sq ft. (63.0 sq m.) approx.

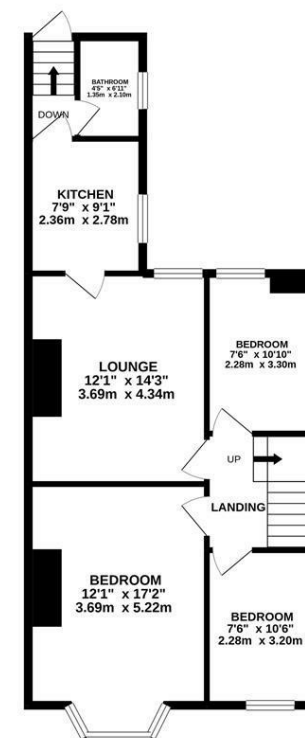

TOTAL FLOOR AREA : 728 sq.ft. (67.6 sq.m.) approx.

Whilst every attempt has been made to ensure the accuracy of the floorplan contained herein, measurements of doors, windows, rooms and any other items are approximate and no responsibility is taken for any error, omission or misstatement. This plan is for illustrative purposes only and should be used as such by any prospective purchaser. The services, systems and appliances shown have not been tested and no guarantee as to their operability or efficiency can be given.
 Made with Metrepx ©2021.



£1,650 PCM

IMPORTANT NOTE: These particulars and the descriptions and measurements herein do not constitute representation and whilst every effort has been made to ensure accuracy, this cannot be guaranteed.

