



****AVAILABLE JUNE 2025** **FURNISHED****

****RARE PROPERTY**** A wonderful mews house set over two storeys with private patio, open plan lounge/diner and garage storage located at Clayton Road, within Brandling Village Conservation Area, Jesmond. Clayton Road is perfectly placed within walking distance to some of Jesmond's finest shops, the café culture of Clayton Road, Exhibition Park and indeed Newcastle City Centre itself.

Well presented throughout this fine mews home briefly comprises entrance garage, lobby through to open plan lounge/diner with doors leading out to the private terrace, ground floor w/c and shower room, kitchen with dining area with integrated appliances, utility/laundry room to the ground floor. To the first floor a fabulous mezzanine floor, bedroom one with kingsize bed with double doors, bedroom two also a kingsize with double doors and family bathroom with skylight. Externally, a delightful paved patio area with planted shrubbery this fantastic home offers a great opportunity, not to be missed!

Available 14th June 2025 | £1,800pcm | Mews House | 1,054 Sq. ft (97.9m²) | Furnished | Open Plan Lounge/Diner | Two Double Bedrooms | Modern Fitted Kitchen | Utility Room | Brandling Village Conservation Area | Rare Property | GCH & DG | Council Tax Band: C | EPC: C

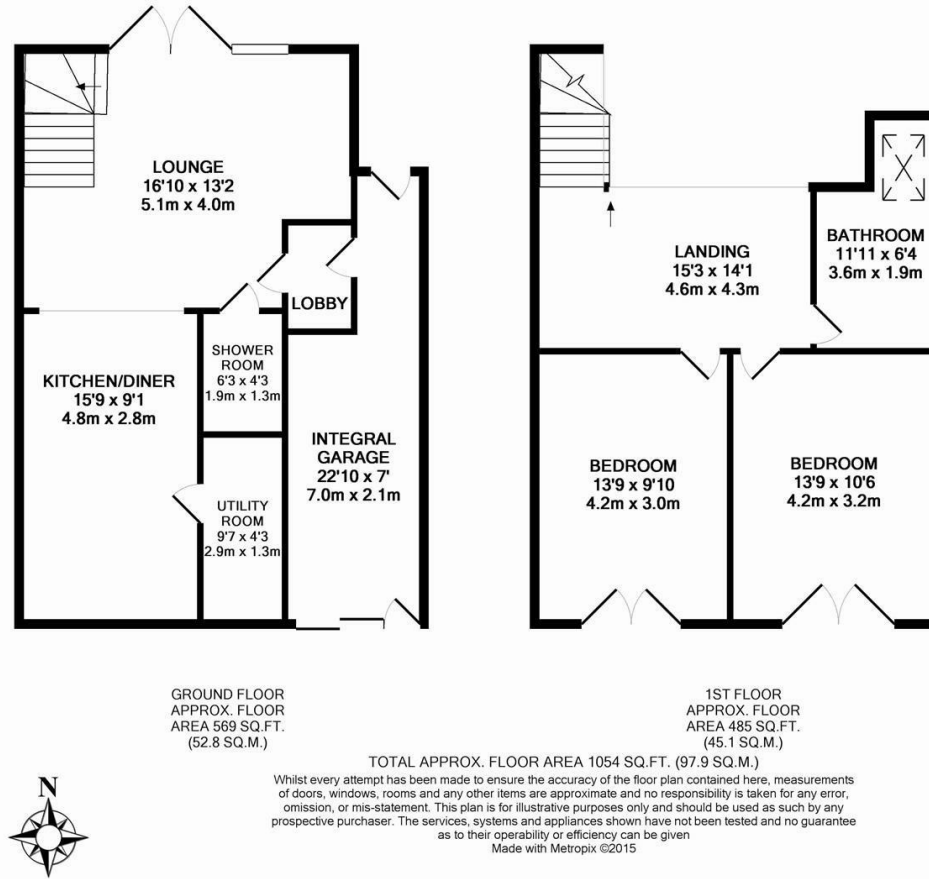

£1,800 PCM

IMPORTANT NOTE: These particulars and the descriptions and measurements herein do not constitute representation and whilst every effort has been made to ensure accuracy, this cannot be guaranteed.

