



****AVAILABLE IMMEDIATELY****

****GARAGE** **NEWLY REDECORATED THROUGHOUT** **UNFURNISHED****

****PEDESTRIANISED STREET**** A smart and stylish end of terrace house located on the Tudor Grange estate in ever popular Kingston Park. A great family home, accessed via a pedestrianised walkway, boasting spacious rooms, a rear garden and a separate garage!

Available on an unfurnished basis and with brand new carpets & flooring throughout the ground floor, the accommodation briefly comprises; entrance porch leading into a large lounge: double doors leading to a modern kitchen/diner to the rear of the ground floor. With a staircase from the lounge leading to first floor landing with two separate store cupboards; three bedrooms, the master of which with fitted wardrobe, the two at the front also with a pleasant tree lined outlook; family bathroom WC. Externally there is a private garden to the rear with shed for further storage. There is also a nearby garage available for use with this property.

With gas central heating and double glazing throughout, this family home is not to be missed!

Available Immediately | £950pcm | 718 Sq. ft (66.7 m2) | Unfurnished | Newly Redecorated Throughout | Brand New Carpets/ Flooring on Ground Floor | End Terrace House | Pedestrianised Street | Lounge | Three Bedrooms | Modern Kitchen/ Diner | Family Bathroom WC | Rear Garden | Separate Garage | Good Storage Space | Popular Location | DG & GCH | Council Tax Band: B | EPC Rating: C

£950 PCM

IMPORTANT NOTE: These particulars and the descriptions and measurements herein do not constitute representation and whilst every effort has been made to ensure accuracy, this cannot be guaranteed.

GROUND FLOOR
361 sq.ft. (33.5 sq.m.) approx.

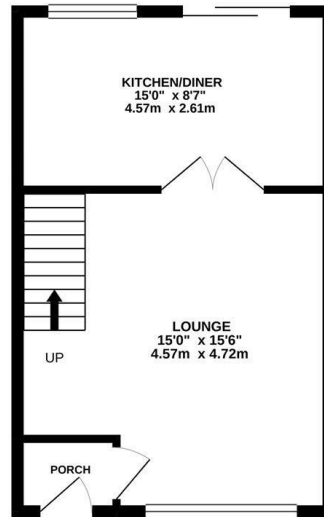

1ST FLOOR
357 sq.ft. (33.2 sq.m.) approx.

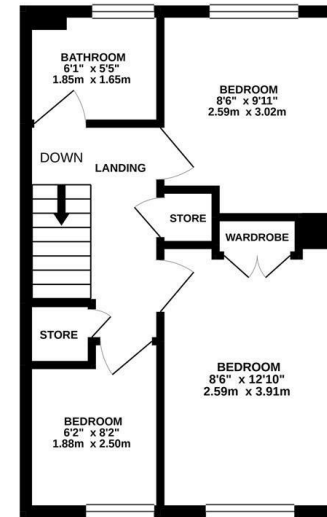

TOTAL FLOOR AREA : 718 sq.ft. (66.7 sq.m.) approx.
Whilst every attempt has been made to ensure the accuracy of the floorplan contained here, measurements of doors, windows, rooms and any other items are approximate and no responsibility is taken for any error, omission or mis-statement. This plan is for illustrative purposes only and should be used as such by any prospective purchaser. The services, systems and appliances shown have not been tested and no guarantee as to their operability or efficiency can be given.
Made with Measure (2023)

