





**\*\*AVAILABLE JUNE 2025\*\* \*\*FURNISHED\*\***

**\*\*GARAGE\*\*** An inviting and homely ground floor flat found on Chillingham Road in the heart of Heaton. In an ever popular location, fantastically situated closed to transport links and an abundance of local shops, bars and restaurants. Boasting private outside space with a detached garage, tastefully furnished throughout this superb property is not to be missed!

The accommodation briefly comprises an entrance porch through to hallway with store cupboard; spacious master bedroom to the front, measuring 15ft with bay window; bedroom to to the rear, another comfortable double; lounge central to the flat, with wood flooring, feature fireplace and fitted alcove storage; modern fitted kitchen with appliances and door leading to rear yard; shower room WC in the rear off-shoot with step in shower. Externally there is a private yard to the rear, fully decked with access to a 14ft detached garage providing off street parking. To the front there is also a small town garden.

Conveniently located, available on a furnished basis with gas central heating and double glazed windows throughout.

Available 10th June 2025 | £950pcm | 851 Sq. ft (79 m2) | Ground Floor Tyneside Flat | Furnished | Detached Garage | Two Double Bedrooms | Lounge | Modern Kitchen | Shower Room WC | Private Rear Yard with Decking | Close To Transport Links | Great Location | GCH & DG | Council Tax Band: A | EPC Rating: C

**£950 PCM**

**IMPORTANT NOTE:** These particulars and the descriptions and measurements herein do not constitute representation and whilst every effort has been made to ensure accuracy, this cannot be guaranteed.

GROUND FLOOR  
851 sq.ft. (79.0 sq.m.) approx.

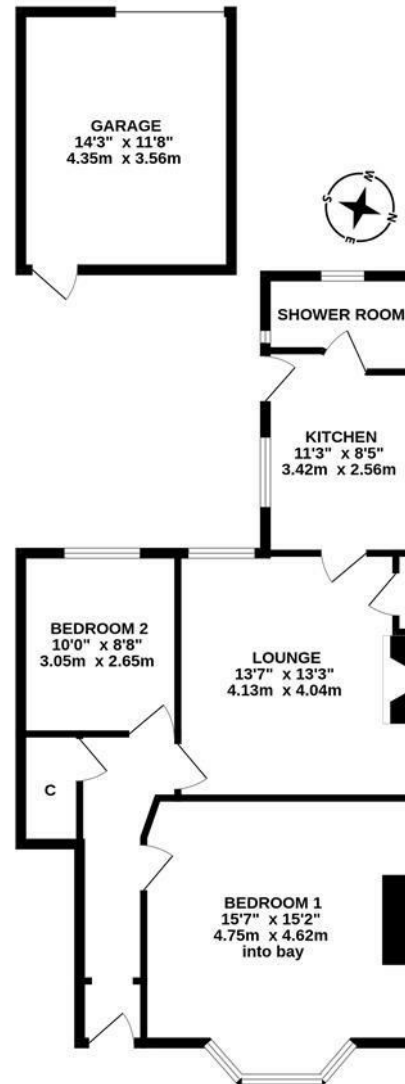

TOTAL FLOOR AREA : 851 sq.ft. (79.0 sq.m.) approx.

Whilst every attempt has been made to ensure the accuracy of the floorplan contained here, measurements of doors, windows, rooms and any other items are approximate and no responsibility is taken for any error, omission or mis-statement. This plan is for illustrative purposes only and should be used as such by any prospective purchaser. The services, systems and appliances shown have not been tested and no guarantee as to their operability or efficiency can be given.  
Made with Matterport 3D/360

