





**\*\*AVAILABLE IMMEDIATELY\*\***

**\*\*FURNISHED\*\* \*\*NEWLY REDECORATED THROUGHOUT\*\* \*\*GROUND FLOOR CONVERSION APARTMENT\*\*** A fantastic ground floor conversion apartment located in Central Jesmond. Very tastefully furnished, with two double bedrooms, modern kitchen & shower room as well as some outside space.

The property briefly comprises a communal entrance hall providing access to the apartment on the ground floor. There is a beautiful lounge to the front, with a bay window and plenty of natural light. There are two equal size double bedrooms, one with fitted wardrobe space. There is a fabulous fitted kitchen with breakfasting bar and appliances including a five burner gas hob & electric oven, large fridge freezer and a washing machine. To the rear of the apartment you will a slick shower room WC and also access to the rear yard. Externally there is a yard to the rear as well as outside space to the front. There is space to park communally at the rear as well as further on street permit parking to the front.

Available Immediately | £1,450pcm | Ground Floor Conversion Apartment | Newly Redecorated Throughout | 780 Sq. ft (72.4m<sup>2</sup>) | Two Double Bedrooms | Shower Room WC | Modern Breakfasting Kitchen | Lounge | Communal Off Street Parking | Permit Parking To The Front | Furnished | GCH | Council Tax Band: C | EPC Rating: D

**£1,450 PCM**

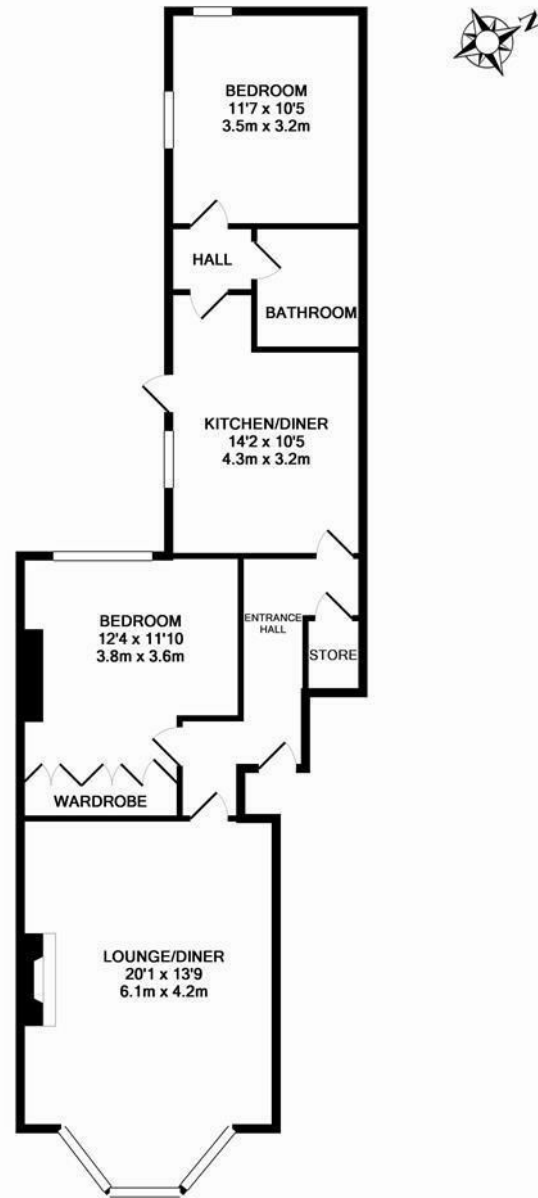

TOTAL APPROX. FLOOR AREA 780 SQ.FT. (72.4 SQ.M.)

Whilst every attempt has been made to ensure the accuracy of the floor plan contained here, measurements of doors, windows, rooms and any other items are approximate and no responsibility is taken for any error, omission, or mis-statement. This plan is for illustrative purposes only and should be used as such by any prospective purchaser. The services, systems and appliances shown have not been tested and no guarantee as to their operability or efficiency can be given.  
Made with Metropix ©2015



**IMPORTANT NOTE:** These particulars and the descriptions and measurements herein do not constitute representation and whilst every effort has been made to ensure accuracy, this cannot be guaranteed.

