



**\*\*AVAILABLE APRIL 2025\*\* \*\*FURNISHED\*\***

An immaculate example of a lower two bedroom Tyneside flat! Well presented throughout including a modern fitted kitchen and plush shower room WC. With stylish wood flooring and tastefully furnished, this is a great property found in ever popular Jesmond Vale and is not to be missed!

The property briefly comprises; an entrance hallway with storage cupboard, two double bedrooms, the master of which to the front with a bay window and beautiful feature fireplace. There is a lounge, modern kitchen and shower room WC to the rear off shoot. Externally the property benefits from a private rear yard, with a garage door providing off street parking, as well as on street parking to the front. Fully furnished, with gas central heating and double glazed windows throughout.

Available 19th April 2025 | £1,295pcm | Ground Floor Tyneside Flat | 603 Sq. ft (56.1 m2) | Two Double Bedrooms | Lounge | Modern Kitchen | Stylish Shower Room WC | Furnished | On Street Parking | Private Rear Yard | DG & GCH | Council Tax Band: A | EPC Rating: D

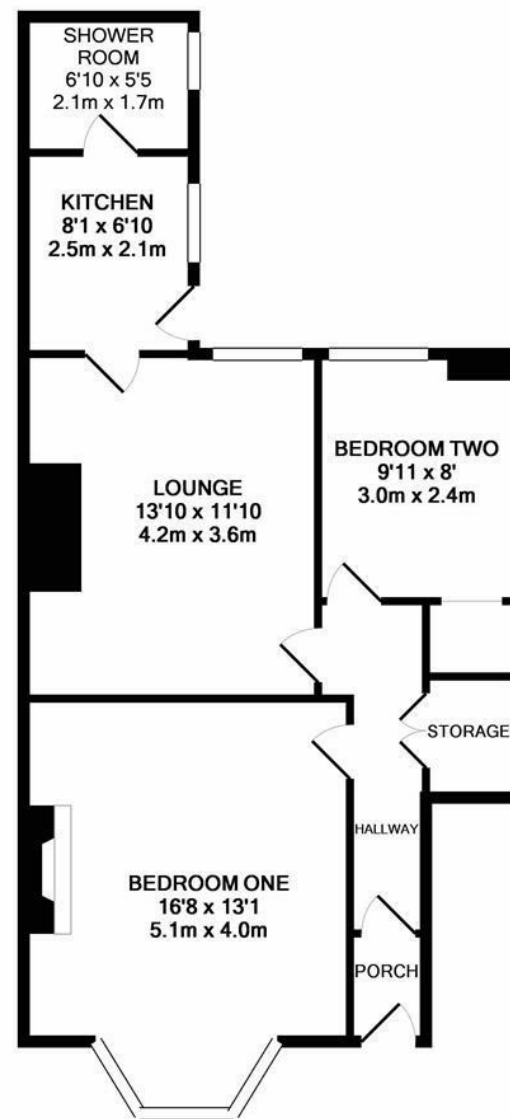

TOTAL APPROX. FLOOR AREA 603 SQ.FT. (56.1 SQ.M.)

Whilst every attempt has been made to ensure the accuracy of the floor plan contained here, measurements of doors, windows, rooms and any other items are approximate and no responsibility is taken for any error, omission, or mis-statement. This plan is for illustrative purposes only and should be used as such by any prospective purchaser. The services, systems and appliances shown have not been tested and no guarantee as to their operability or efficiency can be given  
Made with Metropix ©2017

**£1,295 PCM**

**IMPORTANT NOTE:** These particulars and the descriptions and measurements herein do not constitute representation and whilst every effort has been made to ensure accuracy, this cannot be guaranteed.

