



This well presented, three bedroom mid-terrace is ideally located on Acton Place, High Heaton. Positioned just off Craster Terrace, Acton Place t is perfectly placed close to local schooling, the Freeman Hospital, Paddy Freemans Park and the nearby Sainsbury's Super Store.

The accommodation briefly comprises: entrance hall with stairs to first floor; lounge; kitchen diner with a range of fitted units, work surfaces, two storage cupboards and rear door access to the garden. The first floor landing gives access to; three bedrooms, bedrooms one and two both doubles; bathroom complete with three piece suite and spot lighting.

Externally, a front driveway providing off-street parking and an enclosed rear garden laid to lawn with fenced boundaries and separate, covered garden seating area with raised decking.

Three Bedroom Mid-Terrace | 713 Sq ft (66.2m2)
| Lounge | Kitchen Diner | Bathroom | Front Driveway | Enclosed Rear Garden with Covered Seating Area | GCH | DG | Freehold | Council Tax Band A | EPC: C



GROUND FLOOR
360 sq.ft. (33.4 sq.m.) approx.

1ST FLOOR
353 sq.ft. (32.8 sq.m.) approx.

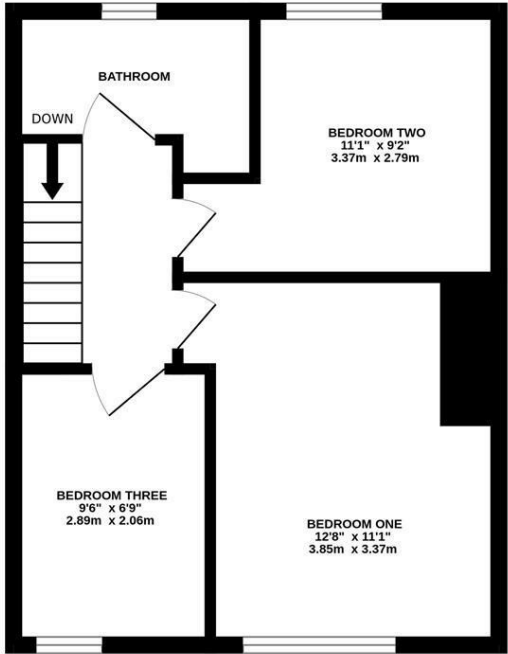
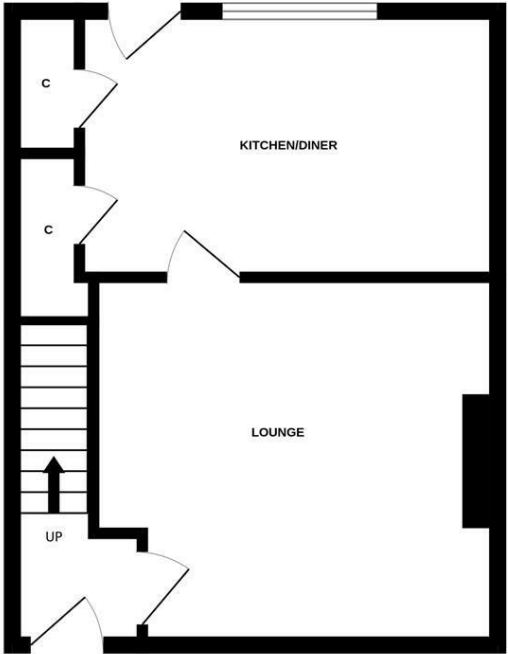

TOTAL FLOOR AREA : 713 sq.ft. (66.2 sq.m.) approx.

Whilst every attempt has been made to ensure the accuracy of the floorplan contained here, measurements of doors, windows, rooms and any other items are approximate and no responsibility is taken for any error, omission or mis-statement. This plan is for illustrative purposes only and should be used as such by any prospective purchaser. The services, systems and appliances shown have not been tested and no guarantee as to their operability or efficiency can be given.
Made with Metropix ©2025



Offers Over £175,000

IMPORTANT NOTE: These particulars and the descriptions and measurements herein do not constitute representation and whilst every effort has been made to ensure accuracy, this cannot be guaranteed.

