





This 1930's semi-detached family home is ideally located on Towers Avenue, Jesmond. Towers Avenue, a tree-lined no through road, is situated close to excellent local schooling and is within walking distance of the shops and cafés of Acorn Road as well as local transport links provided by both Ilford Road and West Jesmond Metro Stations a few minutes walk away.

Well presented throughout and boasting close to 1,900 Sq ft over two floors, the accommodation briefly comprises: entrance lobby through to entrance hall with stairs to first floor and separate downstairs WC; sitting room with walk in bay and feature fireplace; family room with feature modern fire and rear door access to the garden; kitchen diner measuring 16ft with spot lighting and dual French doors leading to the conservatory, kitchen area with a range of fitted units, granite work surfaces, some integrated appliances and pantry storage cupboard; utility room with fitted wardrobe storage cupboards; integral garage with front door access to the driveway; conservatory with French doors leading out to the rear garden. The first floor landing with dual windows gives access to; four bedrooms, bedrooms one, two and three all with walk in bay windows and bedroom one with fitted alcove storage cupboards; family bathroom complete with four piece suite including walk in shower, spot lighting and dual windows.

Externally, a gated front driveway providing off-street parking and leading to the garage. To the rear, a delightful and enclosed garden laid to both artificial grass and decking with seating areas and fenced boundaries. Early viewings are essential to appreciate this great family home, set within the heart of Jesmond.

1930's Semi-Detached Family Home | 1,888 Sq ft  
(175.4m2) | Four Bedrooms | Sitting Room | Family  
Room | 16ft Kitchen Diner | Utility Room |  
Conservatory | Downstairs WC | Family Bathroom with  
Four Piece Suite | Front Driveway & Garage | Delightful  
Enclosed Rear Garden | GCH & DG | Well Presented |  
Freehold | Council Tax Band F | EPC: D

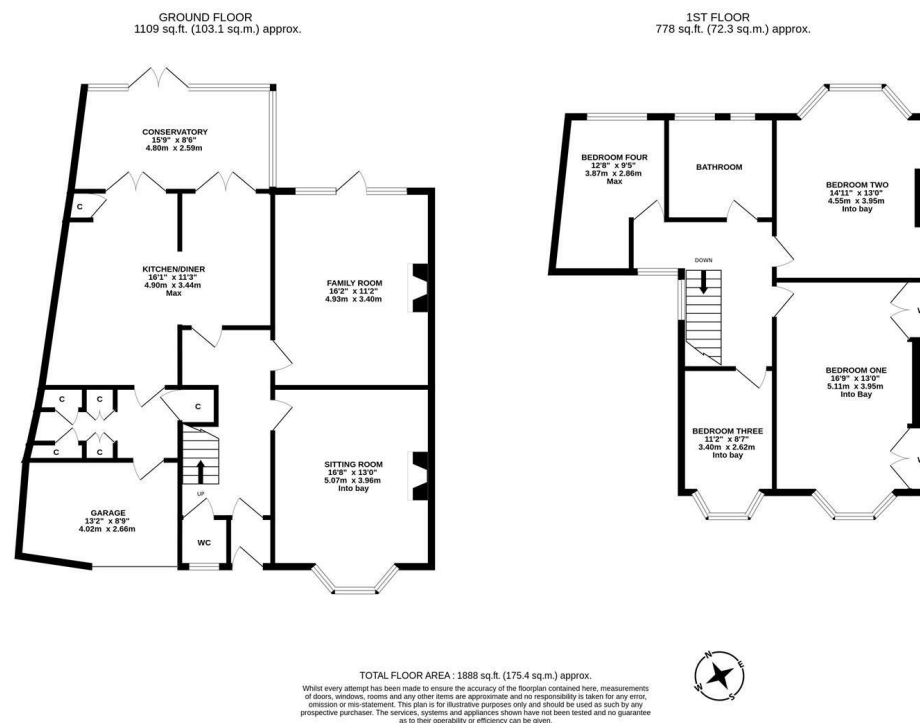

### Offers Over £700,000

**IMPORTANT NOTE:** These particulars and the descriptions and measurements herein do not constitute representation and whilst every effort has been made to ensure accuracy, this cannot be guaranteed.

