



WELL PRESENTED, TWO BEDROOM APARTMENT with ALLOCATED UNDERGROUND PARKING, LIFT ACCESS, OPEN ASPECT VIEWS & SOUTH FACING BALCONY! For the discerning buyer, this is an excellent opportunity to acquire a two-bedroom apartment located on the ground floor of Fernwood, Jesmond. Positioned between both Fernwood Road and Clayton Road, Fernwood is a purpose built block constructed in 1984 and is well placed to access the local shops, cafes and restaurants. Jesmond Metro Station is also only a short walk away, providing excellent access throughout the region.

Well Presented Ground Floor Apartment | 900 Sq ft (83.6m²) | Two Bedrooms | Lounge Diner | South Facing Balcony | Kitchen | Bathroom & En-Suite | Allocated Underground Parking | Great Location | Leasehold with 958 Years Remaining | Service Charge £2,933.66 Per Annum | Council Tax Band E | EPC: D



GROUND FLOOR
900 sq.ft. (83.6 sq.m.) approx.

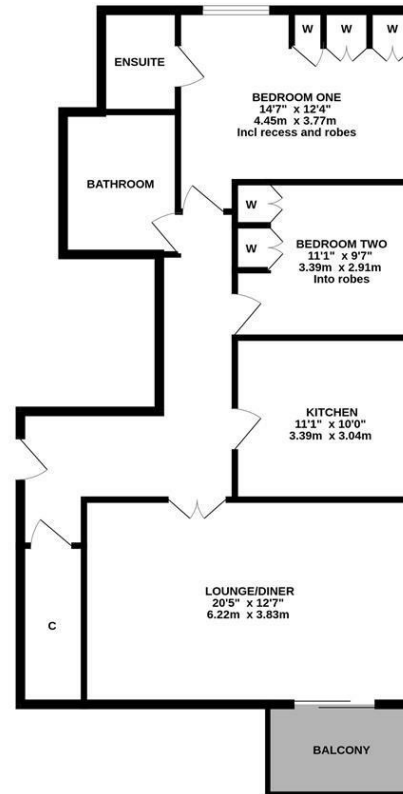

TOTAL FLOOR AREA: 900 sq.ft. (83.6 sq.m.) approx.

Whilst every attempt has been made to ensure the accuracy of the floorplan contained here, measurements of doors, windows, rooms and any other items are approximate and no responsibility is taken for any error, omission or mis-statement. This plan is for illustrative purposes only and should be used as such by any prospective purchaser. The services, systems and appliances shown have not been tested and no guarantee as to their operability or efficiency can be given.
Made with Metreapp ©2024



Offers Over £325,000

IMPORTANT NOTE: These particulars and the descriptions and measurements herein do not constitute representation and whilst every effort has been made to ensure accuracy, this cannot be guaranteed.

