



****AVAILABLE IMMEDIATELY** ****

£140pppw **RECENTLY REFURBISHED** **FURNISHED**** An exceptional upper Tyneside flat which has been recently refurbished - including fantastic kitchen and shower room refits, stylish furniture and boasting private outside space. The property is also superbly located on Fern Avenue in central Jesmond, just off Manor House Road, within walking distance to all of Jesmond's finest shops, bars & restaurants.

Licensed to be rented to three individuals, the accommodation briefly comprises an entrance hall with stairs to the first floor and a very spacious landing. There are three double bedrooms, the master of which is enormous with a beautiful feature fireplace. There is a lounge central to the property, open plan to a superb modern fitted kitchen with appliances. To the rear off shoot, a recently refitted plush shower room WC. Externally there is a private yard to the rear, decked with outside lighting and storage area. To the front there is ample on street permit parking available.

Fully furnished and available to either student, post-graduate or professional sharers, this excellent property is not to be missed!

Available Immediately | £140pppw/
£1,820pcm | First Floor Tyneside Flat |
Recently Refurbished | 849 Sq. ft (78.8 m2)



| Furnished | Three Double Bedrooms |
Modern Fitted Kitchen | Open Plan Lounge
| Plush Shower Room WC | Great Central
Jesmond Location | Private Decked Rear
Yard | Permit Parking | GCH & DG |
Council Tax Band: B | EPC Rating: D

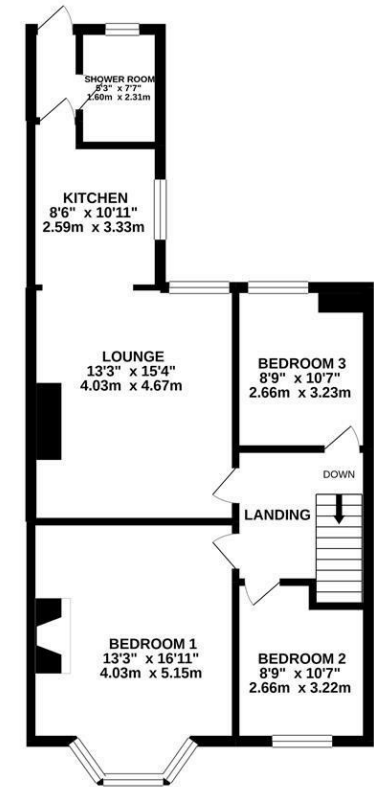

£1,820 PCM

Misrepresentation Act 1967. These particulars and the descriptions and measurements herein do not constitute representation and whilst every effort has been made to ensure accuracy, this cannot be guaranteed.

TOTAL FLOOR AREA: 849 sq.ft. (78.8 sq.m) approx.
Whilst every attempt has been made to ensure the accuracy of the floorplan contained here, measurements of doors, windows, rooms and any other items are approximate and no responsibility is taken for any error, omission or mis-statement. This plan is for illustrative purposes only and should be used as such by any prospective purchaser. The services, systems and appliances shown have not been tested and no guarantee as to their operability or efficiency can be given.
Made with Metropac ©2020

