



****AVAILABLE JULY 2024****
****FURNISHED** **RARE PROPERTY****

A wonderful mews house set over two storeys with private patio, open plan lounge/diner and garage storage located at Clayton Road, within Brandling Village Conservation Area, Jesmond. Clayton Road is perfectly placed within walking distance to some of Jesmond's finest shops, the café culture of Clayton Road, Exhibition Park and indeed Newcastle City Centre itself.

Well presented throughout this fine mews home briefly comprises entrance garage, lobby through to open plan lounge/diner with doors leading out to the private terrace, ground floor w/c and shower room, kitchen with dining area with integrated appliances, utility/laundry room to the ground floor. To the first floor a fabulous mezzanine floor, bedroom one with kingsize bed with double doors, bedroom two also a kingsize with double doors and family bathroom with skylight. Externally, a delightful paved patio area with planted shrubbery this fantastic home offers a great opportunity, not to be missed!

Available 17th July 2024 | £1,700pcm |
 Mews House | 1,054 Sq. ft (97.9m²) |
 Furnished | Open Plan Lounge/Diner |
 Two Double Bedrooms | Modern Fitted
 Kitchen | Utility Room | Brandling Village
 Conservation Area | Rare Property | GCH
 & DG | Council Tax Band: C | EPC: C

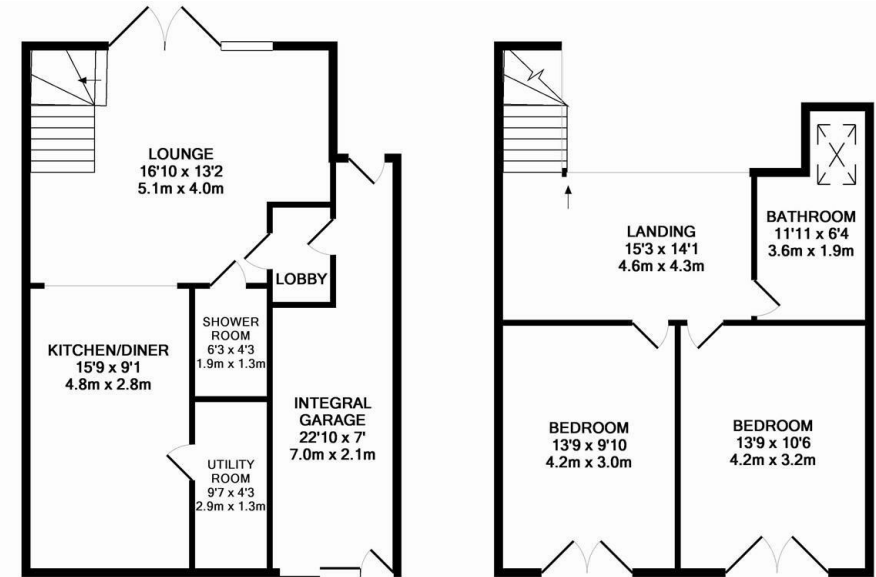

GROUND FLOOR
 APPROX. FLOOR
 AREA 569 SQ.FT.
 (52.8 SQ.M.)

1ST FLOOR
 APPROX. FLOOR
 AREA 485 SQ.FT.
 (45.1 SQ.M.)

TOTAL APPROX. FLOOR AREA 1054 SQ.FT. (97.9 SQ.M.)

Whilst every attempt has been made to ensure the accuracy of the floor plan contained here, measurements of doors, windows, rooms and any other items are approximate and no responsibility is taken for any error, omission, or mis-statement. This plan is for illustrative purposes only and should be used as such by any prospective purchaser. The services, systems and appliances shown have not been tested and no guarantee as to their operability or efficiency can be given
 Made with Metropix ©2015



£1,700 PCM

Misrepresentation Act 1967. These particulars and the descriptions and measurements herein do not constitute representation and whilst every effort has been made to ensure accuracy, this cannot be guaranteed.

